

W SWING YUME

Model number AY-YMW*

Operating Instructions

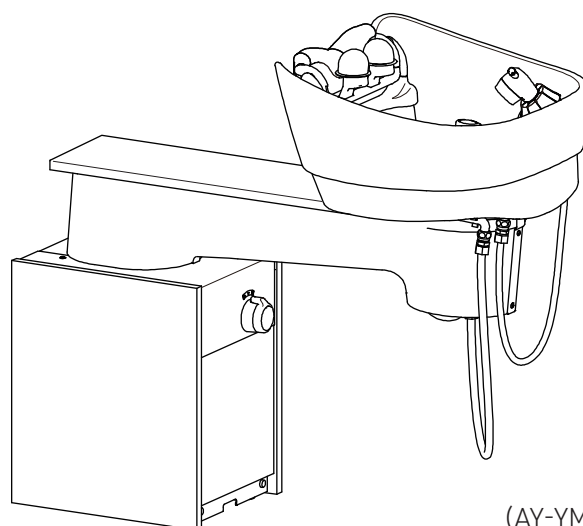

(AY-YMWNH is shown in the figure)

Thank you for purchasing this Takara Belmont product.

Please read the Operating Instructions carefully before use and use the product correctly.

Failing to read the Operating Instructions before use may lead to accidents.

- Keep this booklet safe near the product so that it can be referred to promptly and be sure to read this booklet again when necessary.
- This product is an industrial appliance designed for use by hair and beauty salons. Only use this product for its intended purpose.
- The product must only be used by those who have undergone appropriate training, such as hairstylists and beauticians.
- Installation and assembly should be consigned to Takara Belmont or the vendor designated by Takara Belmont.

If the Operating Instructions become illegible due to stains and tears, or if this booklet is misplaced, please request a copy from Takara Belmont using the inquiry number shown in the box below.

Table of Contents

Introduction

Description of Warning Symbols	3
Safety Precautions	4
Precautions for Use	7
Precautions for the Basin Product	9
Precautions for Resin Plated Parts	9
Position for Attaching the Warning Label	9
Before Using the Product	10
Accessories	10
Names of Parts	10

Preparation

Removal of the Shower Head Holder Cover	12
Attaching the Sponge	12
Attachment of the Shower Head Holder Cover	12
Attaching the Neck Cushion	13
Attaching the Head Pillow	14

Instructions for Use

Using the Shower head	14
Adjusting the Amount of Hot Water	15
Adjusting the Temperature of Hot Water	16
Filling the Basin with Hot Water	18
Fix the Neck Device (during intermediate rinsing during perm operation)	19
Return the Neck Device to the Normal State	19
Wash the Hair	20

Maintenance

Maintenance Method	26
--------------------------	----

Information for Use when Needed

Troubleshooting	34
Daily Inspection	35
Parts for Regular Replacement	37
Standard Period of Use	37
Consumable Goods	38
When Disposing of the Product	38
Specifications	39
Product Dimension Diagram	40

Description of Warning Symbols

■ Before using the product ...

Please be sure to read the Safety Precautions and Precautions for Use carefully and use the product correctly.



■ Precautions shown on this page

These are intended for the safe use of the product and to prevent harm and damage to users and other people.





All of the precautions shown are important details related to safety. Please be sure to follow these precautions.

If an accident occurs because of a failure to follow the Safety Precautions, Precautions for Use, Precautions for Basin Products, and Precautions for Resin Plated Parts, Takara Belmont will not be responsible for any damage or risk to the person using this product or those around them due to accidents. In this case, the person failing to adhere to the Safety Precautions and Precautions for Use will be responsible for any damage or risk incurred.

Detailed descriptions of symbols are provided below. Read and understand these symbols thoroughly before reading this manual.

Precaution classification	Magnitude of harm/damage and urgency
 WARNING	The items explained under this symbol are precautions that may result in death or serious injury from incorrect or improper handling of the product if the warning is not followed.
 CAUTION	The items explained under this symbol are precautions that may result in mild or moderate injury or property damage from incorrect or improper handling of the product if the caution is not followed.

Individual instructions that must be followed are explained under the following symbols:

Symbols for prohibited items	Symbols for mandatory items
 Display for general prohibitions  Display for prohibition of disassembly, repair, and modification  Display for the notification of precautions for high temperature	 Display for general mandatory action by the user

Safety Precautions (Please be sure to follow these precautions.)

WARNING

Installation and transfer



- **Precautions during installation**

- The product must be installed according to the work instructions.
- The product must be installed and assembled by specialist personnel (Takara Belmont or The vendor designated by Takara Belmont).
- The product must be installed on a flat, durable surface that is secure.
- The product must be installed in an area where it does not come in contact with surrounding objects.

When using or handling the product ...



- **Keep the user's and customer's hands, fingers, bodies, and pieces of clothing away from all moving parts of the product or areas around the moving parts**

This may cause injury from jamming.

- **Avoid wetting parts other than the basin**

- Care must be taken to avoid wetting parts of the product other than the basin. If parts other than basin come in contact with water, this must be wiped off immediately. Water entering the device may cause a malfunction.
- Care must be taken to avoid spilling water on the floor. If water is spilled on the floor, this must be wiped up immediately. Water on the floor may damage the floor or cause water leakage accidents.

- **Do not lean, ride, or hang onto the product**

Do not lean, ride, hang, or pull on the product, or apply excessive force on the product. This may result in damage. Also, the sudden movement of the product may lead to injury from falling over or falling off.



- **Be careful of customers and children**

- Care must be taken during use of this product to monitor the customer at all times. Sudden contact of the customer (especially children) with the product may lead to malfunctions and accidents.
- Keep children away from the product when treatment is not being provided.

- **Return the thermostatic control knob to the appropriate temperature after using hot water**

- Be sure to return the thermostatic control knob to the appropriate temperature after using hot water. Continued use without returning the knob may result in burns.
- Simultaneous use of the product with other devices that share the same source of cold or hot water may cause the temperature to become unstable. If multiple devices are being used, adjust the temperature by turning the thermostatic control knob slowly.

- **Adjust the temperature of the hot water by checking the temperature with the hands**

When adjusting the temperature of the hot water, reduce the amount of hot water and change the direction of the shower head away from the customer and adjust the temperature while checking the temperature with the hands. Care must be provided in this operation as it may lead to boiling water being output.

- **Support the head of the customer with your hand when lowering or raising the backrest**

When lowering or raising the backrest, be sure to support the head of the customer with your hand and call out to the customer. Failing to do so may result in the basin coming in contact with the head.

Safety Precautions (Please be sure to follow these precautions.)

WARNING

When using or handling the product ...



- **Be sure to perform daily inspection**

The use of the product without performing daily inspections may lead to injury and product damage. Please refer to [pages 35 to 37] for information on daily inspections.



- **Avoid disassembling, repairing, and modifying the product**

- Persons other than Takara Belmont after-purchase service personnel must not disassemble nor repair the product. This may result in accidents, malfunctions, electrocution, and fire.
- Modification of the product is dangerous and must be avoided under all circumstances.



- **Avoid using hot water above 60°C**

Use of hot water above 60°C may result in deformation and damage to the basin, shower head, and tap.



- **Take utmost care when operating the chair**

Utmost care must be taken when lowering the backrest of a chair with auto-setting functions to avoid catching the body and other objects between the chair and basin.

CAUTION

When using or handling the product ...



- **Avoid using the product with a damaged cover**

In case of damage to the cover, have the cover replaced immediately. Continued use without replacing these parts may result in failure or an accident.

- **Do not use the product with the maintenance cover open**

Contact with the high temperature part of the pipes may cause burns.

- **Avoid drinking the hot or cold water**

This product is designed for use for washing the hair. Do not drink the water. Diarrhea, abdominal pain, and other problems may occur depending on the water quality.

- **Do not use the product with the plating peeled off**

If the plating of the metal faucet parts (tap and thermostatic control knob) peels off, contact your local Takara Belmont dealer immediately and have these replaced. Continued use without replacing these parts may result in injury.

- **Do not apply shock to the product**

Damage to the cover, a malfunction, or breakage may lead to injury.

- **Avoid output of water in large amounts with the shower head resting on the shower head holder**

Water released may spill out of the basin or come into contact with the customer.

When outputting the water with the shower head resting on the shower head holder, check the surroundings and turn the tap slowly.

Safety Precautions (Please be sure to follow these precautions.)

CAUTION

When using or handling the product ...



- **Do not use the product in locations where freezing is expected**

This may cause damage and water leakage accidents.

Repair of damage caused by freezing will incur a charge even during the warranty period. If there is risk of freezing, use heating to keep the room temperature from dropping below 0°C.

- **Avoid the use of polishing agents**

Do not use polishing agents when cleaning the shower head, shower head holder, and covers.

The use of polishing agents, sponges containing polishing agents, or hard cleaning equipment, such as wire wool and nylon scrub sponges, may cause scratching.

- **Do not use the product outdoors**

This product is for indoor use only. Do not install the product outdoors or in vehicles. Make sure that the product is used in hair and beauty salons. Failure to do so may result in a malfunction or damage.

- **Keep away from direct sunlight and stove heat**

Keep the product away from direct sunlight and stove heat. This may result in discoloration and deterioration.



- **Handle the shower hose carefully**

- When using the basin, check that the shower hose is not caught under the foot or stool. This may result in damage to the basin.

- Do not step over the shower hose when using the product. This may cause the shower to become caught between you and the basin and lead to injury.

- Do not use excessive force to pull on the shower hose.

This may cause damage to the shower hose and water leakage accidents.

- **Be sure to wipe the floor if it is wet**

If the floor is wet after washing, be sure to wipe the floor immediately. This may cause deterioration of the floor or a malfunction.

- **Check the position of the thermostatic control knob before outputting water**

Boiling water may be output and may cause burns.

Precautions for Use

- **Do not use for any purpose other than hair and beauty salon treatment**

This product is an industrial appliance for use in hair and beauty salons.

The product must only be used by those who have undergone appropriate training, such as hairstylists and aestheticians.

- **Avoid applying heat**

This may result in degeneration and discoloration.

- **Do not allow sharp objects to come in contact with the neck cushion**

Contact with sharp objects, such as scissors, may cause breakage of the outer surface.

- **Wipe off any chemicals that adhere to the product**

If the chemicals come in contact with the wooden parts and covers, this must be wiped off immediately.

This may result in degeneration and discoloration.

- **Do not use strong acids and strong alkalis for cleaning chemicals**

Avoid using cleaning chemicals containing caustic soda (NaOH) and caustic potash (KOH) to clean the drainage pipes.

Also, do not release thinners, alcohol, nail polish remover, gasoline, or kerosene into the drainage under any circumstances. This may result in damage to the drainage hose.

- **Be sure to wipe the water off the areas outside the basin after using the product**

Water left on the device may cause a malfunction and stains resistant to cleaning.

- **Care must be taken for interference with the chair (particularly with leg rest and step)**

Rotating the chair with the leg rest stretched out and elevating the chair with the leg rest facing towards the product may result in contact with the product, which may lead to injury and product damage.

Check that the product does not come in contact with the chair before rotating or elevating the chair.

- **Avoid moving the basin when filled with water or carrying heavy objects**

This may cause the water to spill out of the basin and stain the floor, furniture, or clothes. Also, wetting of the product may cause malfunction or damage.

- **Do not wash the hair in the front or side position**

Water released may spill out of the basin.

- **Make sure that the neck fastening pin is locked when using the product with the neck device fixed**

Using the product without locking the neck fastening pin may cause the neck device to become loose during treatment, which may cause the customer to be hit on the head and become injured.

- **Insert the shower head securely into the shower head holder**

If the shower head is not inserted sufficiently, it will not be held securely by the shower head holder. This may cause the direction of the shower head to change when water is released, resulting in water coming into contact with the customer.

- **Avoid wetting the shower head holder**

Do not wet the shower head holder with water. This may cause water leakage.

- **Return the shower head to the shower head holder so that the shower head plate is facing towards the basin**

Water released may spill out of the basin or come into contact with the customer.

Make sure that the shower head is returned to the shower head holder so that the shower head plate is facing towards the basin.

- **Do not apply excessive force when removing the cover of the shower head holder**

Force applied to the assembled part may cause damage to the parts.

Precautions for Use

- **Avoid touching the hot water pipe**

The hot water pipe is hot to touch. Avoid touching the pipe directly.

- **Set the temperature for supply of hot water to the device at 80°C or lower**

Failure to do so may result in a malfunction or damage to the tap, check valve, flexible connector, and thermostatic control knob.

- **Drain the water in cold regions**

If you are using the product in cold regions during the winter season, be sure to drain the water by opening the strainer of the check valve to prevent freezing. Failure to do so may cause water leakage accidents.

- **Be sure to use the neck cushion**

The neck cushion must be used because providing treatment without using the neck cushion may place an unnecessary burden on the neck and lead to injury.

- **Avoid the use of mint oil and aroma oils**

Do not use mint oils and aroma oils. This may damage the shower head, shower head holder, shower hose, tap, thermostatic control knob, neck cushion, drain cap, and other resin parts.

- **Avoid dropping and placing heavy or sharp objects on the basin**

This may cause damage, such as scratches and cracks.

- **Do not use the product to wash sharp objects, such as scissors**

This may scratch or damage the basin or neck cushion.

- **Avoid accidental contact of objects with the product**

Avoid accidental contact of hard objects with the product.

This may cause the product to become deformed or damaged.

- **Avoid accidental contact of objects with the resin handle**

Avoid accidental contact of hard objects with the resin tap and thermostatic control knob.

The plated surface may become scratched and cracked, causing the resin to peel off and result in injury.

- **Close the tap tightly**

Make sure to stop the water by turning the tap clockwise completely after use and after completion of the work. Water leakage accidents may occur if the water is not stopped completely.

- **Do not leave the shower head inside the water in the basin**

The water in the basin may regurgitate if the pressure inside the water pipe decreases because of the cutoff of the water supply for work.

- **Avoid spillage of water from the outlet of the shower hose when filling the basin with water**

When filling the basin with water, be sure to fill to the designated maximum level. [Page 18]

- **Do not block the drain outlet when the product is not in use**

Do not block the drain outlet with a drain cap, towel, or hairdressing gown after completion of the work.

The accidental release of water or the output of cold or hot water due to the nighttime increase in water pressure may cause the water to spill out of the basin and lead to water leakage accidents. When the product is not in use, be sure to remove the drain cap from the drain outlet and place it outside the basin.

- **Clean the hair catcher frequently**

The hair catchers should be cleaned as frequently as possible. Cleaning should be performed after washing each customer where possible because the use of the device without cleaning may cause the drain to become clogged with accumulated hair and result in water overflow and unhygienic conditions.

Precautions for the Basin Product

The basin in this product uses ceramics. Since distortion and deformation is unavoidable in the molding of ceramics, there are some variations in the position and height of the neck, as well as the shape and the weight of the product. Please be advised of these variations. Also, the nature of ceramics can cause sudden swelling in the part exposed to boiling water, which may result in cracking of the surface. Be sure to avoid pouring boiling water on ceramics because this may cause damage to the ceramics or lead to injury and water leakage.

Precautions for Resin Plated Parts

- **Resin plating is used on the tap and thermostatic control knob.**

- The resin plate is a thin, hard metal membrane and the surface may become cracked or peel off due to corrosion and deterioration over time.
- The plated surface may become scratched or cracked from impacts, such as from dropped objects.
- The plated surface may also become scratched or cracked from contact with hard objects.
- The plated surface may peel off from the scratches and cracks.

CAUTION

Check that there are no scratches, cracks, or peeling on the plated surface of the tap and thermostatic control knob. If the plating has peeled off, discontinue use immediately and contact your local Takara Belmont dealer. Continued use without replacing these parts may result in injury.

Example of peeling
of the plated surface

Example of scratches
on the plated surface

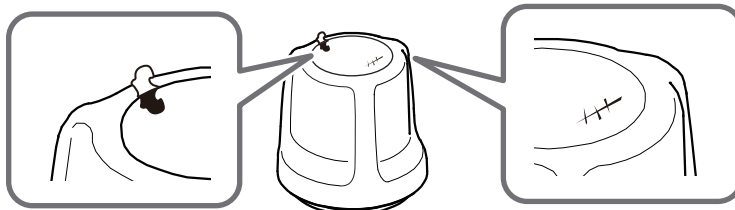

Position for Attaching the Warning Label

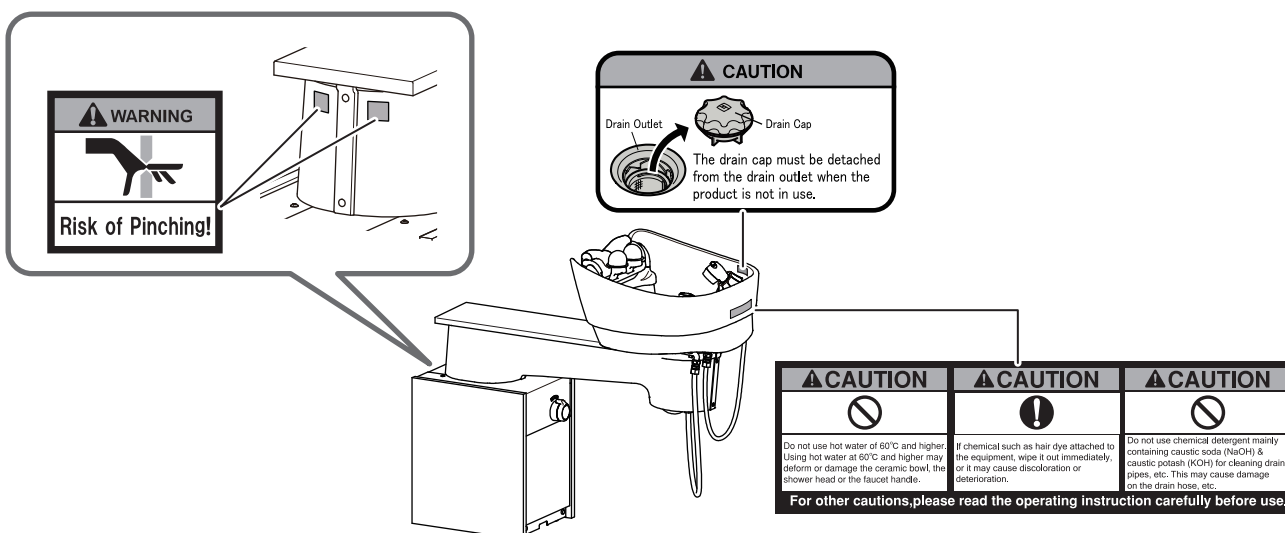

Before Using the Product

- This product is a hair washing device for use in washing the hair in the rear position^{*1} and head spa.
- The back approach^{*2} is used when this product is intended for use with the user in the standing or sitting position.
- This product cannot be used for washing the hair in the side^{*3} or front position.^{*4}
- Check that the accessories are installed correctly on the product.
- The spaces between the covers and between the basin and cover vary somewhat depending on the product. Please be advised of these variations.
- The space between the basin and cover is larger than the space between covers. This is due to the use of ceramics in the basin and does not represent problems in quality.

*1: Rear position: This refers to the user standing at the back of the basin to wash the hair.

*2: Back approach: This refers to the user standing at the back of the basin for treatment, such as head spa.

*3: Side position: This refers to the user standing at the side of the basin to wash the hair.

*4: Front position: This refers to washing the hair with the customer leaning forward and facing down.

Accessories

- ☐ Replacement mohair tape
(consumable goods): 1
(With the operating instructions
for mohair tape)



- ☐ Hair catcher
(consumable goods): 1



- ☐ Drain cap
(consumable goods): 1

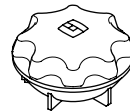

- ☐ Replacement sponge
(consumable goods): 1



- ☐ Neck cushion
(consumable goods): 1

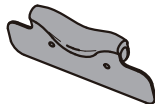

- ☐ Head pillow
(consumable goods): 1

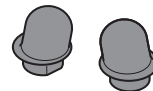

- ☐ Installation Instructions: 1

- ☐ Operating Instructions (this document): 1

Names of Parts

Main unit

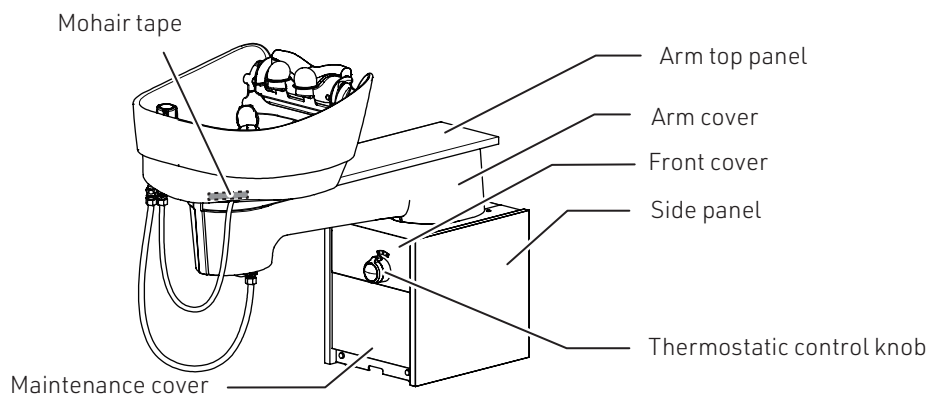

Names of Parts

Basin

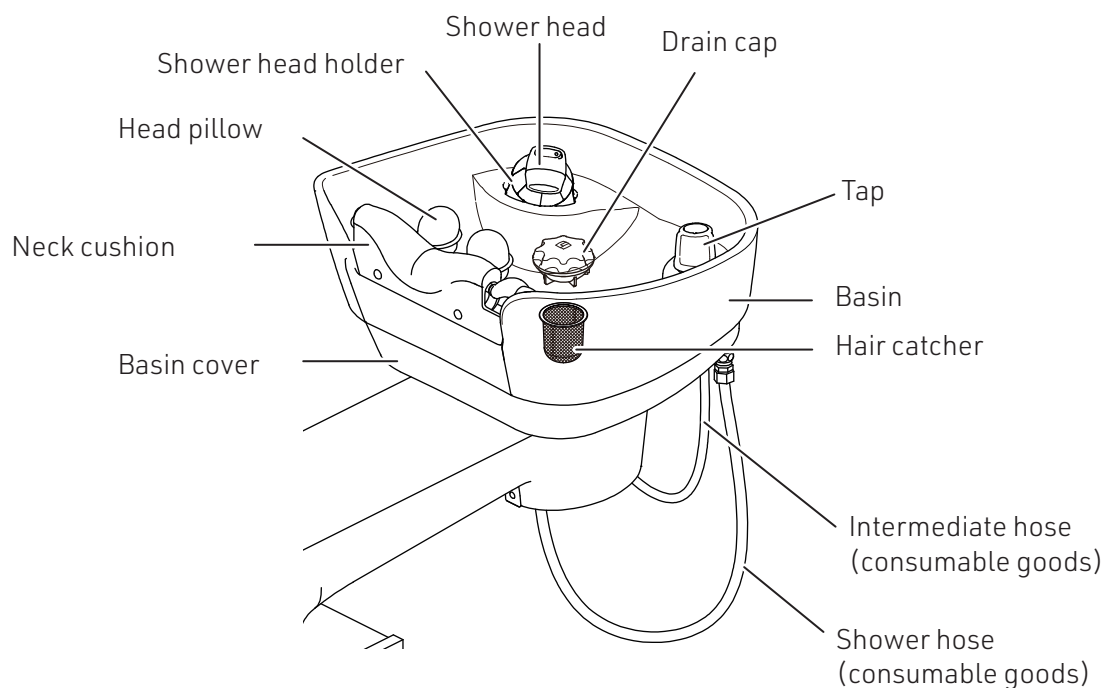

The outer cover is made of resin. There may be sections with streaks or color variations; however, these occur in the process of manufacture and are not considered an abnormality and represent no problems in quality.

Shower head

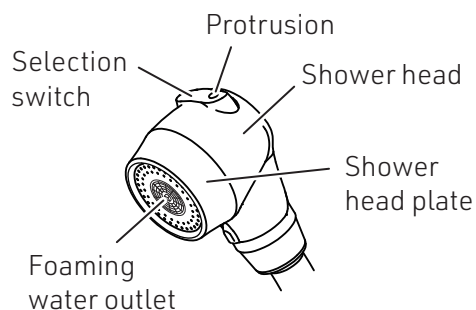

Shower head holder

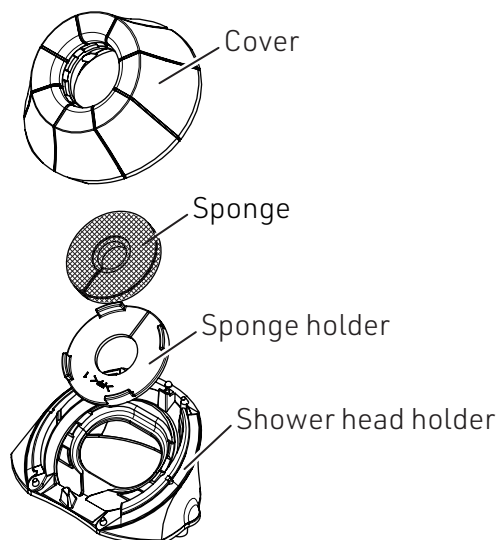

Removal of the Shower Head Holder Cover

1 Turn the cover counterclockwise

Turn the cover until it stops (about 5°).

2 Pinch the front and back of the cover to deform and remove the catch

[Image]

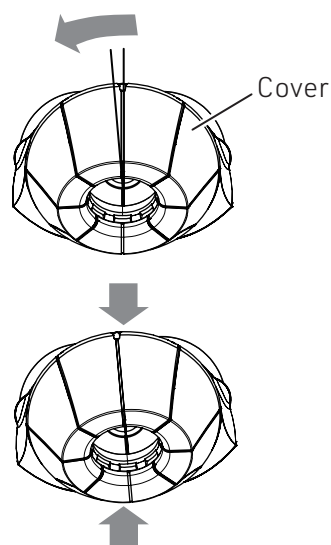
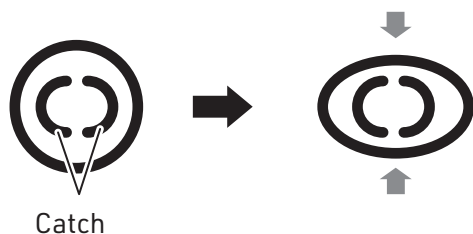

CAUTION

Do not apply excessive force when removing the cover of the shower head holder. Force applied to the assembled part may cause damage to the parts.

Attaching the Sponge

Attach the sponge to the shower hose

Attach the sponge to the shower hose between the cover and the shower head holder from the cut section of the sponge.

CAUTION

Be careful not to attach the sponge in an incorrect direction.
The hard side faces up.

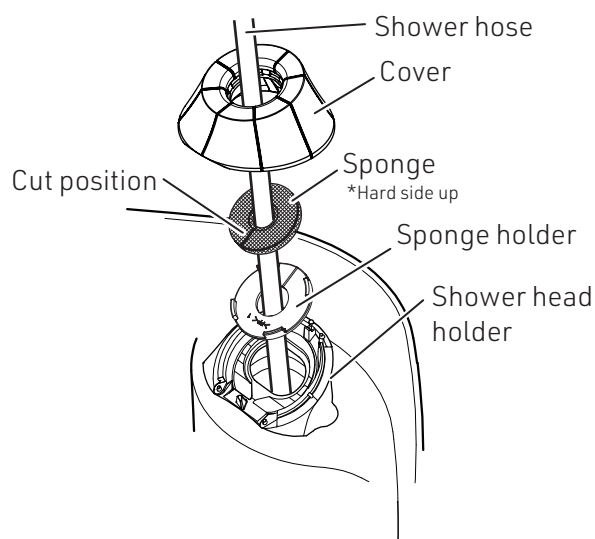

Attachment of the Shower Head Holder Cover

Align the groove of the cover with the protrusion on the shower head holder and secure the cover so that it clicks.

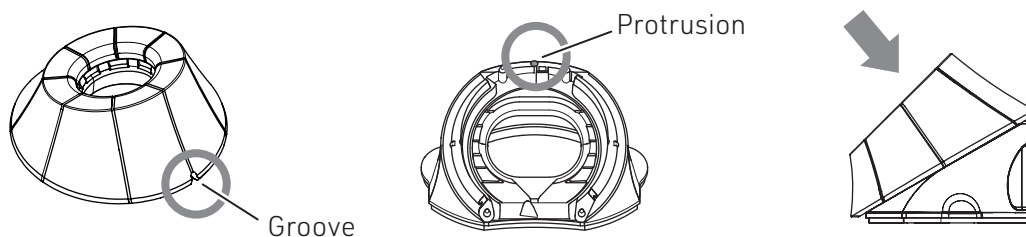

Attaching the Neck Cushion

1 Align the neck cushion as shown in the figure and fit the neck cushion to the mounting fixture

Make sure that the neck cushion faces the correct direction.
Be sure that the entire neck cushion fits inside the basin.

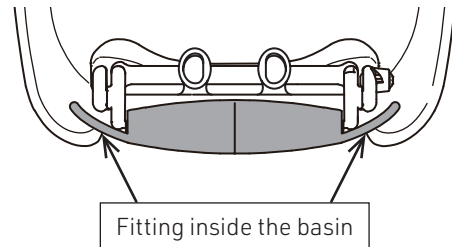
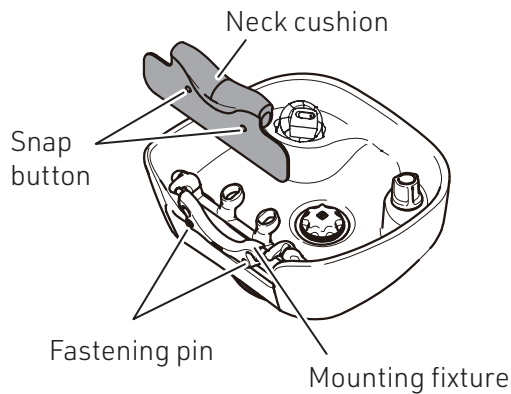

2 Attach the snap button on the left side of the neck cushion to the fastening pin on the mounting fixture

Check that the snap buttons on the front and back are attached.

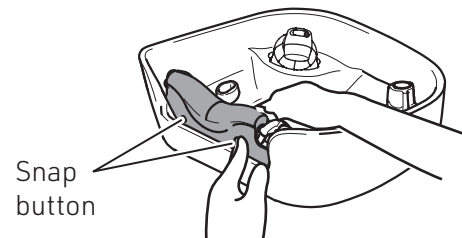

3 Shape the neck cushion along the mounting fixture and attach the snap button on the right side to the fastening pin on the mounting fixture

Check that the snap buttons on the front and back are attached.

Fastening pins are removable.
Make sure that the pins are not misplaced.

CAUTION

- When removing the neck cushion, remove the snap buttons (four locations) from the fastening pins and lift the neck cushion. Removing the snap buttons forcibly with excessive power may cause the parts to break.
- Check that the entire neck cushion is contained inside the basin and check that the neck cushion is not folded or attached in an unnatural position. This may cause the neck cushion to break or cause the water to spill out from the front of the basin.
- Do not apply excessive force when attaching the neck cushion. This may cause damage to the neck cushion.

Attaching the Head Pillow

Align the head pillow to the mounting part as shown in the figure and insert the pillow into the mounting fixture.

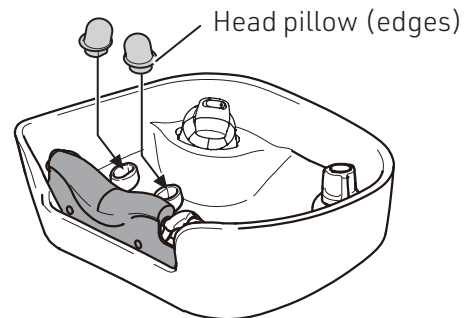
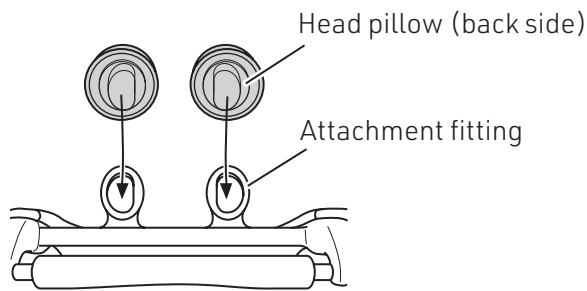

Hold the head pillow by the edges when inserting the head pillow.

Neck cushions and head pillows should be considered consumable goods. These should be replaced if they are stained significantly or if the surface becomes deteriorated. Contact your local Takara Belmont dealer to replace the neck cushion and head pillow.

Using the Shower Head

Use the selection switch to change between shower mode and foaming mode.

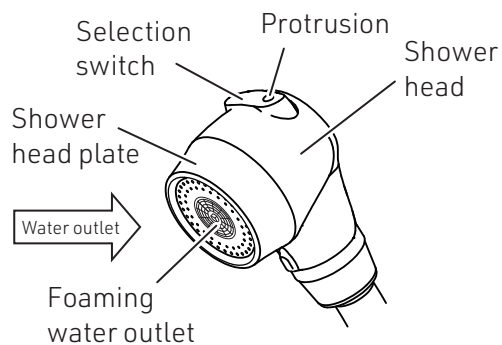

[Shower mode]

Press the protrusion of the switch.



[Foaming mode]

Press the flat side of the switch.



CAUTION

- Avoid output of water in large amounts with the shower head resting on the shower head holder. This may cause the water to spill out of the basin and cause device malfunction or floor damage.
- Be sure to return the shower head to shower head holder after use. Make sure that the shower head is returned to the shower head holder so that the shower head plate is facing towards the basin.
- Do not use excessive force to pull on the shower hose. This may cause damage to the shower hose and result in water leakage accidents.

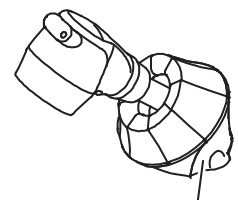

Shower head holder

Adjusting the Amount of Hot Water

Turn the tap to the left (counterclockwise) to release hot water from the shower head. The amount of water increases when the tap is turned to the left. The maximum amount of water is released when the tap is turned fully to the left. The water stops when the tap is turned fully to the right (clockwise).

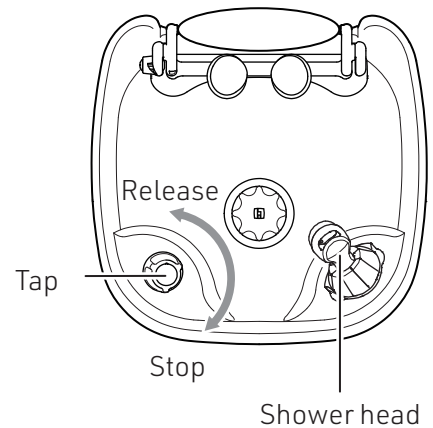

CAUTION

- When the basin is not in use, make sure that the hot water is stopped completely by turning the tap fully to the right (clockwise). Water leakage accidents may occur if the water is not stopped completely.
- Do not block the drain outlet with a drain cap, towel, or hairdressing gown after completion of the work. Accidental release of water or slight output of hot water due to the nighttime increase in water pressure may cause the water to spill out of the basin and lead to water leakage accidents.
- If the water is drained slowly, the pipe may become clogged with rubbish or other matter. Discontinue use of the product and contact your local Takara Belmont dealer.
- Remove metal articles, such as rings and watches, before operating the tap. Contact of metal articles with the tap may cause the plated surface to become scratched or cracked, which may lead to peeling of the plated surface.
- Check that there are no scratches, cracks, or peeling on the plated surface of the tap. If the plating has peeled off, discontinue use immediately and contact your local Takara Belmont dealer. Continued use without replacing these parts may result in injury.

- Sound of water flowing may be heard from the basin depending on the environment and conditions of use.

This occurs because of the rapid flow of hot or cold water due to the high water pressure or adjustment of the amount of hot water and is not considered to be a device defect. The sound of water flowing may be reduced by adjusting the water pressure.

- The tap may feel stiff when turning depending on the environment and conditions of use. This is caused by deterioration and a shortage of grease in the gasket of the moving parts from changes over time and requires replacement of the gasket or the application of grease.

Contact your local Takara Belmont dealer for adjustment and replacement described above.

- Dripping of water from the shower is caused by draining of the residual water in the shower head and is not considered a defect.

Adjusting the Temperature of Hot Water

- 1) Turn the thermostatic control knob towards H or C to set the water to the appropriate temperature. Turn towards H to make the water hotter and towards C to make the water colder.

CAUTION

When adjusting the temperature of the hot water, reduce the amount of hot water and change the direction of the shower head away from the customer and adjust the temperature while checking the temperature with the hands. Care must be provided during this operation because it may lead to boiling water being output.

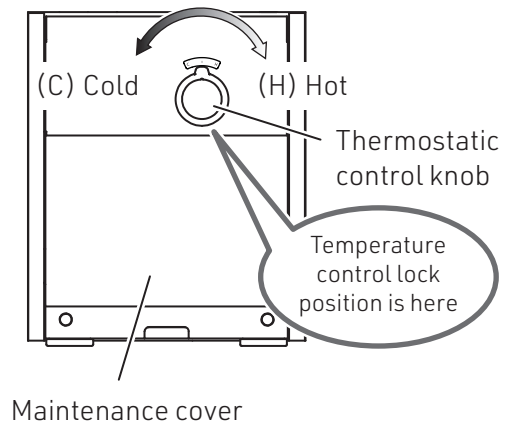

- 2) Continue to turn the thermostatic control knob towards H until the knob stops at the position shown in the figure on the right (temperature control lock position). When water hotter than this point (about 40°C or more) is to be used, turn the knob towards H while pressing the stop button on the thermostatic control knob to obtain boiling water.

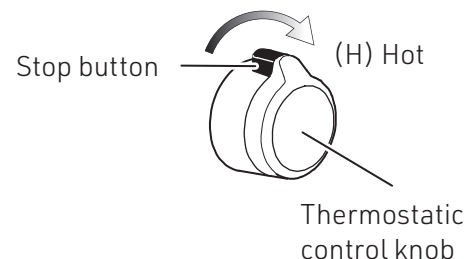

- * The water supply temperature for the hot water supply unit should be set at least 10°C higher than the temperature of the water output.
- * The device is only capable of outputting water up to about 49°C in temperature. (However, the value shown above applies when the water is supplied at the same pressure with cold water supplied at 20°C and hot water supplied at 60°C in temperature, and variations may occur in according to the hot water supply unit and pipe environment used.)

WARNING

- Check the position of the thermostatic control knob before releasing water. Boiling water may be output and may cause burns. Also, avoid operating the thermostatic control knob when washing the hair if a temperature higher than the temperature control lock position is used. Error in operation may cause the hot water to spill onto the head and cause burns.
- If the knob is turned higher than the temperature control lock position, this must be returned to the temperature control lock position after use. Using the product at a higher temperature may cause hot water to come in contact with the hands and head and result in burns.

CAUTION

- Remove metal articles, such as rings and watches, before operating the thermostatic control knob. Contact of metal articles with the thermostatic control knob may cause the plated surface to become scratched or cracked, which may lead to peeling of the plated surface.
- Check that there are no scratches, cracks, or peeling on the plated surface of the thermostatic control knob. If the plating has peeled off, discontinue use immediately and contact your local Takara Belmont dealer. Continued use without replacing these parts may result in injury.

Adjusting the Temperature of Hot Water

- The amount and temperature of water output may change significantly when adjusting the temperature of the hot water depending on the environment and conditions of use. This occurs when the temperature of the hot water supply is outside the recommended level (60°C to 80°C is recommended), if the pressure of the cold and hot water supply is high, if there is a significant difference in the pressure of the cold and hot water supply, or if multiple devices are used simultaneously, and these variations are not considered device defects.
- The temperature of the hot water at the temperature control lock position does not reach 40°C (guideline for appropriate temperature) depending on the environment and conditions of use; however, this is not an abnormality. This lock function is intended as an assisting safety function to prevent sudden output of boiling water by an error during operation.
- Contact your local Takara Belmont dealer for adjustment operations, including the adjustment of the temperature for the hot water supply, adjustment of cold and hot water pressure, and adjustment of the temperature control lock position on the thermostatic control knob.

Filling the Basin with Hot Water

When filling the basin with hot water for the emulsification operation, such as in hair coloring, this can be done by closing the drain outlet by turning the drain cap clockwise.

The hot water should be filled up to the dotted line in the figure below [designated maximum level] (below the level where the shower head holder is attached).

Filling the water above this level will cause hot water to spill out of the shower hose slot.

To drain the water in the basin, open the drain outlet by turning the drain cap counterclockwise. This will allow the water to drain from the basin.

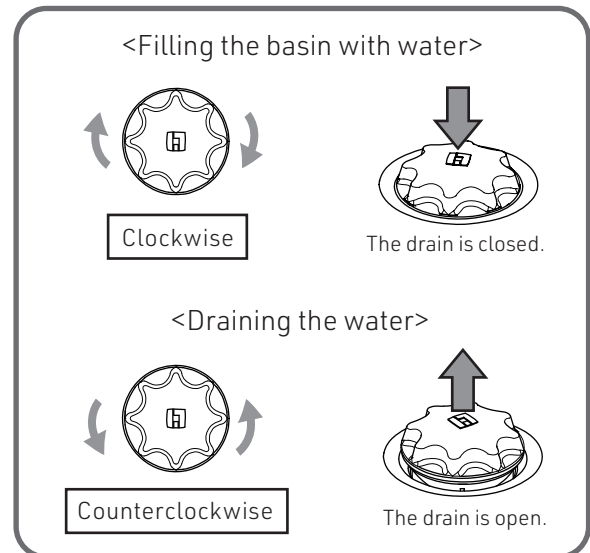

[Designated maximum level]

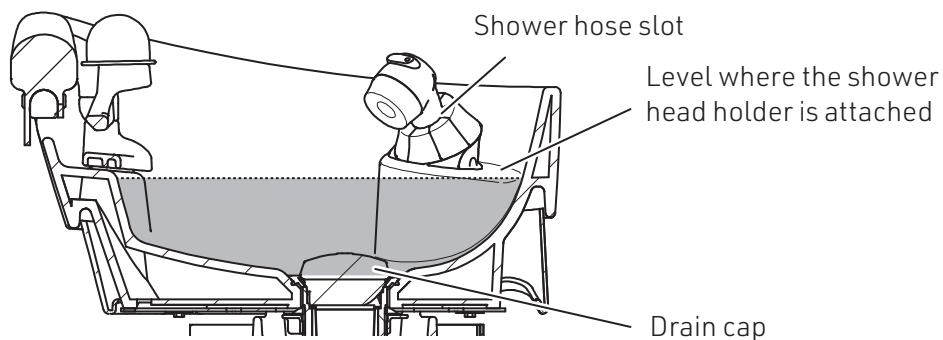

CAUTION

- The water level at which the water spills out of the shower hose slot is lower than it looks. Be sure to keep the water level below the designated maximum level when filling the basin with hot water. [See the figure above]
- Do not leave the shower head inside the water in the basin. The water in the basin may regurgitate if the pressure inside the water pipe decreases because of the accidental cutoff of the water supply.
- If the water is drained slowly, the pipe may be clogged with rubbish or other matter. Discontinue use of the product and contact your local Takara Belmont dealer.
- When the product is not in use, be sure to remove the drain cap from the drain outlet and place it outside the basin. If the drain cap is not removed, the drain cap may close accidentally, and the water may spill out of the basin without noticing the water being released, which may result in water leakage accidents.

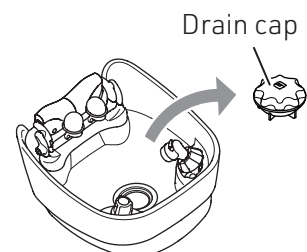

A slight amount of water that does not interfere with operation may be released after the basin is filled with hot water; however, this is not considered a device defect. If there is a significant increase in the amount of water loss, the gasket section of the drain cap may be deteriorated or worn out. Be sure to replace the drain cap.

Contact your local Takara Belmont dealer to replace the drain cap.

Fix the Neck Device (during intermediate rinsing)

The following preparation must be performed before allowing the customer to lie down.

- 1 Rotate the head pillow section as shown in the figure below**

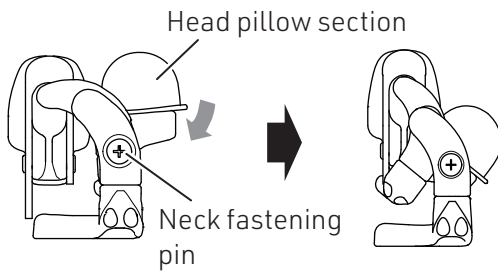

- 2 Push the neck fastening pin**

Check that the neck fastening pin pressed from outside is pushed through and inward.

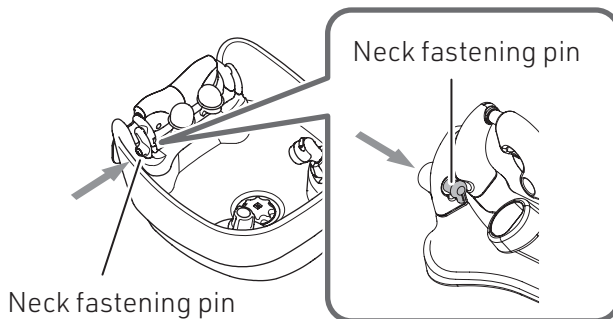

- 3 Lock the neck fastening pin pushed inwards by turning clockwise**

- 4 Remove the head pillow**

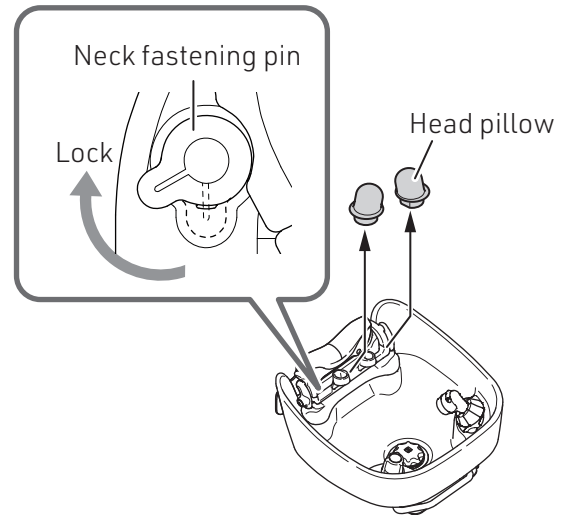

CAUTION

Make sure that the neck fastening pin is locked when using the product with the neck device fixed.

Using the product without locking the neck fastening pin may cause the neck device to become loose during treatment, which may cause the customer to be hit on the head and become injured.

Return the Neck Device to the Normal State

The following preparation must be performed before allowing the customer to lie down.

- 1 Attach the head pillow**
- 2 Unlock the neck fastening pin by turning counterclockwise**
- 3 Pull in the neck fastening pin**
- 4 Rotate the head pillow section as shown in the figure below**

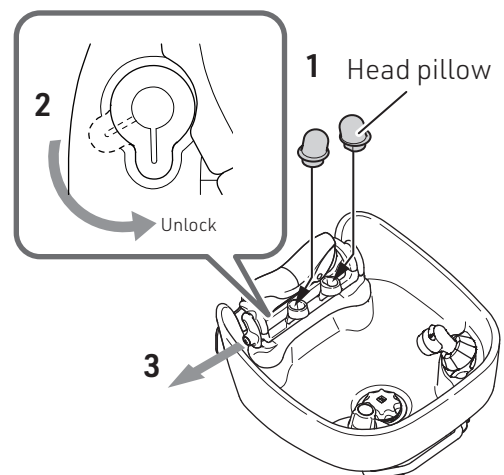
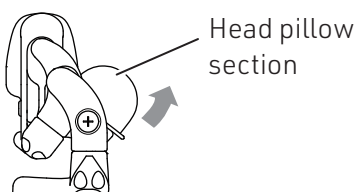

Wash the Hair

1 Check that the chair and the basin have been returned to the initial position

⚠ CAUTION

Rotating the chair without returning to the initial position may cause accidental contact of the chair with the product and accessories, resulting in damage.

2 Ask the customer to sit in the chair

Put on the hairdressing gown.

⚠ CAUTION

Do not allow the customer to lean on the basin or the arm when sitting in the chair. The basin and arm may move and cause the customer to fall over.

3 Unlock the chair rotation with the customer sitting in the chair, then rotate the chair to the position for treatment

* See the operating instructions of the chair being used on how to unlock the chair rotation.

⚠ CAUTION

Check that the customer is sitting in the chair before moving the chair. The step or basin may come in contact with the customer accidentally and cause injury.

Rotate the chair to the position shown with the sticker on the chair base.

* Refer to the attached work instructions for the procedure for attaching the sticker to the chair.

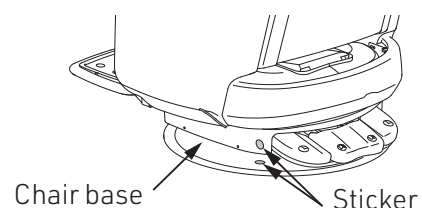
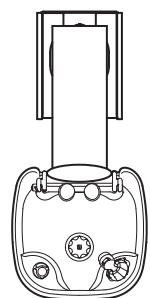
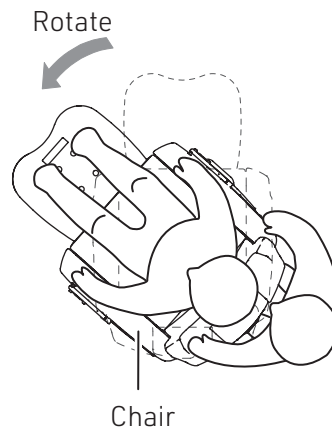
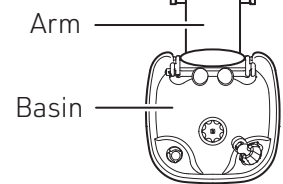
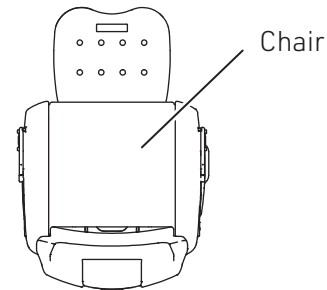
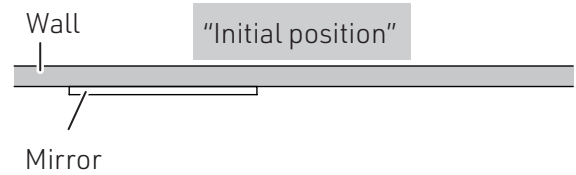

Wash the Hair

4 Lock the chair rotation

* See the operating instructions of the chair being used on how to lock the chair rotation.

5 Move the basin slowly to the position for treatment and lock the arms

* A slight click can be felt when locked.

"Position for treatment"

WARNING

Keep the hands and fingers away from the rotating section of the arms. This may lead to injury caused by jamming.

CAUTION

When moving the basin, hold the basin with both hands and lock slowly near the initial position and the position for treatment. Moving the basin rapidly to the lock position may cause damage to the device and injury to the customer.

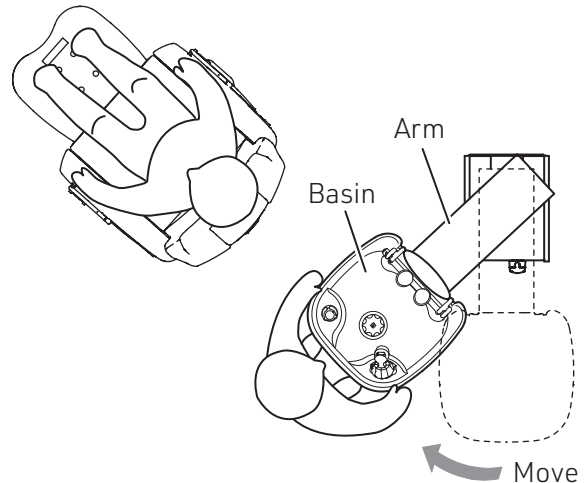

CAUTION

- Check that the basin is empty before moving the basin. Failure to do so may cause the water to spill out of the basin and stain the floor, furniture, or clothes. Also, wetting of the product may cause a malfunction or damage.
- Before moving the arm, check that chemicals are not placed on the arm top panel. This may result in falling and damage.
- Before moving the arm, check that there are no people or objects in the surrounding area. Failure to do so may result in accidental contact, causing damage or injury.

"Position for treatment"

6 Turn the basin towards the customer

CAUTION

- When rotating the basin, hold the basin with both hands and rotate slowly. Moving the basin rapidly may cause damage to the device and injury.
- There is a fixed range in which basin can be rotated. Device damage or injury may occur if the basin is turned beyond the necessary extent.

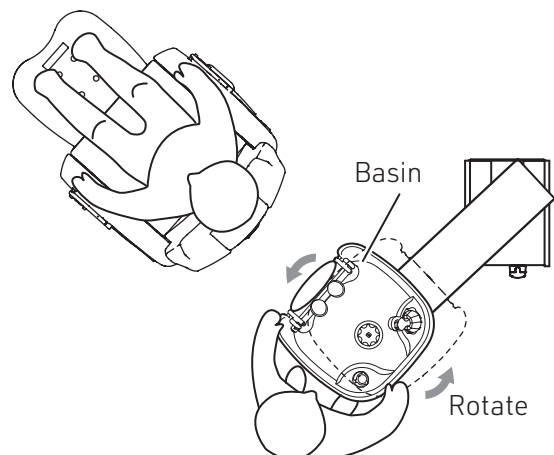

Wash the Hair

7 Allow the customer to lie down

Lower the backrest of the chair while supporting the head of the customer, then lower the customer's head gently onto the neck cushion.

* See the operating instructions of the chair being used on how to lower the backrest of the chair.

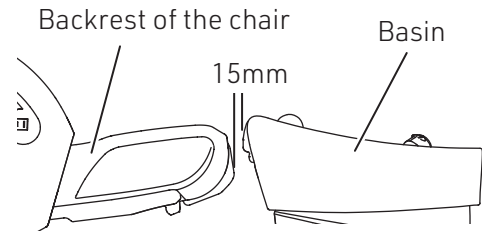

The space between the backrest of the chair and the basin should be about 15 mm.

CAUTION

- When lowering the backrest of the chair, be sure to support the head of the customer with your hand. Failing to do so may result in injury from accidental contact of the basin with the head.
- Utmost care must be taken when operating chairs with auto-setting functions to avoid the body and other objects from becoming caught between the chair and basin when lowering the backrest of the chair.

8 Check that the chair and the basin are in a straight line

Unlock chair rotation as necessary and make fine adjustments so that the chair and the basin are in a straight line.

*If fine adjustments are made, be sure to lock the chair rotation afterwards.

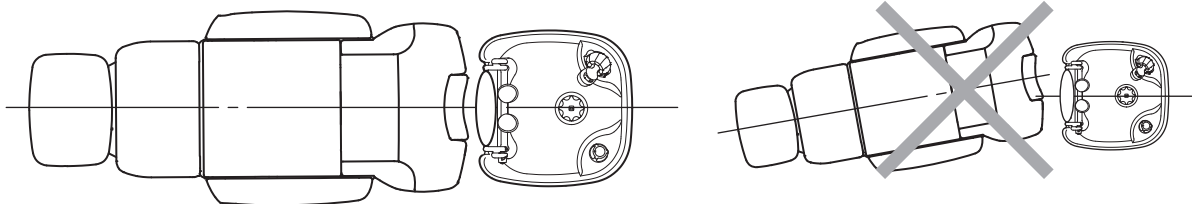

WARNING

- If the chair rotation is unlocked for fine adjustments with the customer lying down, make sure that the head of the customer is supported with a hand. Unlocking chair rotation without supporting the customer's head may lead to injury in the customer.
- After fine adjustments of the chair, the chair must be locked before washing the hair. Failure to lock the chair may result in movement of the chair and lead to injury in the customer.

Wash the Hair

9 Check that the face angle is appropriate

Check that the face angle is set as suitable for each posture as shown in the figure below. If the angle is not correct, make fine adjustments by asking the customer to move forward or backward.

<Lying flat>

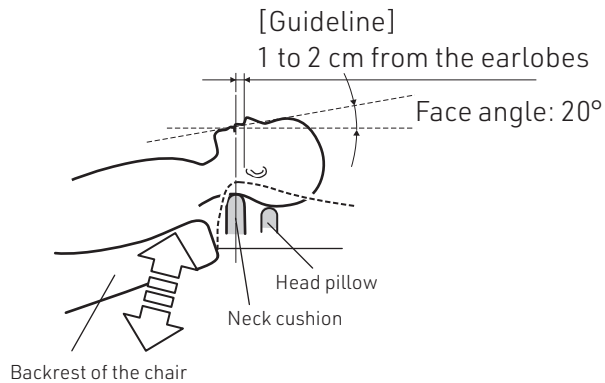

<Flat posture>

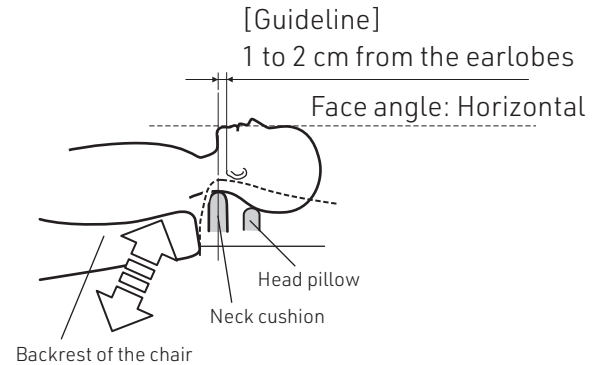

10 Raise or lower the chair and adjust the height of the backrest as necessary

* See the operating instructions of the chair being used on how to raise or lower the chair.



CAUTION

When moving the chair, care must be taken for interference between the backrest of the chair and the basin. Failure to do so may result in damage, malfunction, or injury caused by jamming.

11 Carry out hair washing operation

12 Raise the backrest of the chair after washing the hair

Raise the backrest of the chair while supporting the head of the customer.

Wash the Hair

13 Move the arm to the initial position

Hold the basin with both hands and move to the initial position.

* The basin clicks slightly and becomes locked when returned to the initial position.



WARNING

Keep the hands and fingers away from the rotating section of the arms. This may lead to injury caused by jamming.



CAUTION

- When moving the basin, hold the basin with the hands and lock slowly near the initial position and the position for treatment. Moving the basin rapidly to the lock position may cause damage to the device and injury to the customer.
- When returning the basin, move the basin fully to the initial position. If the basin is not moved completely, this may interfere with the chair and result in device damage.
- Check that the basin is empty before moving the basin. Failure to do so may cause the water to spill out of the basin and stain the floor, furniture, or clothes. Also, wetting of the product may cause a malfunction or damage.
- Before moving the arm, check that chemicals are not placed on the arm top panel. This may result in falling and damage.
- Before moving the arm, check that there are no people or objects in the surrounding area. Failure to do so may result in accidental contact, causing damage or injury to the customer.

14 Turn the basin to the front



CAUTION

- When rotating the basin, hold the basin with both hands and rotate slowly. Moving the basin rapidly may cause damage to the device and injury to the customer.
- There is a fixed range in which basin can be rotated. Device damage or injury may occur if the basin is turned beyond the set range.

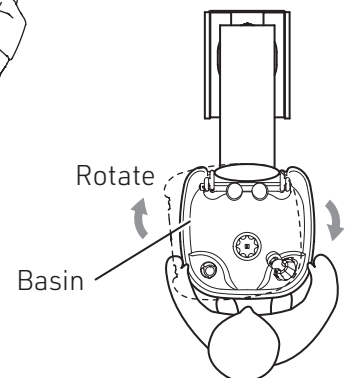
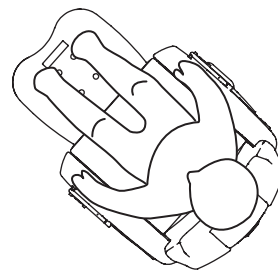

Wash the Hair

15 Move the chair to the initial position

* See the operating instructions of the chair being used on how to lock and unlock the chair rotation.

WARNING

- Return the chair to the initial position and lock the chair rotation before guiding the customer to leave the chair. If the customer leaves the chair without locking the chair rotation, the customer may fall and become injured or cause damage to the device.
- When lowering and rotating the chair, be sure to check that there are no people or objects in the surrounding area. Special care must be taken for the presence of small children.
- When lowering and rotating the chair, be sure to check that there is sufficient space between the customer's feet and the wall in front and the accessories.

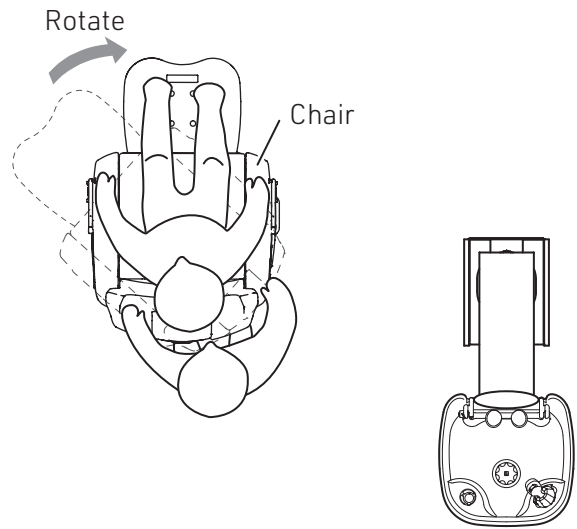

16 Lock the chair rotation

* See the operating instructions of the chair being used on how to lock the chair rotation.

17 Wipe off any water on the device after use

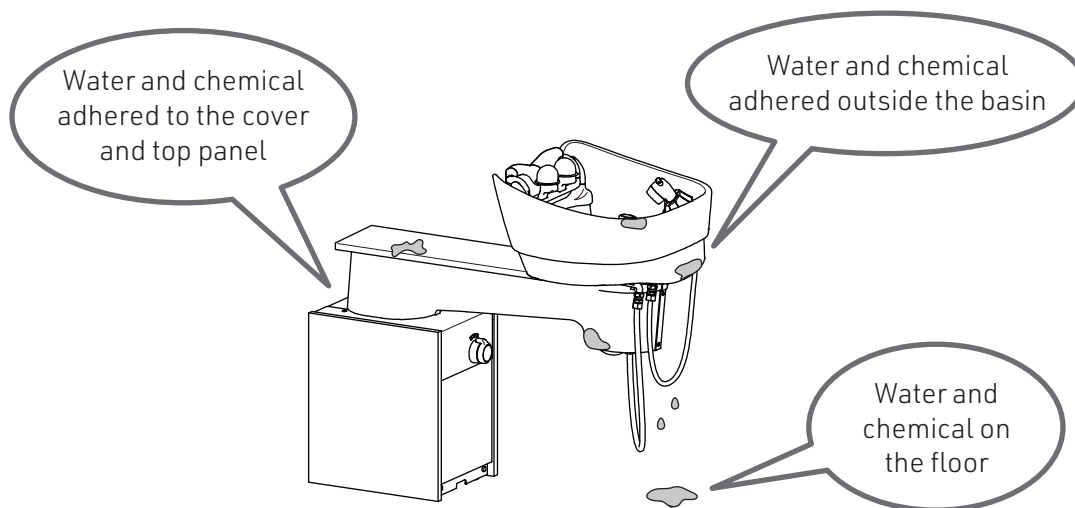

Maintenance Method

Maintenance should be performed after using the product to keep it clean at all times.
Stains left uncleaned may lead to the growth of mold.

**WARNING**

Do not wash the device with water. This may lead to a malfunction.

**CAUTION**

Some of the product's metal parts and mechanical sections may be sharp. Care must be taken when handling to avoid injury to the hands and fingers.

Maintenance of Individual Parts

Resin parts/Wooden parts/Glass

Wipe gently with a dry, soft cloth.

For severe staining

Wipe with a soft cloth wet with neutral detergent diluted about tenfold with water, followed by wiping with a cloth wet with water, then carefully wipe with a dry cloth.

Metal parts:

Wipe with a dry, soft cloth.

Do not wipe with wet cloth as the device is susceptible to moisture and water. If the device is exposed to water, wipe off the water immediately. Failure to do so may result in rust and malfunctions of the electric parts.

- The following materials must not be used:

Volatile chemicals, such as thinner, nail polish remover, gasoline, and kerosene, acid, alkaline or chlorine-based detergents, antiseptic solution strongly corrosive to metals (Povidone Iodine, etc.), waxes containing abrading agents, sponges containing abrading agents, and scrubbing brushes (*) or other cleaning tools.

* This can be used on the ceramic basin only.

- Avoid using brush and scrubber for maintenance. This may result in scratching of the device and difficulty removing stains. However, this does not apply to the following cases:
 - Use of toothbrush to clean the shower head plate and foaming water outlet [page 29]
 - Use of melamine sponge and soft toothbrush to clean the ceramic part inside the basin [page 27]

Cleaning must be performed if the product is being reused after a period of nonuse.
Also, be sure to check that the product operates correctly after cleaning.

Maintenance Method

Basin

Apply cream cleanser to a soft sponge that has been wet with water and drained fully and use this to wipe off the stains. After cleaning, rinse fully with water and wipe carefully with a dry cloth.

Use a soft toothbrush to clean the areas that are difficult to reach with a sponge.

If the stain cannot be removed, use a melamine sponge wet with water.

Use cotton buds and other materials to carefully clean around the neck cushion and head pillow mounting fixture.

Around the mounting fixture of the head pillow

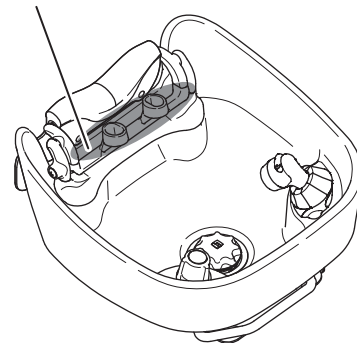

CAUTION

- Avoid using metal scrubber, hard brush, and cleanser containing alumina minerals. This may lead to scratching.
- Do not use materials on the resin parts, such as the tap and thermostatic control knob, as well as metal parts with surface treatment, including neck parts. This may lead to scratching.

Hair catcher

Remove the hair catcher under the drain cap and remove the hair accumulated. Hair catcher should be considered consumable goods. It should be replaced if they are stained significantly or if the surface becomes deteriorated.



CAUTION

The hair catchers should be cleaned as frequently as possible. Continued use without cleaning may cause the accumulated hair to clog the drainage, resulting in overflowing of water and unhygienic conditions. Cleaning should be performed every time the customer's hair is washed where possible.

Drain cap

Hair catcher

Drain outlet

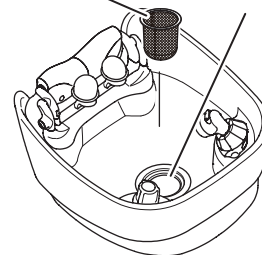

CAUTION

Do not discard the hair accumulated in the hair catcher or hair adhered to the basin into the drain. Also, do not wash the hair without attaching the hair catcher. Discarding the hair into the drain causes the hair to accumulate in the drainage pipe and hose, leading to water leakage and connection defects.

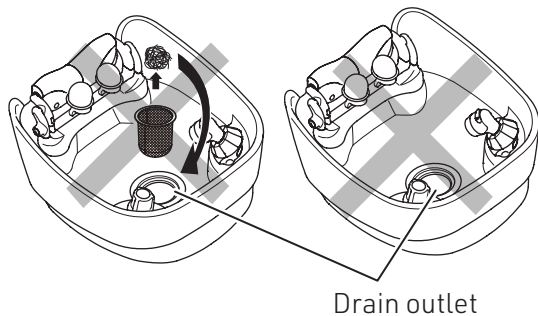

Maintenance Method

Drain cap

Wash the outside of the gasket attached to the periphery of the drain cap to remove hair and stains caused by chemicals and other materials. The drain cap should be considered consumable goods. If there is a significant increase in the amount of water loss, the gasket section of the drain cap may be deteriorated or worn out. Be sure to replace the drain cap. Contact your local Takara Belmont dealer to replace the drain cap.

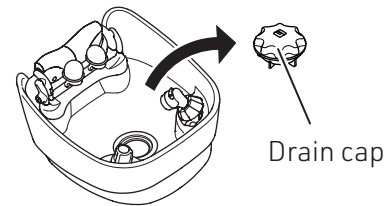
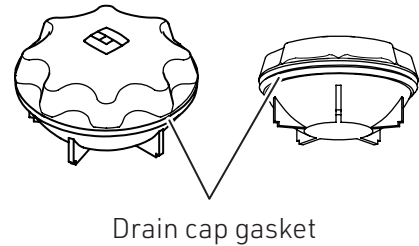

CAUTION

- When the product is not in use, be sure to remove the drain cap from the drain outlet and place it outside the basin. If the drain cap is not removed, the drain cap may close accidentally, and the water may spill out of the basin without noticing the water being released, which may result in water leakage accidents.
- The drain cap should be handled carefully. Dropping the drain cap may result in damage.
- The drain cap gasket is attached to the drain cap. Removing this forcibly may cause the drain cap gasket to become scratched and accelerate water drainage when filling the basin with water.

Tap and thermostatic control knob

Wipe with a soft cloth wet with neutral detergent diluted about tenfold with water.

CAUTION

- Use of a sponge, including a household sponge, should be avoided as repeated use may scar the surface.
- Avoid the use of abrading agents, sponges containing abrading agents, metallic scrubbers, and nylon scrubbers as these may scratch the surface.
- Do not use chlorine-based chemicals or acidic and alkaline chemicals for cleaning stubborn stains because this may cause the surface plating to peel off.
- If the plated surface of the thermostatic control knob or the tap (resin plated parts) has peeled off or has become scratched, discontinue use immediately and contact your local Takara Belmont dealer. Hand injuries may occur from the peeling of the plated surface.

Maintenance Method

Shower head

- 1 Turn the shower head plate counterclockwise to detach, then remove three parts (shower head plate, foaming water outlet, rubber gasket)

Do not remove the O-ring.

2 Clean (rinse) the shower head plate

- The shower head plate should be cleaned once a week.
- Clean the stains (such as scales) adhered to the shower hole on the shower head plate using toothbrush or similar materials.

3 Clean (rinse) the foaming water outlet

- The foaming water outlet should be cleaned once a month (approximately).
- Clean the stains (such as scales) adhered to the foaming water outlet using a toothbrush or similar materials.

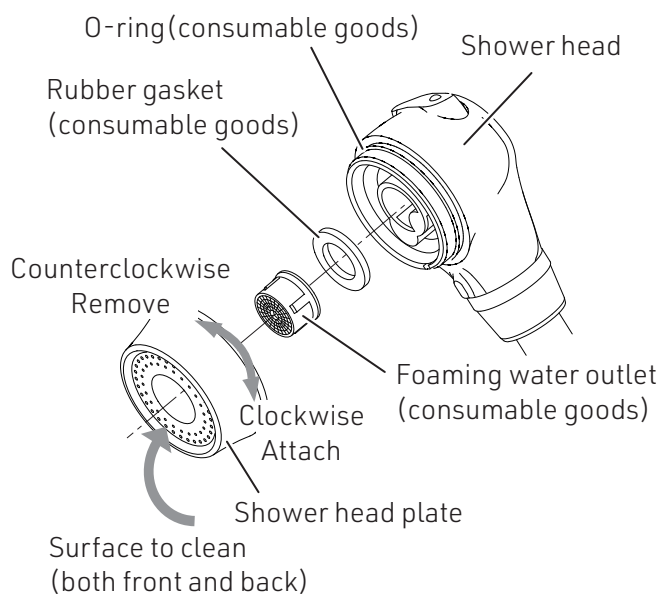

Rinse the foaming water outlet in the direction shown in the figure.

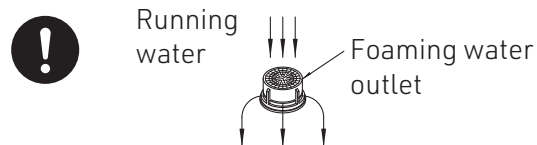

4 Reassembly

- 1) Set the foaming water outlet and the rubber gasket onto the shower head plate in that order.
- 2) With the water outlet surface of the shower head plate facing down, turn the shower head plate clockwise to attach it to the main unit of the shower head.

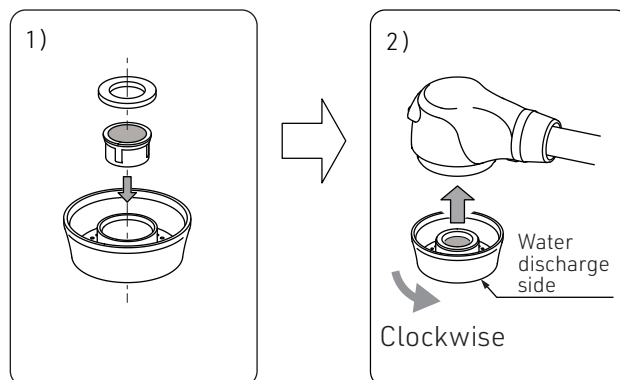

CAUTION

Failure to clean the foaming water outlet regularly may lead to clogging and a sharp foreign sound from the shower head.

Maintenance Method

Neck cushion and head pillow

After the work has finished for the day, rinse with water and carefully wipe off the water with a dry towel before allowing to air dry. For severe stains, wash with neutral detergent diluted about tenfold with water, rinse with water, then wipe with a soft, dry cloth before allowing to air dry. The surface of the neck cushion and head pillow is soft and susceptible to scratching. Rubbing with fingernails may cause the surface to tear. Be sure to wash by massaging with fingers.

Neck cushions and head pillows should be considered consumable goods. These should be replaced if they are stained significantly or if the surface becomes deteriorated. Contact your local Takara Belmont dealer to replace the neck cushion and head pillow.

CAUTION

- Chemicals adhered to the neck cushion and head pillow should be washed off immediately. This may result in degeneration and discoloration.
- Maintenance of the neck cushion and head pillow should be performed every day. Stains left uncleaned may lead to the growth of mold.

Sponge

Sponges should be considered consumable goods. Sponges should be replaced if the sound of friction with the shower hose can be heard due to deterioration. Contact your local Takara Belmont dealer to replace the sponges.

Preparation "Removing the cap on the shower head holder"
Please refer to [page 12] for instructions on how to remove the cover.

- Remove the sponge from the shower hose and rinse with water.
- After rinsing the sponge, squeeze the sponge between two hands to drain the water.
- The sponge should be cleaned every day.
- After cleaning, the sponge should be attached to the shower hose and returned to the inside of the cover.

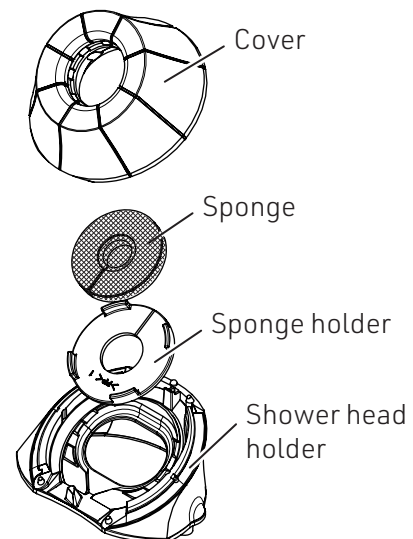

CAUTION

- The sponge should remain in the net during maintenance. If the sponge comes out of the net, this should be pushed back into the net.
- Avoid twisting because this may cause damage to the parts.
- Be careful not to attach the sponge in an incorrect direction. The hard side faces up.

Maintenance Method

Cover

The cover of the shower head holder should be replaced if it falls off easily.
Contact your local Takara Belmont dealer to replace the cover of the shower head holder.

[How to replace]

1 Removing the shower head (right figure)

2 Remove the cover of the shower head holder from the shower head holder

"Removing the cover on the shower head holder"

Please refer to [page 12] for instructions on how to remove the cover.

3 Remove the cover of the shower head holder from the shower hose

Remove the cover of the shower head holder by pressing against the socket.

4 Attach the new cover for the shower head holder

Key point in attachment

Cover the socket on the end of the shower hose with a vinyl bag and push the cover of the shower head holder against this to make insertion easier.

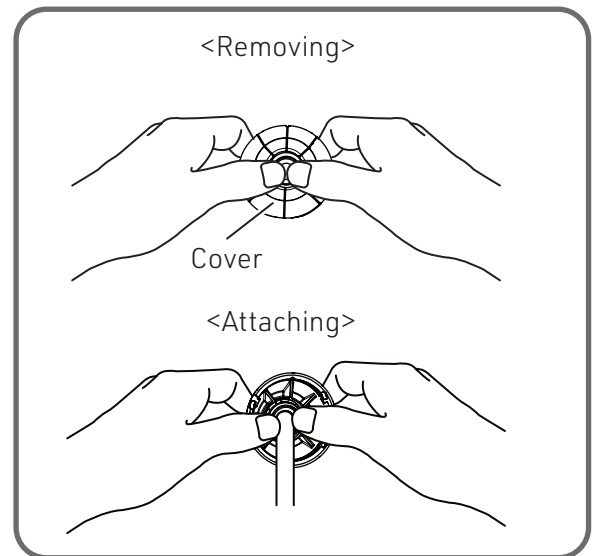
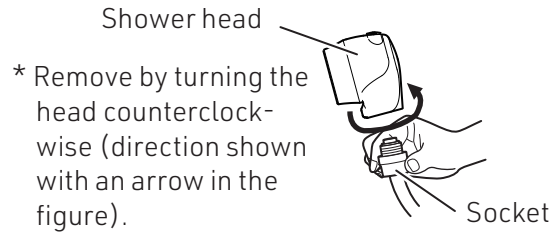

5 Attach the cover of the shower head holder to the shower head holder

"Attaching the cover on the shower head holder"

Please refer to [page 12] for instructions on how to attach the cover.

Main unit cover (including arm top panel and side panel)

Remove any water and chemicals adhered to the cover as well as any hair and rubbish accumulated between the steps in the cover, then wipe with a soft, dry cloth. For severe stains, wash with neutral detergent diluted about tenfold with water, rinse with water, then be sure to wipe with a dry cloth.

⚠ CAUTION

Volatile chemicals, such as thinner, alcohol, gasoline, and kerosene, waxes containing abrading agents, sponges containing abrading agents, detergents containing organic solvents, acids, alkaline or chlorine-based detergents, and cleaning tools, such as scrubbers, must not be used. This may cause scratching, discoloration, and damage.

Maintenance Method

Strainer

The strainer (inside the catch valve) must be cleaned regularly to prolong the life of the product. Also, the catch valve must be drained in cold regions where freezing is expected to occur.

CAUTION

- Be sure to take precautions to prevent freezing in cold regions, including the draining of water. Failure to do so may cause water leakage accidents.
- Contact of water with nearby electrical parts must be avoided when cleaning or draining the strainer. Failure to do so may result in device malfunction and fire caused by electrical faults.

1 Prepare cloths (at least two) to catch the water

2 Remove the maintenance cover

Remove the urea screw (two screws) on the maintenance cover.

* Care must be taken to prevent misplacing the removed urea screws.

CAUTION

Be sure to hold the maintenance cover when removing the urea screws. Failure to do so may cause the maintenance cover to fall and become damaged.

After removing the maintenance cover, check that no water leakage has occurred inside the cover. If water leakage has occurred, contact your local Takara Belmont dealer because the pipe may be damaged.

3 Spread the cloths over the floor around the hot and cold water pipes

CAUTION

- If there are electrical parts nearby, including wires, contact with water must be avoided. This may lead to a fire caused by an electrical fault.
- The hot water pipe is hot to the touch. Avoid touching the pipe directly.

4 Close the cold and hot water supply tap

To prevent water leakage, check that the taps are fully closed before draining and cleaning the strainer.

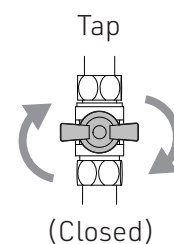
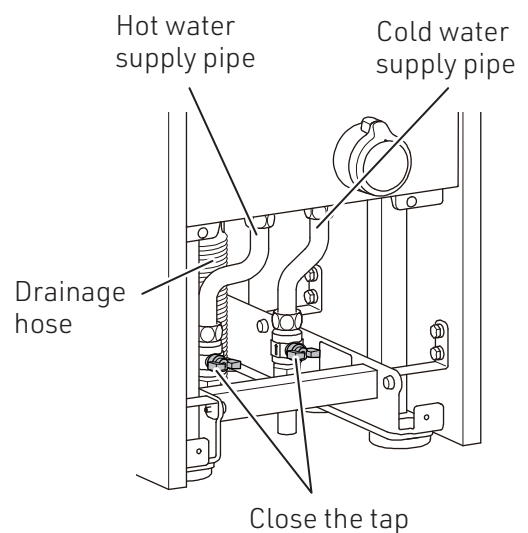
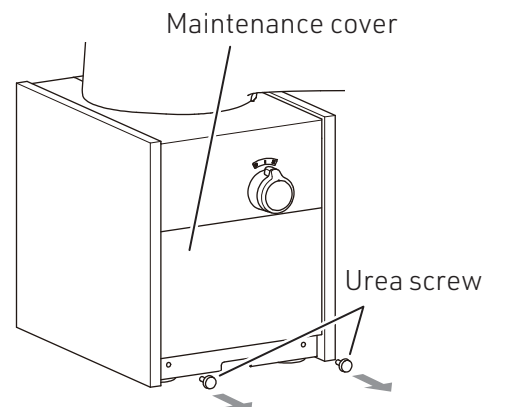

Maintenance Method

5 Hold a cloth underneath the check valve with strainer and remove the strainer to drain water

Tools required: Flathead drive

* Draining and cleaning operation should be conducted for both the hot and cold water pipes.

CAUTION

Removing the strainer from the hot water may cause output of boiling water. Utmost care must be taken when draining hot water.

6 Clean the mesh on the strainer using a soft brush (such as toothbrush) then return this to the original check valve with the strainer and screw tightly

7 Wipe off any spilled water and remove the cloths from the floor

CAUTION

- Screw the strainer tightly.
Loose strainers may cause water leakage.
- Wipe off any drained water spilled on the floor.

8 Check that the strainer is fitted tightly before opening the tap

9 Press the maintenance cover onto the front cover and close to the original state then attach with urea screws (two screws)

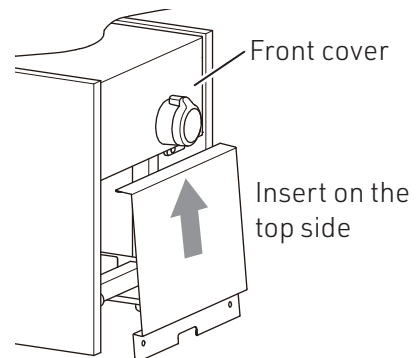
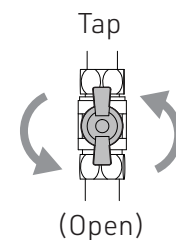
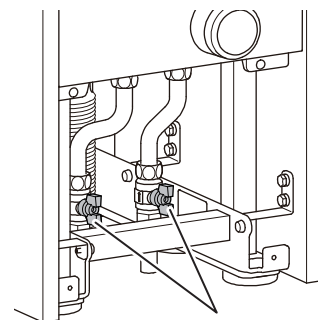
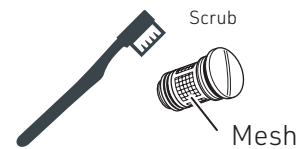
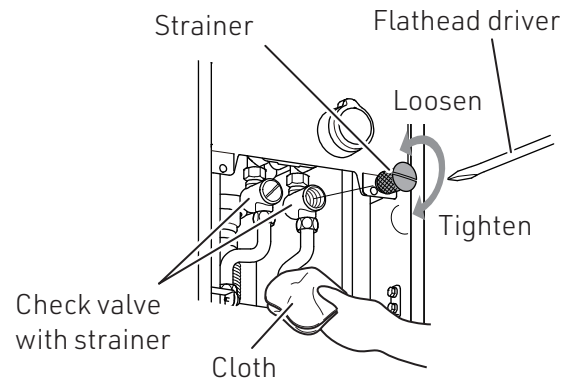

<Water leakage inspection>

Check the following every week (approximately):

- Open the maintenance cover and check for water spilled onto the floor
- Check for water spilled around the maintenance cover and side panel

If water leakage has occurred, contact your local Takara Belmont dealer because the pipe inside may be damaged.

Troubleshooting

If any of the following problems occur, perform checks before requesting repairs. If the device does not operate correctly after implementing the following measures, discontinue use immediately and contact your local Takara Belmont dealer.

Problem	Items to check	Measures to implement
Failure to output hot or cold water	Is the water pipe tap open? [Page 33]	Open the tap. [Page 33]
Sound can be heard when hot or cold water is released	Does the sound change when the amount of hot water is adjusted by turning the tap?	Adjust the amount of water to be used. [Page 15]
	Does the sound stop when the hot and cold water is output with the foaming water outlet removed [page 29]?	Clean the foaming water outlet and remove scales and other stains. [Page 29]
The water is lukewarm	Is the temperature on the hot water supply unit appropriately set?	Adjust the temperature on the hot water supply unit appropriately.
	Is the temperature set appropriately with the thermostatic control knob?	Adjust the temperature appropriately with the thermostatic control knob. [Page 16]
Poor water drainage	Is the hair catcher clogged with hair?	Remove the hair caught in the hair catcher. [Page 27]
The cover of the shower head holder fell off		Attach the cover as shown in "Attaching the cover on the shower head holder" [page 12]. If the cover of the shower head holder falls off easily, it should be replaced. Contact your local Takara Belmont dealer.
Squeaking sound is heard when moving the shower hose	Is the sponge in "Removing the cover on the shower head holder" [page 12] coming out of the net?	If the sponge has come out of the net, ensure that this fits inside the net. If the sound is heard when the sponge is inside the net, the sponge should be replaced. Be sure to replace the sponge. [Page 12]
	Is the surface of the shower hose stained? (Sound is generated by friction between the cover on the shower head holder and the shower hose.)	If the sound is not improved after cleaning the stain on the surface of the shower hose with a wet towel, the shower hose should be replaced. Contact your local Takara Belmont dealer.

Daily Inspection

The following inspection should be performed for safe use of the product.



WARNING

Daily inspections must be performed according to the details shown below. Use without performing daily inspections may lead to injury and damage to the product, accessories, and facilities.

Daily inspection items

Inspection item	Inspection method	Inspection result and action to take in case of failure
Is the basin or arm loose?	Hold the edge of the basin with two hands and push or shake gently in all directions to check that it is not loose.	This may lead to operation defect or damage to the device or accidental falls. Discontinue use and contact your local Takara Belmont dealer.
Is hot or cold water outputted correctly from the shower head?	Release hot or cold water to visually check that the water is outputted correctly from the shower head, if there is any leakage from the connecting section between the shower head plate and the main unit of the shower head or between the main unit of the shower head and the shower hose, and if there is any clouding in the hot or cold water.	If water is leaking from the connecting section between the shower head plate and the main unit of the shower head or between the main unit of the shower head and the shower hose, the gaskets inside may be worn out. Contact your local Takara Belmont dealer because this may lead to water leakage accidents.
		If hot or cold water is not output correctly or is cloudy, the strainer of the catch valve may be stained. Clean the strainer because this may cause defect in water output. [See pages 32 and 33]
		If a few streams of shower water are coming outside, the shower head plate may be clogged with scales and rubbish. Remove and clean the shower head plate. [See page 29]
Is the thermostatic control knob operating correctly?	Turn the thermostatic control knob and check that temperature is adjusted correctly and if there is any foreign sound. *The sound of water flowing may be heard as a foreign sound due to the release of water. [See page 15]	If the temperature is not adjusted correctly or if there is any foreign sound, there may be abnormalities in the thermo parts. Discontinue use immediately and contact your local Takara Belmont dealer because boiling water may be output and cause burns.
Is the plating on the tap or the thermostatic control knob peeled off?	Visually check the appearance of the tap and the thermostatic control knob for any scratches, cracks, and peeling on the plated surface.	Scratches, cracks, or peeling on the plated surface may cause hand injury. Contact your local Takara Belmont dealer to have these replaced.
	Check for any catches or foreign sensation during operation and maintenance.	
Is the tap operating correctly?	Turn the tap and check that hot and cold water is output correctly and if there is any foreign sound. Also, close the tap to check that the hot and cold water stops fully. *The sound of water flowing may be heard as a foreign sound due to the release of water. [See page 15]	If a foreign sound is heard or if hot or cold water does not stop when the tap is fully closed, a tap defect may be present. Close the taps on the cold and hot water pipes immediately [see page 32], discontinue use, and contact your local Takara Belmont dealer because this may result in water leakage accident.

Daily Inspection

Inspection item	Inspection method	Inspection result and action to take in case of failure
Can the basin be filled with water?	Close the drainage with drain cap and fill with water to see if any water leaks out.	If the water in the basin is drained rapidly, the gasket of the drain cap may be deteriorated. Drain cap should be considered consumable goods. Be sure to replace this immediately. [See page 28]
Is the mohair tape deteriorated?	Check the mohair tape for peeling, significant staining, and deterioration	Replace the accessory mohair tape according to the attached operating instructions for mohair tape. Contact your local Takara Belmont dealer if the movement of the shower hose is not smooth after replacement of the mohair tape.
Are the areas other than the inside of the basin wet with water or chemicals?	Check that the areas other than the inside of the basin are not wet with water or chemicals.	This may cause device malfunction or difficulty in removing stains. Be sure to immediately wipe off any water or chemicals adhered to the areas other than the inside of the basin.
Is there a foreign odor in the basin drainage?	Check for any foreign odor in the basin drainage.	Remove any hair accumulated in the hair catcher. [See page 27]
Is the floor around the maintenance cover and the side panel wet with water?	Visually check the floor around the maintenance cover and the side panel for any spilled water.	Water leakage may be present inside the device. Open the maintenance cover and check the inside. [See page 32] If the water is leaking from the pipes, close the taps on the cold and hot water pipes immediately [See page 32], discontinue use, and contact your local Takara Belmont dealer.
Is the neck cushion and head pillow deteriorated?	Check for any tears, stains, and collapsing on the surface of the neck cushion and head pillow.	This may cause pain or stains on the customer's neck and head. Neck cushions and head pillows should be considered consumable goods. Contact your local Takara Belmont dealer to replace this immediately.
Is there a foreign odor in the shower head holder?	Check for any foreign odor in the shower head holder.	If the odor remains after cleaning the sponge, the sponge should be replaced. Be sure to replace this immediately. [Page 30]

Be sure to inspect the following items after finishing work every day

Inspection item	Inspection method	Inspection result and action to take in case of failure
Is the drainage blocked?	Check that the drainage is blocked with drain cap, towel, or hairdressing gown.	Remove any objects blocking the drainage. If the drainage is blocked, accidental release of water or slight output of water due to the nighttime increase in water pressure may cause the water to spill out of the basin and lead to water leakage accidents.
Is the tap closed tightly?	Turn the tap clockwise fully to check that the water has stopped completely.	Turn the tap fully to stop the water completely. If the water is not stopped fully, there may be abnormalities in the tap. Close the taps on the cold and hot water pipes immediately [see page 32] and contact your local Takara Belmont dealer.

Daily Inspection

Items for weekly inspection

Inspection item	Inspection method	Inspection result and action to take in case of failure
Is there water leakage inside?	Remove the maintenance cover and check for water leakage in the pipes and metal faucet parts (tap and check valve with strainer) inside [see page 32].	Water leakage from the pipes may be due to wear, deterioration, or damage to the pipes and gaskets. Discontinue use immediately, close the taps on the cold and hot water pipes immediately [see page 32], and promptly contact your local Takara Belmont dealer.
Is water leaking from the drainage hose?	Remove the maintenance cover and check for water leakage from the drainage hose [see page 32].	If water is leaking from the drainage hose, the drainage hose may be damaged. Discontinue use immediately and contact your local Takara Belmont dealer.
Are scales or stains accumulating in the foaming water outlet or the shower head plate?	Remove the shower head plate and check for any stains and scales [see page 29].	Clean and remove any stains, including scales, using toothbrush or similar material. If this is left uncleaned, the shower water may not be output correctly due to clogging.

Parts for Regular Replacement

The following parts are designated by Takara Belmont for regular replacement.

☐ Drainage hose: Three years

- Drainage hose may be cracked due to deterioration and hardening caused by chemicals in the drain water and result in water leakage.
- Damage to the drainage hose may cause spillage of water on and under the floor.

☐ Check valve: Three years

- Prolonged use of the check valve may lead to failure in water output due to deterioration of the inside parts, or in some cases may result in regurgitation of wastewater after output, causing contamination of tap water or issues in public health.

☐ Cold or hot water hose: Three years

- Cold or hot water hose may be cracked due to deterioration caused by device operation or the residual chlorine and copper ions in the tap water and result in water leakage.
- Damage to the cold or hot water hose may cause spillage of water on and under the floor.

These parts are for regular replacement, which require periodic replacement for safety and maintenance of performance. The parts should be replaced after the designated replacement period even if they do not cause problems in use. We will not be held liable for harm, damage, and defects caused by the failure to replace these parts within the designated period. Contact your local Takara Belmont dealer for the replacement operation.

Standard Period of Use

- The standard period of use for this product is seven years.
- Standard period of use is defined as a guideline for the standard period of using the product without any problems in safety under standard conditions of product use with appropriate maintenance and inspection (including replacement of parts) performed.
Please be advised that this is not an indication of the guarantee period. The standard period will differ depending on the environment and frequency in which you use the product. Please contact your local Takara Belmont dealer for maintenance after completion of the standard period of use.

Consumable Goods

"Consumable goods" shall refer to the following parts that are expected to undergo wear, deterioration, changes in appearance, and damage with use. Please be advised that the repair and replacement of consumable goods are not covered under the guarantee and will incur a charge.

(*Degree and timing of wear, deterioration, and damage varies depending on the environment and conditions under which the product is used.)

In the case of significant wear and deterioration or damage, inspection or replacement of the parts will be necessary. Please contact your local Takara Belmont dealer immediately.

Consumable goods (the following items are not covered under the guarantee and incur a charge)

- Neck cushion ◦ Head pillow ◦ Drain cap ◦ Hair catcher
- Cover of the shower head holder ◦ Sponge ◦ Mohair tape ◦ Rubber gaskets
- Shower hose ◦ Foaming water outlet, rubber gasket, and O ring inside the shower head
- Lubricants (oil, grease, etc.)

Also, scratches, stains, deterioration, and discoloration on the outer surface of the following exterior parts are not covered under the guarantee.

- ☐ Drainage hose: Three years
 - Covers, frames, basin, wooden parts
 - Taps (water tap, thermostatic control knob, etc.)
 - Others (shower head, shower head holder, etc.)
 - Metal parts, such as dowels and screws

When Disposing of the Product

When disposing of the product or replaced parts, waste should be processed appropriately according to current laws and regulations in your country.

Specifications

Model number	Basin (L specification): AY-YMW*L Basin (H specification): AY-YMW*H
Outer dimension	Refer to the Product Dimension Diagram [pages 40]
Range of motion of the rotating arms	-47° to 47°
Range of motion of the basin	-100° to 100°
Neck height	Basin (L specification): 800 mm Basin (H specification): 900 mm
Mixing method	Thermostat method
Water output method/volume	Shower mode: About 8.0 L/min Foaming mode: About 7.0 L/min
Tap	Single tap (handle type)
Environment of use	Operating temperature: 10°C to 30°C Operating humidity: 90% or lower (without condensation)
Transport/storage environment temperature	Temperature: -20°C to 70°C Humidity: 95% or lower (without condensation)
Hot water supply temperature	80°C or lower
Weight	AY-YMW*L: 63 kg AY-YMW*H: 66 kg

* The dimensions shown above will vary slightly between products.

Product Dimension Diagram

[Unit : mm]

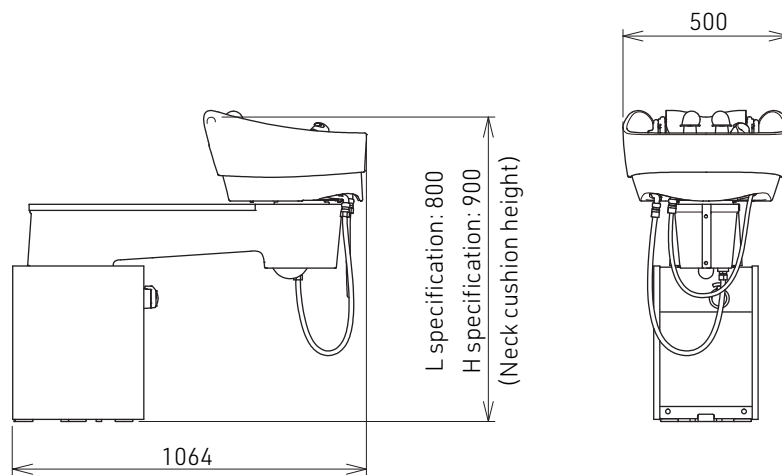
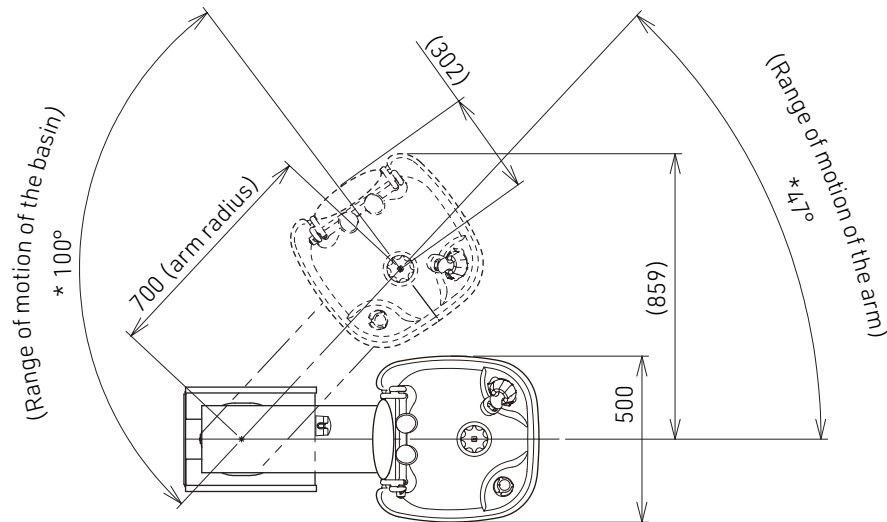

Dimensions marked with an asterisk (*) can be moved to the same angle in the other direction.

TAKARA BELMONT
TAKARA BELMONT CORPORATION
1-1, 2-Chome, Higashi-shinsaibashi, Chuo-ku, Osaka, Japan
TEL : +81-6-6213-5945 FAX : +81-6-6212-3680
Printed in Japan