

# EXCELA Installation Instructions

## ■ EXCELA

- Basin unit
  - P1-EX\*\* [1 Tap Type]
  - PT-EX\*\* [Thermostat Type]
- Cabinet
  - KF-EX\*S\*\* [S size]
  - KF-EX\*\*\* [Others]
- Platform
  - KF-EX\*

- Option

  - Side Panel  
KF-EXSP\*\*
  - Mirror  
KF-EXM800
  - Auto Neck Cushion  
KF-NC

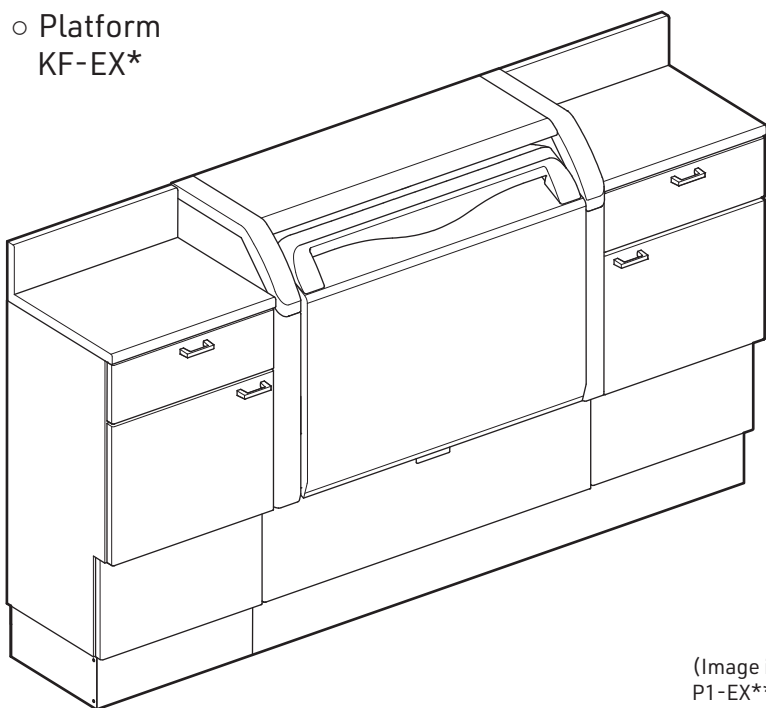

## Contents

Before Installation	2
Name of Parts	4
Usage conditions	7
EXCELA packing	8
Carrying the basin unit	9
Installation of main body	9
1 Install the platform	10
2 Install the cabinet (left (wall side))	11
3 Install the basin unit (first)	12
4 Install the cabinet (center)	13
5 Install the basin unit (second)	14
6 Install the cabinet (right)	14
7 Fix basin unit and cabinet to wall	15
8 Attach piping	16
9 Checks after installation of pipes	17
10 Adjust and remove/attach door	18
After installation	19
11 Caulking	19
Attach optional parts	20

(Image is of 1 set of  
P1-EX\*\*/KF-EX3S\*R/KF-EX3S\*L/KF-EX380/KF-EX1200 )

### To the installer:

- The instructions should be thoroughly read and understood before installation to ensure that EXCELA is installed correctly.
- After installation, give this instructions to the customer.

### To the customers:

- Customers must not install EXCELA by themselves.
- Customer must store these instructions in a safe place so as not to lose them.

\*The actual shape of EXCELA and the images and dimensions listed in these instructions may be modified and are subject to change without notice.

- The precautions listed here are to ensure that EXCELA can be installed safely, and to prevent any danger or risk to the person installing EXCELA or those around them. All of these precautions are important for safety. Takara Belmont is not responsible for any damage or risk to the person installing EXCELA or those around them due to accidents if EXCELA is install without adhering to the precautions.



### Caution :

If EXCELA is installed after ignoring this symbol, "there is the risk of light or moderate injury or physical damage".

# Before Installation

## Overall layout diagram

### <Dimensional drawing>

Basin unit: P1-EX\*\*

Cabinet: KF-EX3S\*R [3 door cabinet, right side]

Cabinet: KF-EX3S\*L [3 door cabinet, left side]

Platform: KF-EX380, KF-EX1200

Mirror side panel: KF-EXSP\*580 (Option)

Mirror: KF-EXM800 (Option)

### ■Top view

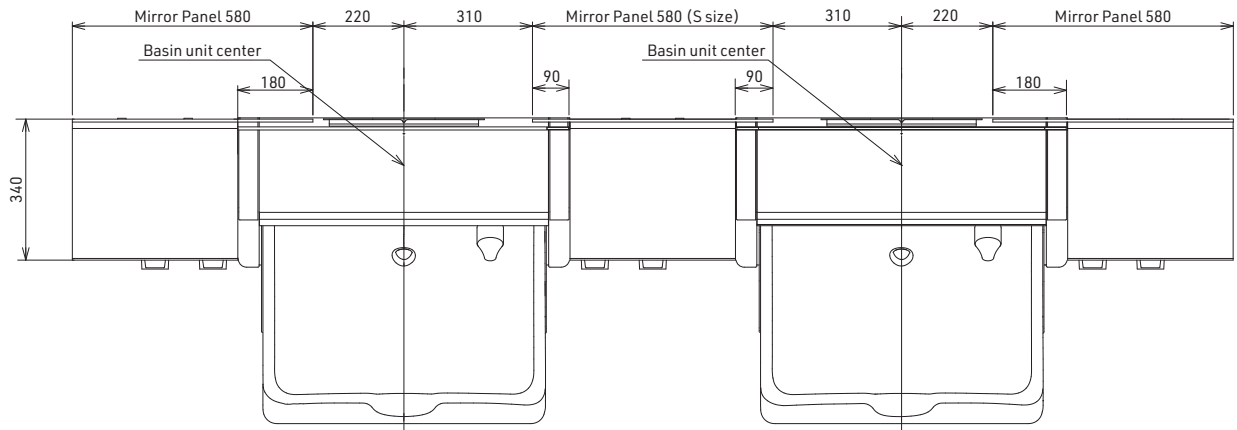

### ■Elevation view

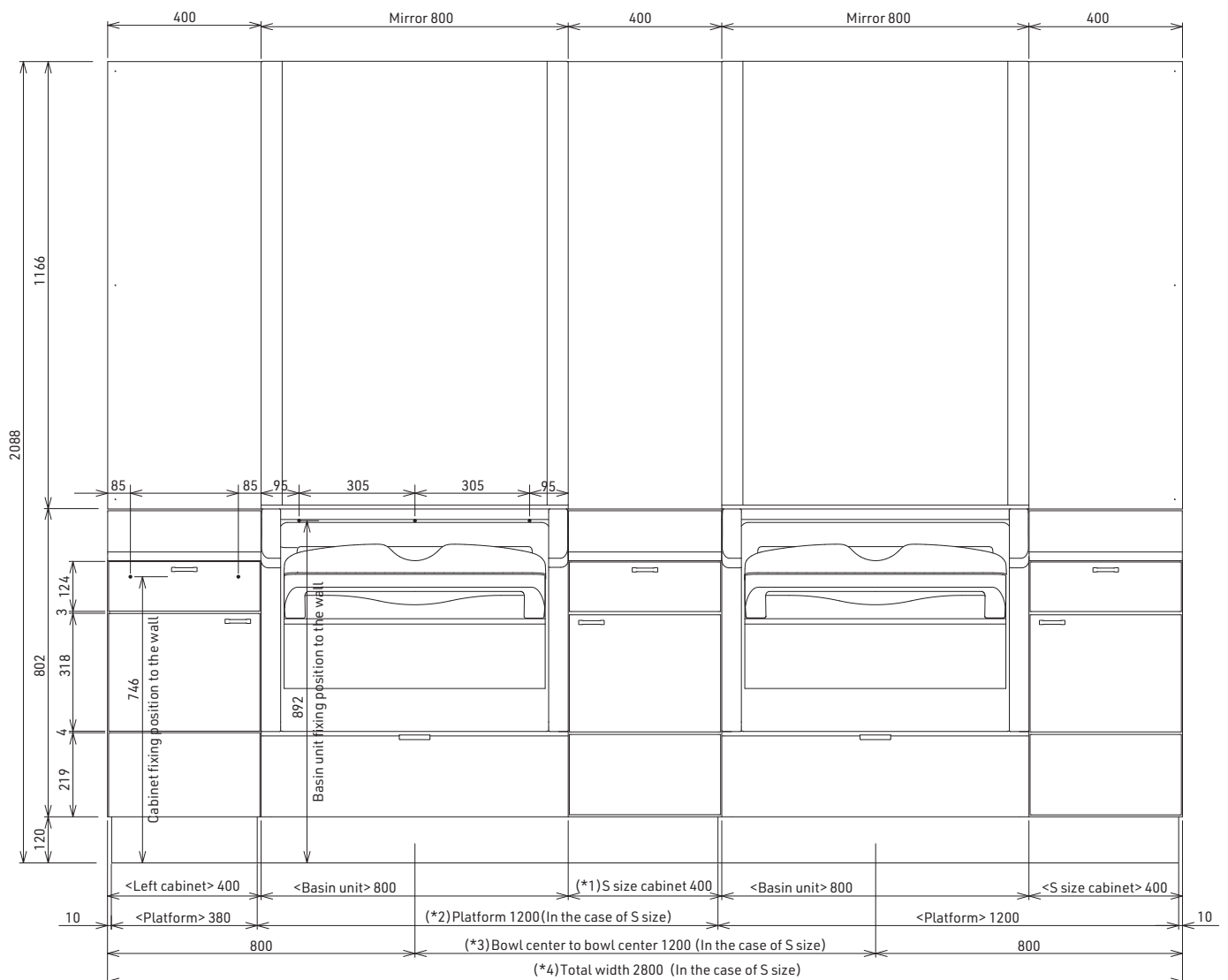

## ■Side view

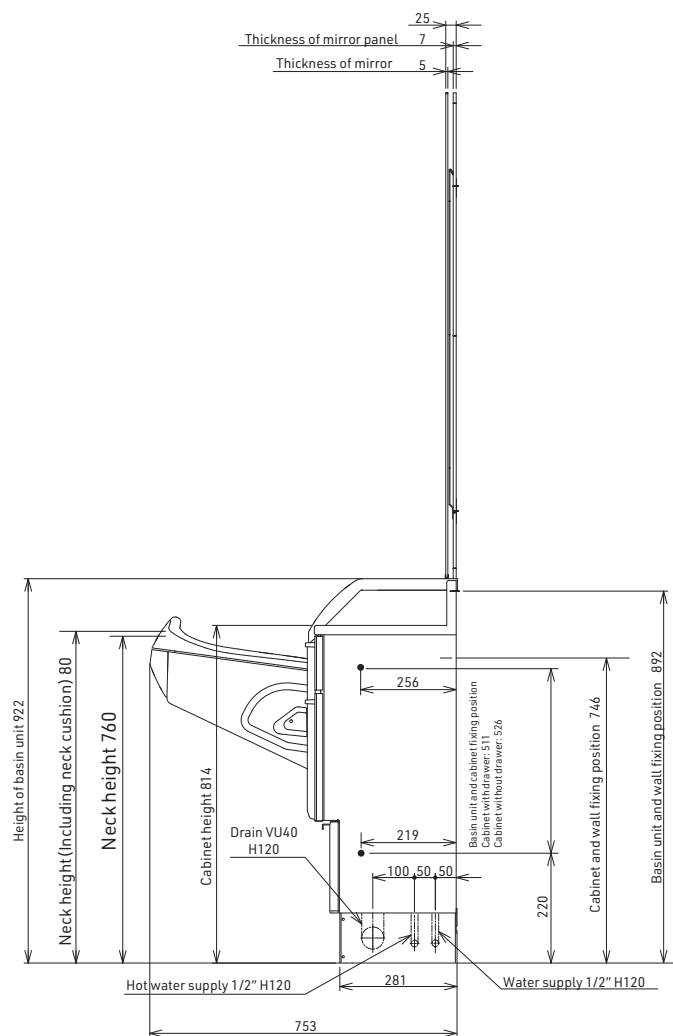

## <Parts Components>

Chart		Basin unit single use	1 set	2 sets				3 sets				4 sets				5 sets			
			S	S	450	L	LL	S	450	L	LL	S	450	L	LL	S	450	L	LL
EXCELA basin unit		1	1	2	2	2	2	3	3	3	3	4	4	4	4	5	5	5	5
Cabinet	Left 400mm		1	1	1	1	1	1	1	1	1	1	1	1	1	1	1	1	1
	S size 400mm		1	2	1	1	1	3	1	1	1	4	1	1	1	5	1	1	1
	450 size 450mm				1			2				3				4			
	L size 500mm					1			2				3				4		
	LL size 650mm						1			2				3					4
Platform	Left 380mm		1	1	1	1	1	1	1	1	1	1	1	1	1	1	1	1	1
	S platform 1200mm		1	2	1	1	1	3	1	1	1	4	1	1	1	5	1	1	1
	450 size 1250mm				1			2				3				4			
	L platform 1300mm					1			2				3				4		
	LL platform 1450mm						1			2				3					4
	Platform single use 780mm	1																	
Total width (mm)		800	1600	2800	2850	2900	3050	4000	4100	4200	4500	5200	5350	5500	5950	6400	6600	6800	7400

- Small difference of measurement shown in the left side instruction may occur.
- PT-EX\*\* has the same dimensions as shown in the external dimensional drawing.
- Outer measurement alters due to the selected cabinet spec. (S size, 450 size, L size, LL size).

	S size	450 size	L size	LL size
1: Cabinet	400	450	500	650
2: Platform	1200	1250	1300	1450
3: Bowl center to bowl center	1200	1250	1300	1450
4: Total width	2800	2850	2900	3050

\*The total width may vary slightly from model to model. Ensure that there is space between main unit and side wall, specially when installing EXCELA to the wall at both ends.

# Name of Parts

## ■ Main Unit

< 1 tap type (Picture shows 1 set) >

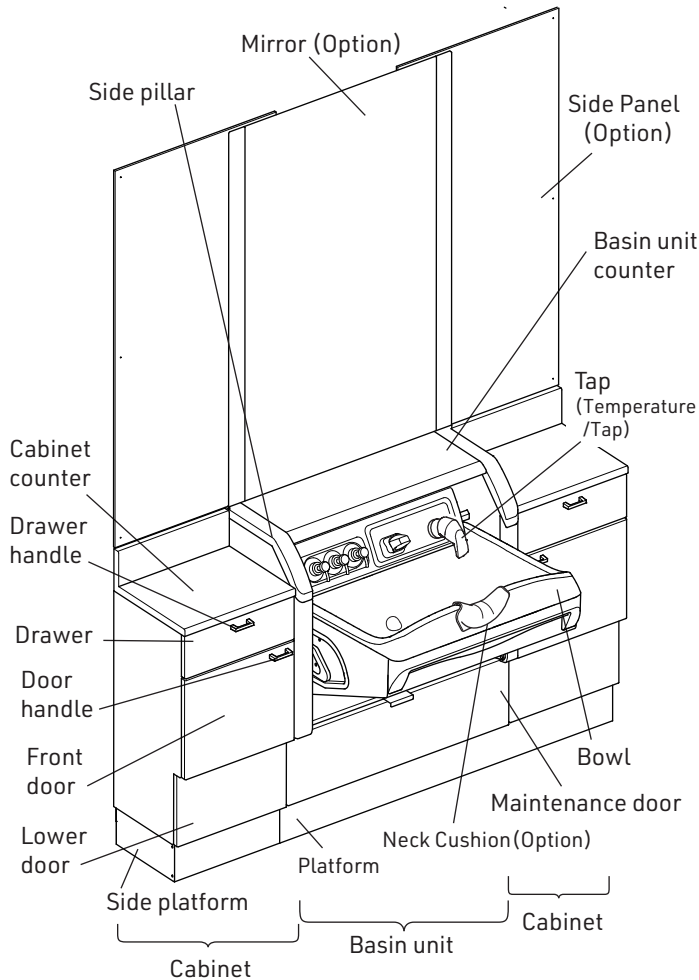

< Thermostat Type (Picture shows 1 set) >

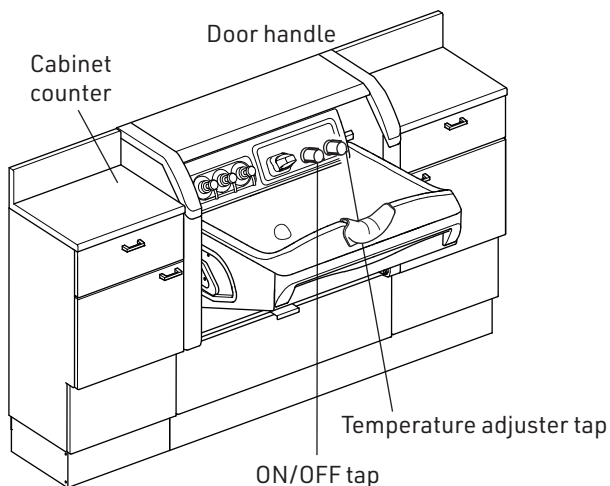

Neck height	Including Neck cushion
760	780

Neck height may vary slightly from model to model. Height of neck cushion is as of attaching Neck Cushion (Option) on the shampoo bowl neck part.

## ■ Bowl

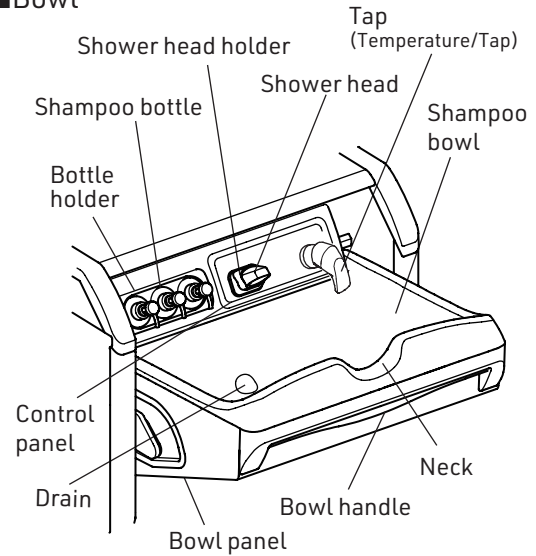

## ■ Inside of basin unit <1 tap type>

Lower part of bowl panel and inside of maintenance door

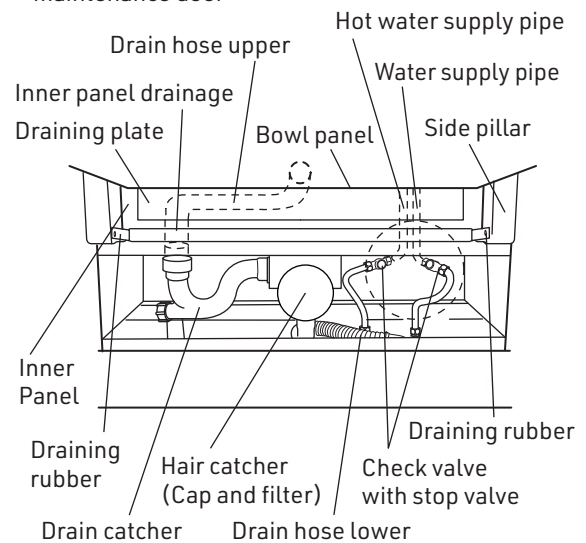

## ■ Inside of basin unit <Thermostat type>

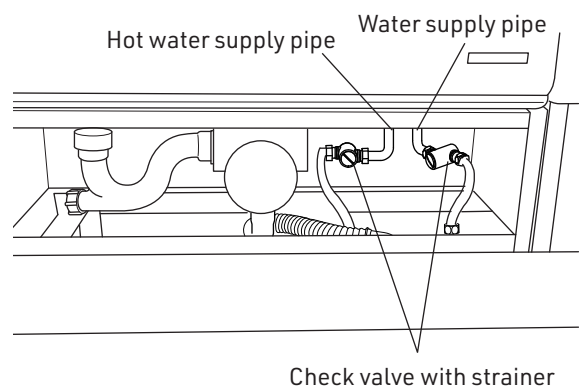

## < Piping diagram >

### ■Top view

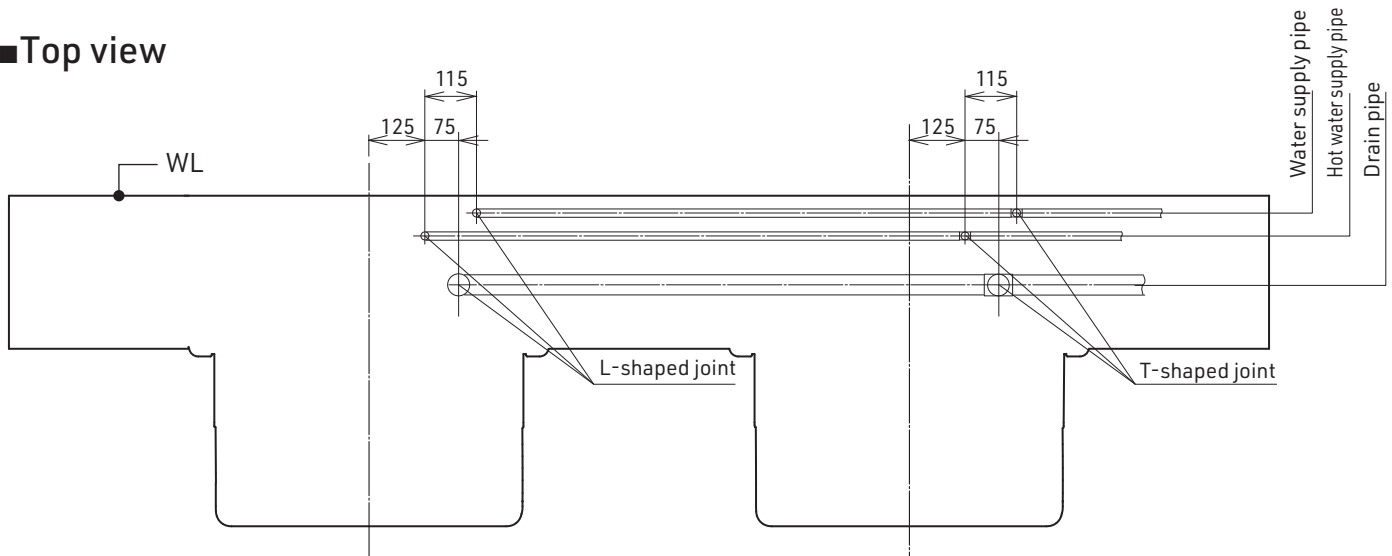

### ■Front view

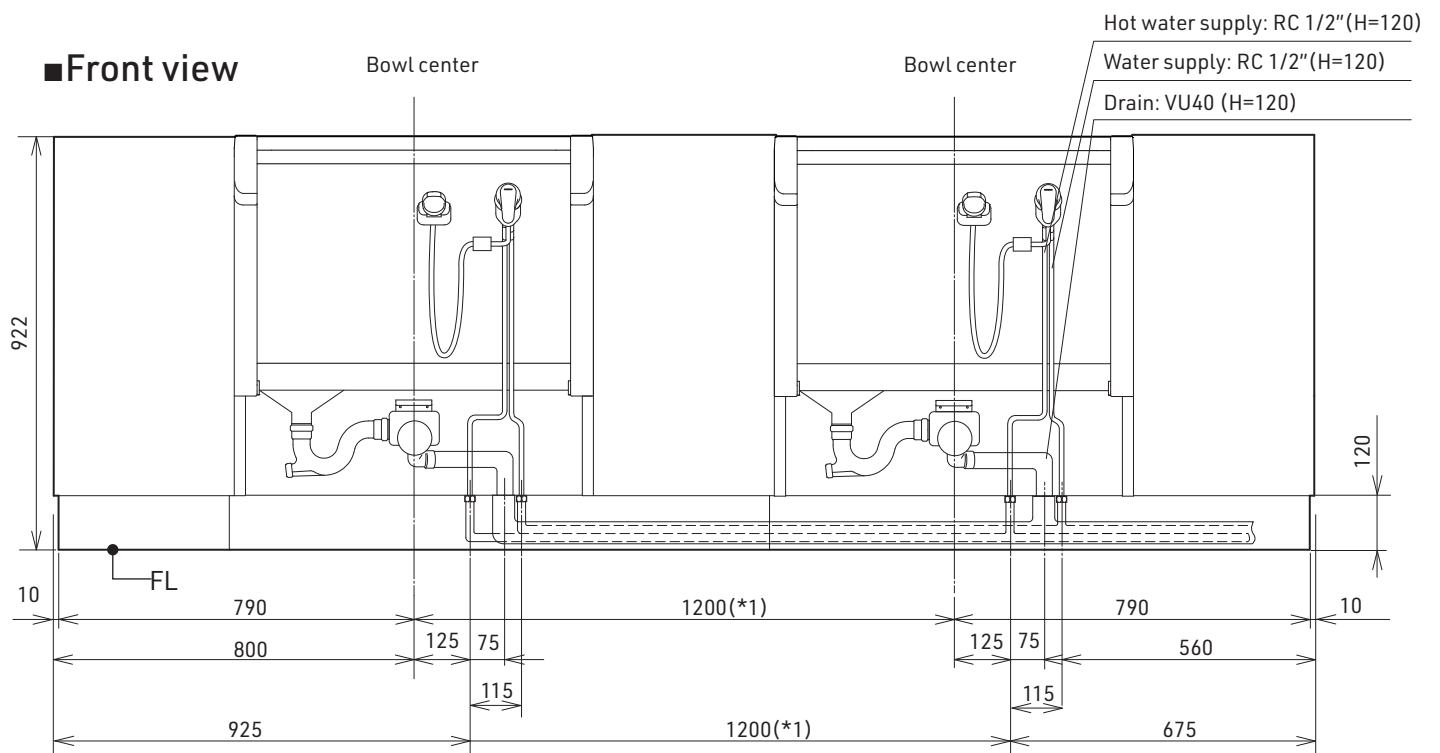

### ■Side view

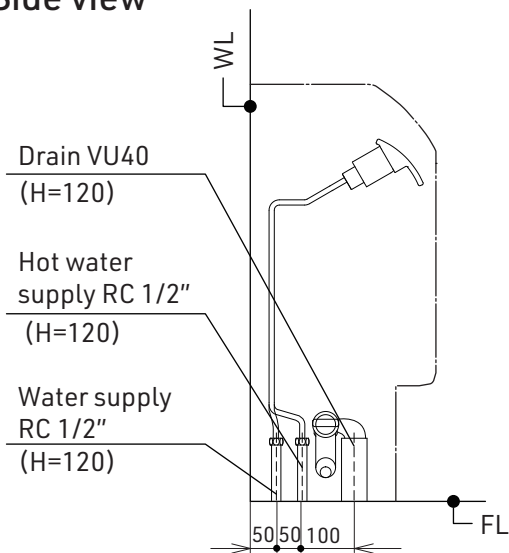

\*Dimension differs from spec. of cabinet (S size, 450 size, L size, LL size).

	S size	450 size	L size	LL size
*1	1200	1250	1300	1450

<Height from floor>

Water supply pipe	H=120
Hot water supply pipe	H=120
Drain pipe	H=120

## ■ Floor surface

- Ensure that the material or finishing of the floor surface is waterproof or has a waterproof coating applied.
- Always ensure that the floor surface is horizontally level.
- Ensure that the floor surface is smooth and free from bumps around the attachment areas.
- Installing pipes

Hot water supply, water supply	RC 1/2" Height from floor	Hot water supply; 120mm, Water supply: 120mm
Drain	VU40 Height from floor	120mm

- The following levels of strength are required for the floor surface.

Wooden floor	Plywood thickness of 30 mm or more (two 15 mm sheets joined together)
Mortar floor	Mortar thickness of 50 mm or more
Special floor (stone finish)	A foundation with levels of strength listed above around the installation areas is required.

## ■ Wall mounting

- The level of strength of plywood thickness of 12 mm or more is required for the wall base for mounting the unit. In the case of plaster board or plywood thickness of less than 12 mm, reinforce by wooden board or bar. (Refer to page 2 and 3.)
- Use waterproof material like melamine for wall surface to avoid wall damage during shampooing.

## ■ Preventing water leakage

- If this product is to be installed upstairs, ensure that the installation area has been coated with waterproof materials (water proof finish, installation of a stainless steel pan or a water leakage sensor).

## ■ Installation of pipes

The following are important points to adhere to during the installation of pipes.  
Read through the details carefully and ensure that the pipes are installed correctly.

- When installing this product, ensure that installation of pipes adheres to the instructions outlined in "Precautions during installation of pipes". Installing pipes without reading through the precautions will mean water may not mix properly, and a set temperature will not be achieved.
- This product is designed for indoor installation. Always install this product indoors.

## ■ Precautions during installation of pipes

- Do not use pipes made of materials that may introduce rust for the water supply pipe.  
In general, VU40/VP40 pipes or other materials specified by regulations in that particular region, are recommended for installation.
- In general, Type L deoxidized copper pipes are recommended for hot water pipes.
- In general, the same diameter and same pressure is recommended for hot water pipes and water supply pipes.
- Always use a reamer to deburr the ends of cut pipes.
- Avoid using inverted U-shaped pipes (siphon) as these can cause air to become trapped.
- Always connect hot water pipes and water supply pipes after removing all contaminants such as dirt, sand and oil as these can cause problems.
- After connecting the pipes and testing water flow, clean the filter and shower head.
- Ensure that the drain pipe is installed at a gradient of 1/50 for a diameter of  $\phi 75$  or less, or 1/100 for a diameter of  $\phi 75$  or more.
- Do not connect the hot water pipes and water supply pipes in reverse.  
Connecting pipes in reverse will mean the temperature of water cannot be controlled properly by the water taps, which can cause problems including burns.
- Ensure that the hot water pipes from water boilers are only run over a short distance so as to minimize resistance.  
Longer pipes can cause fluctuations in temperature and poor hot water delivery.
- Always wrap pipes with lagging material after installation is complete.
- Water boiler pipes
  - In general, the same diameter and same pressure is recommended for main hot water pipes and main water supply pipes.
- Equipment comes with hair catchers installed.

# Usage conditions

## ■ Hot water supply and water supply conditions

Water used	<ul style="list-style-type: none"><li>● Public water supply (do not use non-drinkable well water or water that contains rust or sand.)</li><li>● If the water hardness is 80 ppm or higher, install a water softener to prevent the buildup of scale within the basin body. Aeration may be minimal when using shampoo even if drinkable well water is used, so a water softener should be installed.</li></ul>
Hot water supply, water supply pressure	<ul style="list-style-type: none"><li>● Use a pressure set between 0.1 to 0.4 MPa (1 to 4 kgf/cm<sup>2</sup>). If multiple EXCELA are used, ensure that the pressure does not drop below 0.1 MPa (1 kgf/cm<sup>2</sup>).</li><li>● Set the water supply pressure <math>\geq</math> hot water supply pressure.</li><li>● Set the difference between the hot water supply pressure and water supply pressure to be within 0.2 MPa (2 kgf/cm<sup>2</sup>).</li></ul>
Hot water temperature into the product	<ul style="list-style-type: none"><li>● Set the hot water temperature to 60°C or less.</li><li>● Set the temperature 10°C or higher than the shower temperature used.</li></ul>
Water boiler	<ul style="list-style-type: none"><li>● Do not use steam with the hot water supply.</li></ul>

# EXCELA packing

## < Basin unit >

### ■ Content of packaging

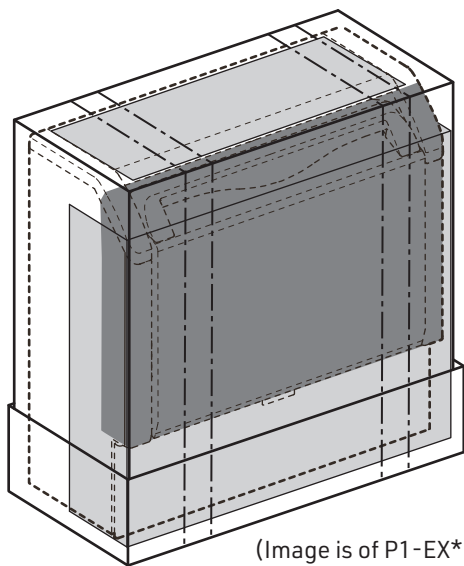

(Image is of P1-EX\*\*)

### ■ Accessories

□ Bottles (3)

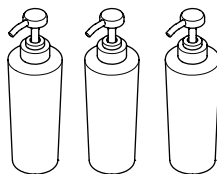

□ Operating manual, installation manual (this document)

□ Basin unit wall fixing screw set



□ Nozzle for replacement (3)



□ Flexible pipe

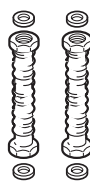

(L=200, 2pcs.)

□ Nozzle packing (3)



□ Nipple (2)  
(1 tap type)



□ Stop valve(2)  
(Thermostatic type)

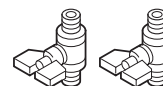

## < Platform >

### ■ Content of packaging

(KF-EX1200, KF-EX1250, KF-EX1300, KF-EX1450)

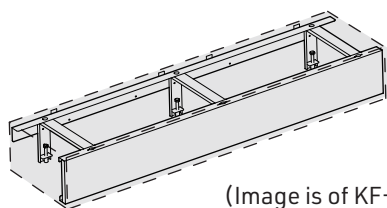

(Image is of KF-EX1200)

### ■ Accessories

□ Connection board  
(2 pcs.)

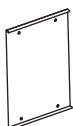

□ Connection board fixing screw set



(KF-EX380)

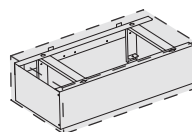

□ Side board

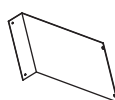

□ Side board fixing screw set



□ Concealing board



(KF-EX780)

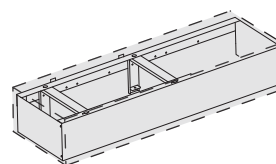

\*No accessory.

## < Cabinet >

### ■ Content of packaging

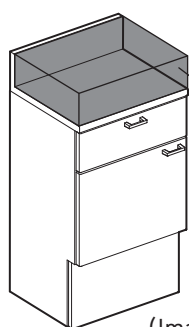

(Image of KF-EX3S\*L)

\*Rack contained in the carton box.

### ■ Accessories

□ Fixing screw set  
(1) Cabinet to wall  
(2) Cabinet to basin unit



### < Option (Supplied separately) >

□ Side panel (KF-EXSP\*\*) □ Mirror (KF-EXM800)

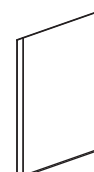
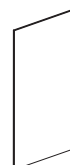

□ Auto neck cushion (KF-NC)

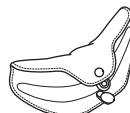



# Carrying the basin unit

## ■ Carrying the platform

- Recommend to carry platform by 2 people as it is wide.



### Caution

The platform is made of steel, so dragging it may damage the floor surface. Or strong shock may cause damage to the platform.

## ■ Carrying the basin unit

(Hold the basin unit back side handle and the bowl handle and carry the basin unit.)

- Do not take off the protective tape before carrying the basin unit.
- Always have two at least people to carry the basin unit. (see image on right)



### Caution

- Take care when handling the basin unit as it is heavy and fragile.
- Do not drag the unit. It may damage the floor surface.
- The basin unit may become damaged if scratched by metallic objects such as watches or belt buckle(fixture) . Remove all metallic objects such as watches when carrying the basin.
- Take extra care to ensure not to damage the wooden covers.
- Do not touch pipes pf the basin unit. Doing so may cause water leaks.

## ■ Carrying the cabinet

- Always have two at least people to carry the cabinet.



### Caution

- The product is made of wood, so dragging it may damage the floor surface. Or strong shock may cause damage to the cabinet.
- Do not drag cabinets. It may damage the floor surface, or strong shock may damage the cabinet.

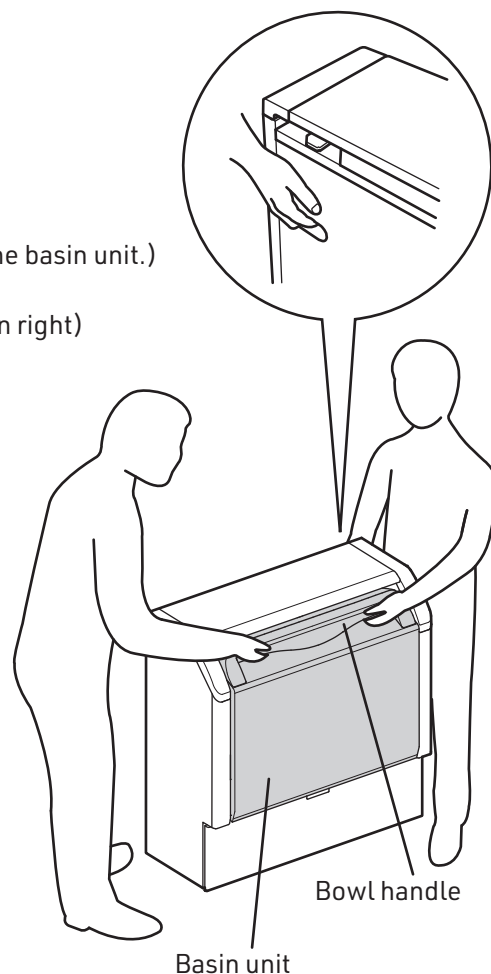

# Installation of main body

\*Always install the main body using the following procedures.

\*The basin unit, cabinets and platforms are may not be able to installed correctly depending on installation procedures of the main body.

\* [ ] part may differ from numbers of unit and spec. which will be installed.

## ■ Main body installation procedure (In the case of 2 sets)

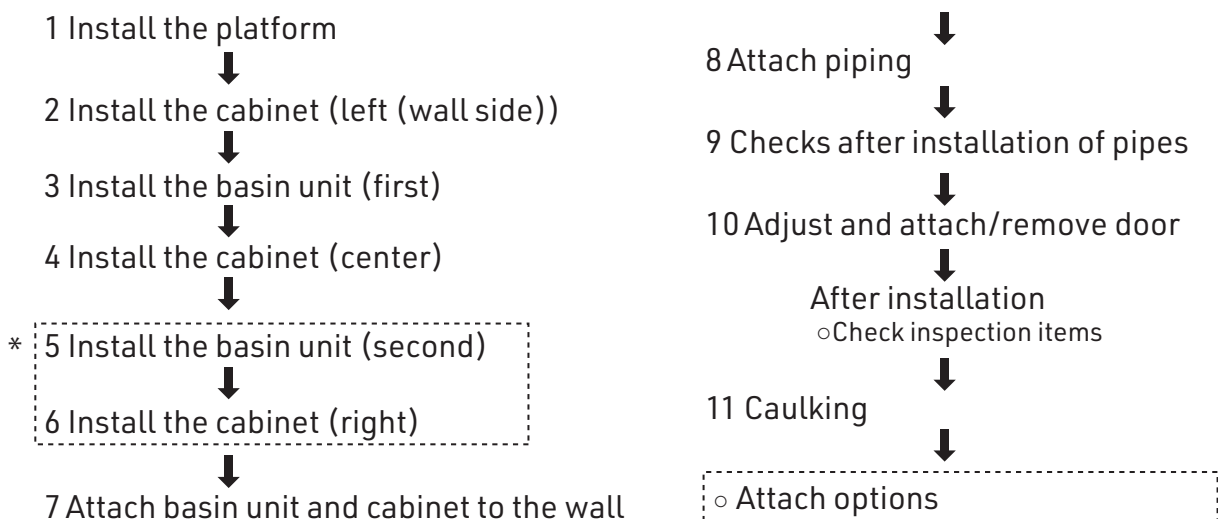

# 1 Install the platform

## 1. Install the platform

- (1) After removing protective tape on top and base part of the platform, fix the platform by connection board. Pay attention to the direction of the connection board.

2 pcs. of connection board and 6 pcs. of M4 x 10 screws to be used for each joint.

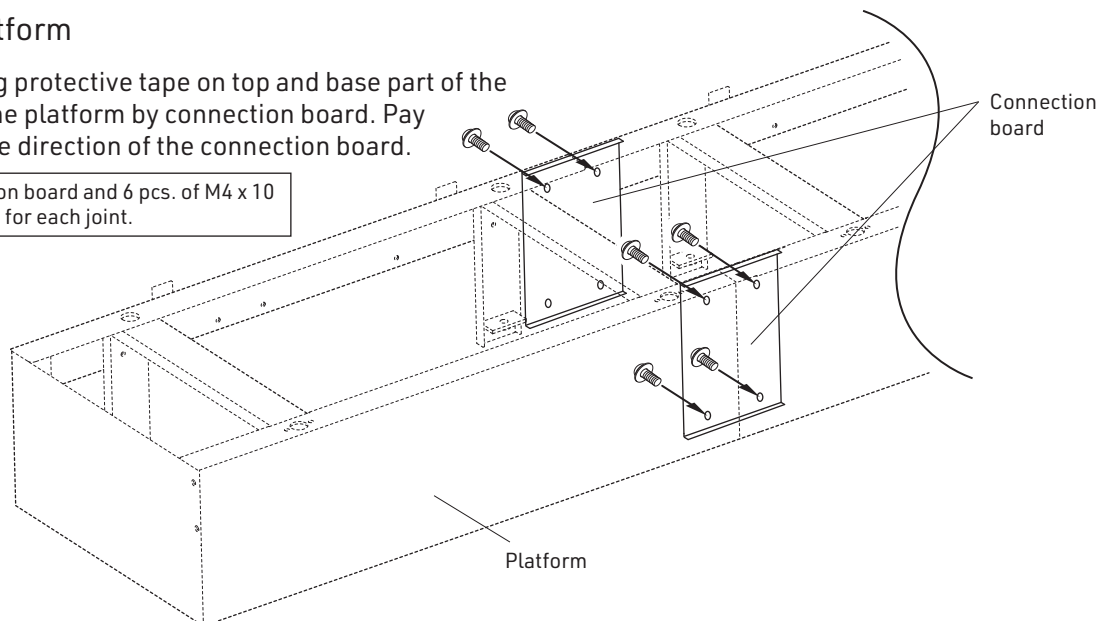

- (2) Attach platform side board to platform.

4 x 12 tapping screws : 3 pcs.

- (3) Place the connected platform and secure to the floor. Set a level as shown in the illustration. Adjust the adjuster bolts and level the platform (of front, back, left and right side).

### ⚠ Caution

- Refer the overall layout diagram (Page 2) for installing platform and install it at the correct position. Please have space at 10 mm between wall and platform.
- Do not drag platform while carrying it. It may damage floor surface and so on.

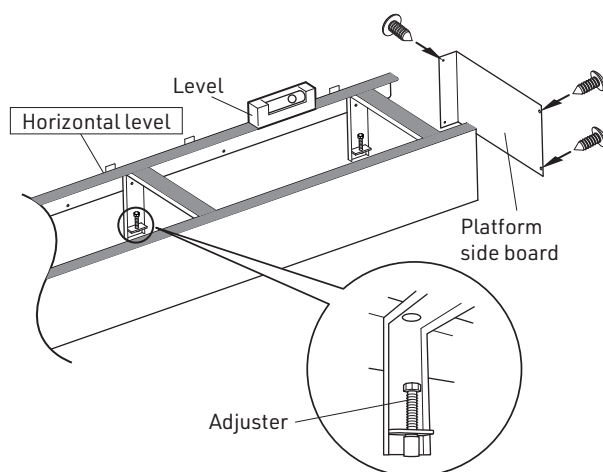

### < Attach concealing board (Option) >

#### [Concealing board]

Use to conceal the pipes when the pipes are connected from wall.

#### [Attachment]

Remove platform side board on the piping side, attach concealing board by the double-faced tape. (Refer to Operating manual of the Concealing board.)

\*The part comes with Platform 380 only.

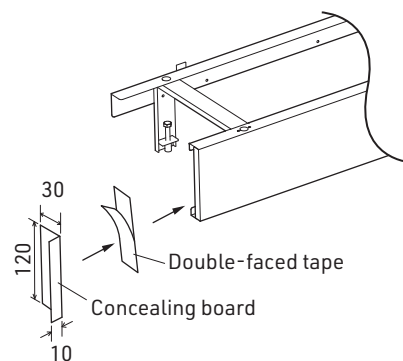

## 2 Install the cabinet (left (wall side))

### 1. Unpack the equipment

\*Check the spec. of the cabinet, if it is right or left side cabinet. To the left side, install left side cabinet.

- Always have two people to do this operation.
  - (1) Unpack the bottom part of the carton.
  - (2) Pull up the carton and remove equipment all together with air bag.



#### Caution

- Take care that drawer is dropped or cabinet may fall down when removing cabinet.
- Do not place cabinet on the floor directly before installing cabinet. It may cause breakage of electric cord by pinching between floor and cabinet, or cabinet may fall down.

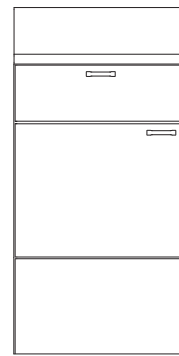

Left side

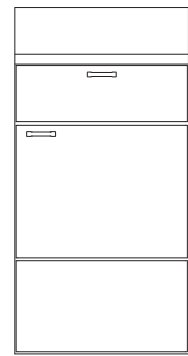

Right side

### 2. Install the cabinet

- Always have two people to do this operation.
  - (3) After removing drawer, place cabinet on platform tentatively.



#### Caution

- When carrying the cabinet, do not drag it. It may damage floor surface or cabinet.
- While this process, cabinet is not fixed firmly.  
When opening drawer or door, take care the cabinet may not fall down.
- When removing drawer, do not put drawer on the counter board. It may cause damage to the counter board. Put soft cloth or blanket on the floor and place the drawer on it.

- (4) Open the cabinet door and insert counter holders at the position where placing the counter. (Shelf dowel pin 4 pcs.)  
\*Pay attention to the direction of counter holders.
- (5) Put counter on the holders.  
\*Pay attention to the direction of counter.

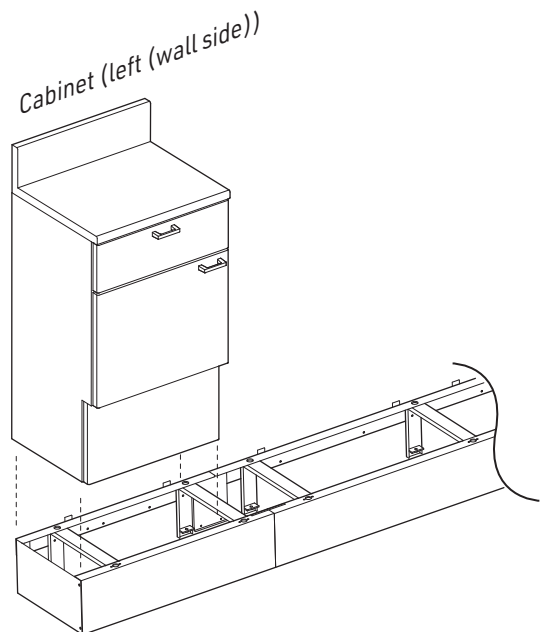

### 3 Install the basin unit (first)

#### ■ Installation

##### 1. Install the basin unit

- (1) Carry the unit by holding the basin unit back side handle and bowl handle, and place bowl unit on platform tentatively.



#### Caution

- Do not drag bowl unit when carrying basin unit. It may cause damage on the floor surface or wall.
- Basin unit is not fixed firmly, so do not open the shampoo bowl. Take care the basin unit may not fall down.

##### 2. Check the basin unit

- (2) Check the following points before fixing basin unit and cabinet.

- (A) Check if there is no big space between basin unit and cabinet.  
 (B) Check if the center of basin unit wooden frame and the center of cabinet wooden frame is at the same level.

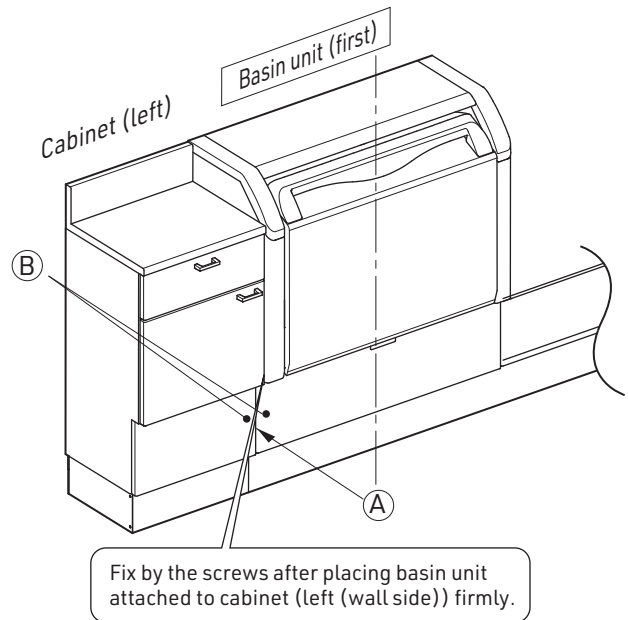

##### 3. Fix cabinet (left) with basin unit

- Always have two people to do this operation.

- (3) Remove cabinet drawer and open the door.

- (4) Fix cabinet and basin unit by screws through holes (2 holes).

\*Two pcs. of spare fixing screws are included for right and left side cabinet.

- 3.8 × 32: tapping screws 2 pcs.
- Washer (φ 5) 2 pcs.
- Cap 2 pcs.



#### Caution

Wipe wooden dust off while fixing screws.



#### Caution

Check the length of tapping screws.

When fixing cabinet and basin unit :

- 3.8 × 32: Tapping screws

When fixing basin unit and wall :

- 4.0 × 30: **Truss** tapping screws

When fixing cabinet and wall :

- 3.8 × 51: Tapping screws

(5) Attach cap on screw.

\*The cap is to conceal the screw head.

(6) Put cabinet drawer in the cabinet and close the door.

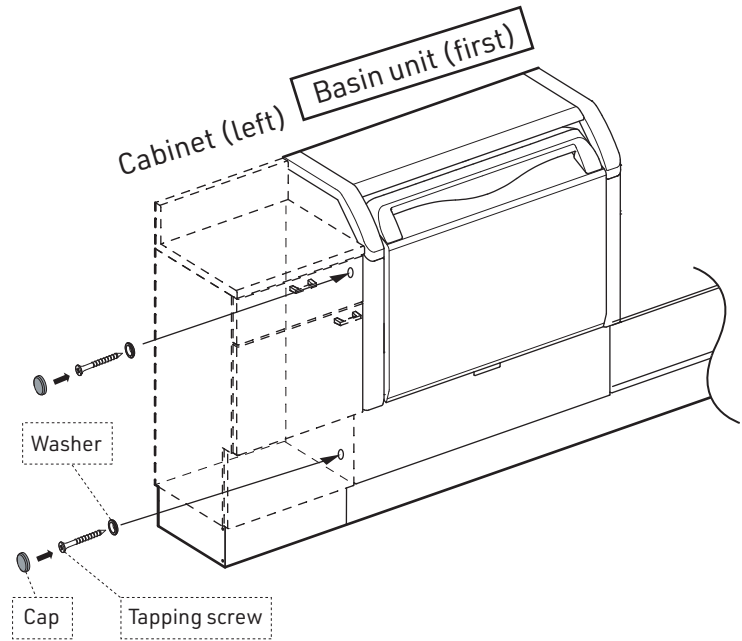

## 4 Install the cabinet (center)

### 1. Install the cabinet (center)

■ Always have two people to do this operation.

(1) After removing drawer, Hold bottom part of cabinet and place the cabinet on platform tentatively.

#### Caution

- When carrying cabinet, do not drag it. It may damage floor surface or cabinet.
- Cabinet is not fixed firmly, so pay attention that cabinet may not fall down.

### 2. Fix basin unit (first) and cabinet (center)

(2) Same as the basin unit (first) (page 12 and 13), fix cabinet (center) and basin unit (first). Fix cabinet and basin unit by screws through holes on the left side of the cabinet.

- |                            |        |
|----------------------------|--------|
| • 3.8 × 32: tapping screws | 2 pcs. |
| • Washer (φ 5)             | 2 pcs. |
| • Cap                      | 2 pcs. |

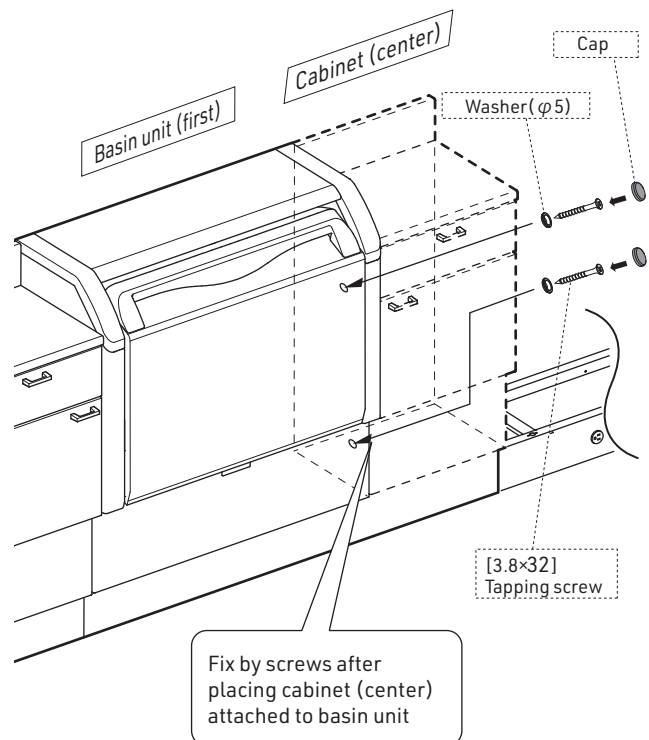

## 5 Install the basin unit (second)

### 1. Install the basin unit

- Always have two people to do this operation.

(1) Hold the basin body back side handle and the bowl handle, and carry the basin unit. And place basin unit on platform tentatively.



#### Caution

- Do not drag it while carrying basin unit. It may cause scratches on floor or basin unit, or it may cause damage to the bowl.
- Basin unit is not fixed firmly. Pay attention that basin unit is not fall down.

### 2. Fix with cabinet (center) and bowl unit(second)

(2) Same as the bowl unit (first) (page 12 and 13), fix basin unit (second) and cabinet (center). Fix cabinet and basin unit by screws through holes on the right side of the cabinet.

- |                            |        |
|----------------------------|--------|
| • 3.8 × 32: tapping screws | 2 pcs. |
| • Washer (φ 5)             | 2 pcs. |
| • Cap                      | 2 pcs. |

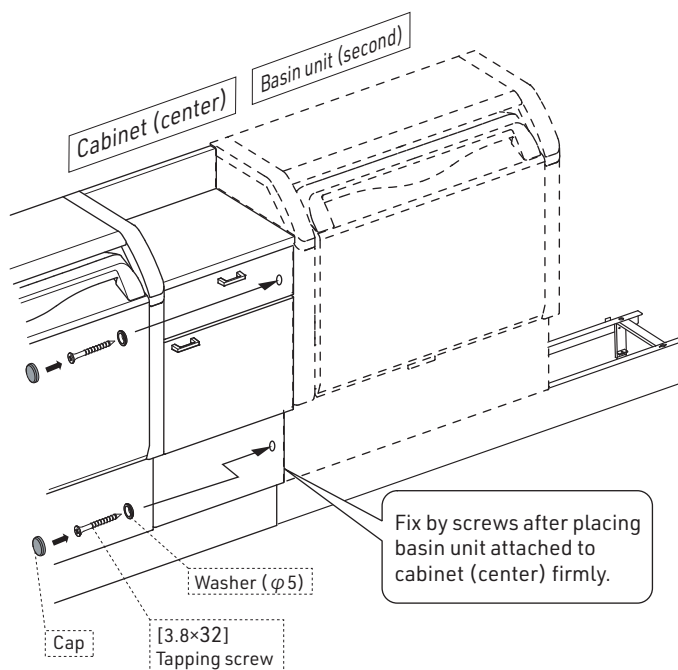

## 6 Install the cabinet (right)

### 1. Install the cabinet (right)

- Always have two people to do this operation.

(1) (In the case of 3 door type, do this operation after removing drawer.) Hold bottom part of cabinet and place it on platform tentatively.



#### Caution

- When carrying cabinet, do not drag it. It may damage floor surface and cabinet.
- Cabinet is not fixed firmly, so pay attention that cabinet may not fall down.

### 2. Fix basin unit (second) and cabinet (right)

(2) Same as basin unit (first) (page 12 and 13), fix cabinet (right) and basin unit (second). Fix cabinet and basin unit by screws through holes on left side of the cabinet.

- |                            |        |
|----------------------------|--------|
| • 3.8 × 32: tapping screws | 2 pcs. |
| • Washer (φ 5)             | 2 pcs. |
| • Cap                      | 2 pcs. |

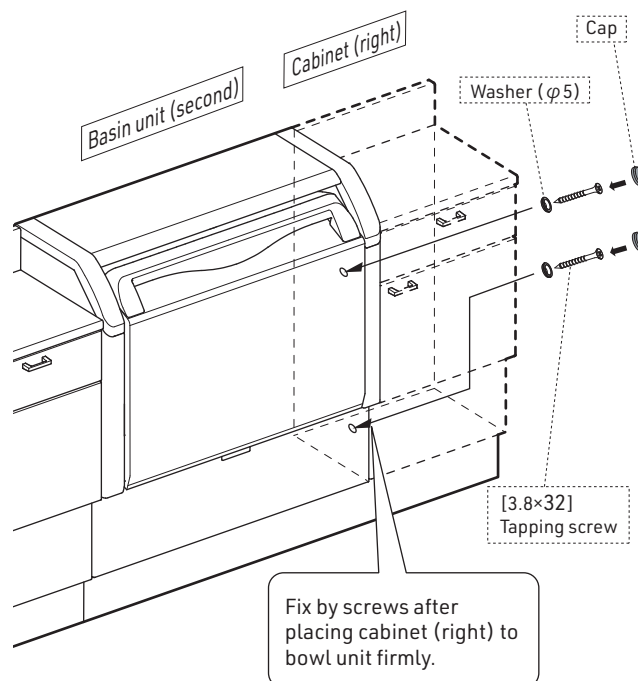

### ⚠ Caution

When removing drawer (3 door type), do not put drawer on the cabinet counter. It may cause scratch on the counter. Place soft cloth or blanket on the floor and put the drawer on it. Be careful not to lose any screws.

#### 1. Confirm the fixing position of basin unit and cabinet.

- (1) Confirm the joint part of basin unit, cabinet and platform and determine the fixing position.

#### 2. Fix cabinet (left (wall side))

- (2) Remove drawer of cabinet.

- (3) Fix by screws through holes (2 parts) on the back side of the cabinet.

- 3.8 × 51: tapping screws 2 pcs.
- Washer (φ 5) 2 pcs.

- (4) Attach cap on screw.

\*Cap is to conceal screw head.

- (5) Put drawer in the cabinet.

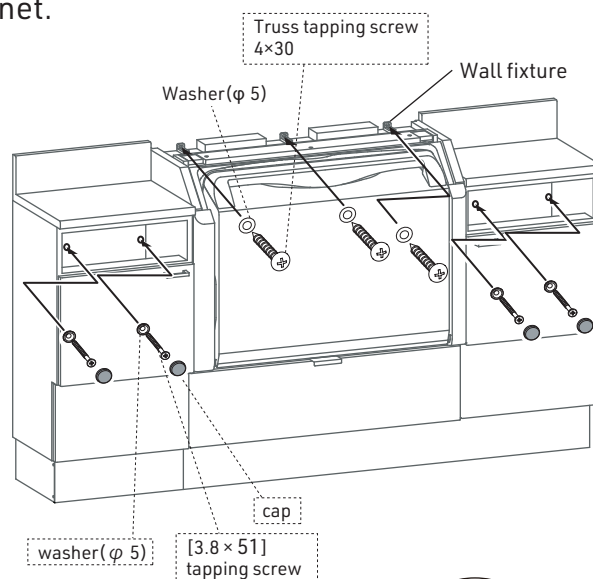

#### 3. Fix basin unit (first).

- (6) Open the bowl panel, loosen the screws securing the bowl body to the top panel, and remove the top panel.

### ⚠ Caution

Do not put removed counter on the floor. It may cause scratch on the counter. Place soft cloth or blanket on the floor and put the cabinet on it.

- (7) Fix by screws through wall fixing parts on the back side of basin unit (3 parts on the wall side).

- 4 × 30: tapping screws 3 pcs.
- Washer (φ 5) 3 pcs.

- (8) Adjust screws of the wall fixing parts on the backside of the bowl unit (3 parts on the wall side), to make the space between basin unit and wall narrower.

\*Space between wall to equipment to be different from installed place.

- (9) Fix the top plate to the bowl body.

\*Use stubby screw driver (No.2) for fixing.

Necessary tool : ⊕ Stubby screw driver

- M5 × 30 : truss screw 3 pcs.
- Stepped spacer 3 pcs.

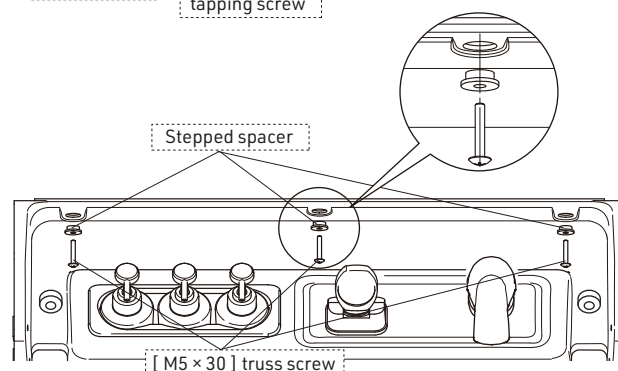

### ⚠ Caution

Pay attention to the length of tapping screw.

When fixing cabinet and basin unit

- 3.8 × 32: Tapping screws

When fixing basin unit and wall :

- 4.0 × 30: **Truss** tapping screws

When fixing cabinet and wall :

- 3.8 × 51: Tapping screws

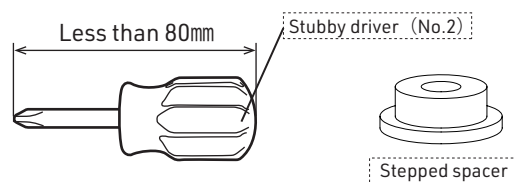

#### 4. Fix cabinet (center)

- Same as "3 Install bowl unit (first)", fix cabinet (center) to the wall.

#### 5. Fix basin unit (second)

- Same as "3 Install bowl unit (first)", fix basin unit (second) to the wall.

#### 6. Fix cabinet (right)

- Same as "3 Install bowl unit (first)", fix cabinet (right) to the wall.

## 1. Attach the water supply pipe and hot water supply pipe

### ⚠ Caution

Always connect the pipe after removing all contaminants on the pipe such as dirt, sand and oil.

- (1) Check that pipe installation suits product specifications (position, pipe, height) and that it matches the pipe installation diagram and template. (See page 5)
- (2) Attach the nipple (For thermostatic: stop valve) to the installed water supply pipe and installed hot water supply pipe.
- (3) Bend the flexible pipe to suit the position of check valve and nipple (For thermostatic ; stop valve).
- (4) Insert the supplied packing to the flexible pipe and attach to the stop valve.
- (5) Insert the supplied packing to the flexible pipe and attach to the nipple (For thermostatic: stop valve) .

### ⚠ Caution

- Always attach the supplied packing. Using EXCELA without installing the supplied packing may cause water leaks.
- Do not connect the hot water supply pipe and water supply pipe in reverse.
- Confirm there is no water leakage from the connecting part.
- Check that water is not leaking from the joint.

### < 1 tap type >

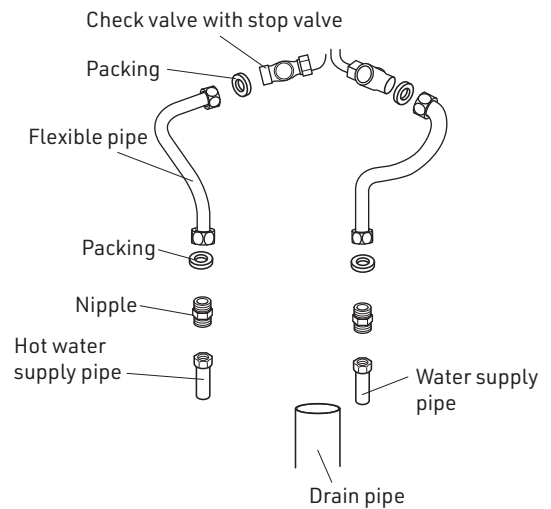

### < Thermostat type >

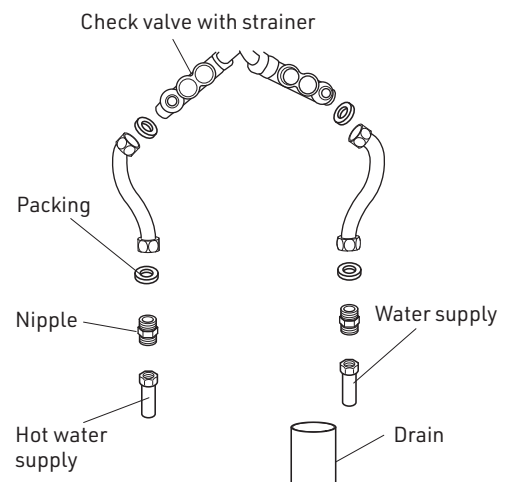

## 2. Attach drain hose to installed drain pipe

- Insert the drain hose to the drain pipe.
- \*To avoid that the drain hose may come loose, roll vinyl tape around the joint part.

### ⚠ Caution

- Check that the drain hose is not bent or damaged. This may affect water flow or damage the drain hose.
- Check that the hose is not in the shape of an S trap. An S trap can adversely affect the flow of drainage water.
- Confirm that the hot water supply pipe and water supply pipe are not attached each other.

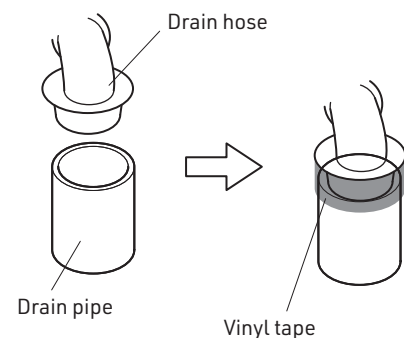

### [In case of Humidifier]

### ⚠ Caution

Check to make sure that the power cord for the humidifier is not in contact with the hot water/water supply pipe or the drain hose.



## 9 Checks after installation of pipes

### 1. Test water flow



**Caution** Always test the water flow to prevent accidents during use.

\* Test the water flow and inspect the following items. The hot water may be slightly tainted at the start of the water flow test, however this does not indicate any problem.

\* Thermo-type thermostats are designed to set an upper limit on the temperature of hot water. (The upper limit varies depending on supply pressure, water supply temperature, hot water temperature, hot water installation, and piping environment.)

(1) Is there no water leaking from the pipe joints

The pipe joints may come loose during transportation, so check the joints within the basin thoroughly.

(2) Are the hot water supply and water supply pressures at the same, stable pressure

If the pressure is not the same, see "How to adjust faulty temperature regulation" below.

(3) Can temperature be controlled properly

(4) Check that shower outlet flow is sufficient, by the following as a guide for flow rate.

Shower head : Approximately 8 L/min

Shower outlet flow rate

Hot water supply pressure, water supply pressure: 0.1 MPa each

Shower outlet temperature: 40

### 2. Clean

- After the hot water becomes clear during the water flow test, always clean the filter (In the case of thermostat type, filter is built in the check valve) and shower head.



**Caution**

- Failure to do so can result in insufficient flow rate and faulty temperature regulation. Take care not to damage or lose the packing.
- Do not add extra pressure when attaching and removing screws to the water sprayer. It may cause damage to the water sprayer or shower head.

Remove and clean any dirt trapped in the water sprayer.

<1 tap type>

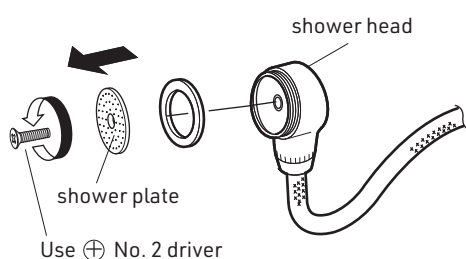

<Thermostatic type>

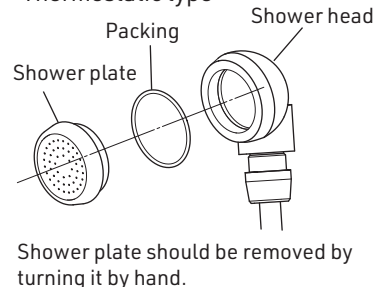

Remove and clean any dirt trapped within the filter.

<Thermostatic type>

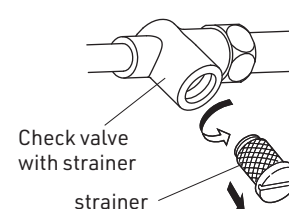

### Water temperature trouble

#### ○ Trouble

- Hot water does not come out properly. (Water temperature suddenly increases or decreases.)
- Hot water (high temperature) does not come out.
- Cold water (low temperature) does not come out.

#### ○ Estimated reason

- There may be big difference between hot water supply pressure and water supply pressure, or hot water pressure is stronger than water pressure.  
[Water supply pressure  $\geq$  hot water supply pressure (Difference between the hot water supply pressure and water supply pressure to be within 0.2 MPa)]
- Water / hot water supply pressure is high. [To be between 0.1 to 0.4 MPa (1 to 4kgf/cm<sup>2</sup>)]

#### ○ Solution

Attach pressure reducing valve (Option) and adjust the pressure level.  
(Recommend to adjust water pressure and hot water pressure to be equal.)

# 10 Adjust and remove/attach door

## ■Position of attaching door

- Confirm if the door (front and back, right and left, tilt, up and down) is attached properly. If the door is not attached properly, adjust it by the following process.

\*There are two adjustment points, upper and lower, on each door. Please adjust at both of them.



### Caution

Loose screws may cause the door to drop or fall off.

#### (1) Front and back adjustment

Turning the front/rear adjustment screw to the right (clockwise) moves the door backward and turning it to the left (semi-clockwise) moves it forward. (Adjustment range is about 3mm)

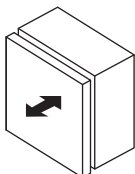

#### (2) Right and Left adjustment

Turning the left/right adjustment screw clockwise moves the door to the right, and turning it counterclockwise (half-clockwise) moves it to the left. (Adjustment range is about 3mm)

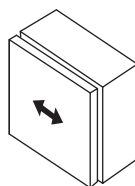

#### (3) Tilt adjustment

This is done by turning the left/right adjustment screw left or right.

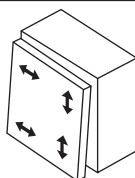

#### (4) Up and Down adjustment

Turning the front/rear adjustment screw clockwise moves the door up, and turning it counterclockwise moves it down. (Adjustment range is about 4mm)

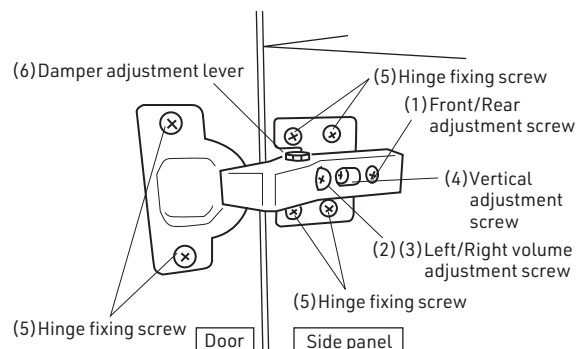
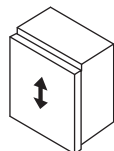

#### (5) Hinge fixing screw

These are the screws that hold the hinges in place. Adjustment is not normally required. However, if the screws are loosened, please tighten them firmly.

#### (6) Damper adjustment lever (only with damper type)

The lever can be used to adjust the strength in 5 steps. Turning the lever clockwise (right) makes it stronger and counterclockwise (left) makes it weaker. The lever is located above or below the hinge mounting direction.

## ■Attach and remove the door

### ○Remove the door

Pull lock the lever on the edge of hinge and pull the door.

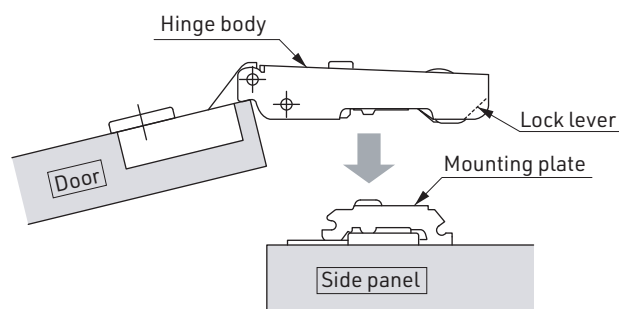
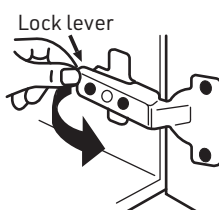

### ○Attach the door

Put the hinge body on the mounting plate and push it until the sound appears. (Attachment completed.)

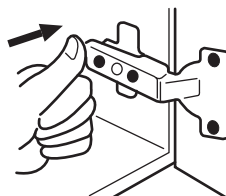

\*The hinge is one-touch attachable / removable type.



### Caution

- Confirm if the body is attached to the mounting plate properly. Otherwise, door may fall down or it may cause injury.
- When removing or installing the door, be careful not to let the door fall. Failure to do so may result in injury or damage.

## After installation



### Caution

Always conduct the following inspections to prevent accidents during use.

#### ■ Inspection items (basin unit)

- (1) Are there any screws that have not been attached?
- (2) Is there any rattling?  
Check the attachment areas (screws) again if there is any rattling.
- (3) Are there any cracks or dirt on the bowl?
- (4) Is there any damage or blemishes on the exterior parts?
- (5) Is water leaking onto the floor surface?
- (6) Is there a big space between the unit and the wall?
- (7) Is there a big space between the unit and the cabinet?

#### ■ Inspection items (cabinet)

- (1) Are there any screws that have not been attached?
- (2) Is there any rattling?  
Check the attachment areas (screws) again if there is any rattling.
- (3) Is there any damage or blemishes on the exterior parts?
- (4) Is there a big space between the cabinet and the wall?
- (5) Is there a big space between the cabinet and the basin unit?

## 11 Caulking

Do the caulking process as per the followings.

- Apply caulking on the joint part between basin unit and cabinet, and joint part between the unit and wall.  
(Width of caulking : 3mm or less)
- \* Color of caulking to be selected as per the color of basin unit and cabinet. (White, Clear, Gray etc.)
- \* Before caulking, do the masking process.



### Caution

Caulking to be done on the joint between basin unit and cabinet, or joint part of the unit and the wall.  
If not, water comes into the joint part and it may cause corrosion to the basin unit, cabinet and wall.

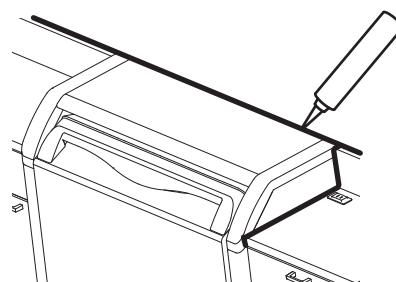
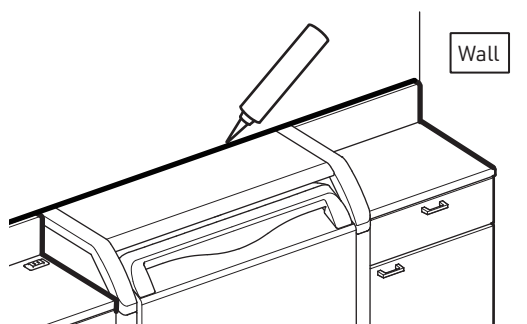

# Attach optional parts

## ■ Attach neck cushion (Option)

1. Remove dust, dirt, oil and so on from the shampoo bowl attachment part and suction cap. And wipe moisture from the shampoo bowl.

2. Confirm the direction of neck cushion as shown in the picture.

3. Push center part of neck cushion suction (bowl side) to the shampoo bowl attachment part (inside), and attach it.

4. Along with the line of shampoo bowl, adjust the shape of neck cushion and press the center part of neck cushion suction cap (chair side) to the shampoo bowl attachment part (outside), and attach it.

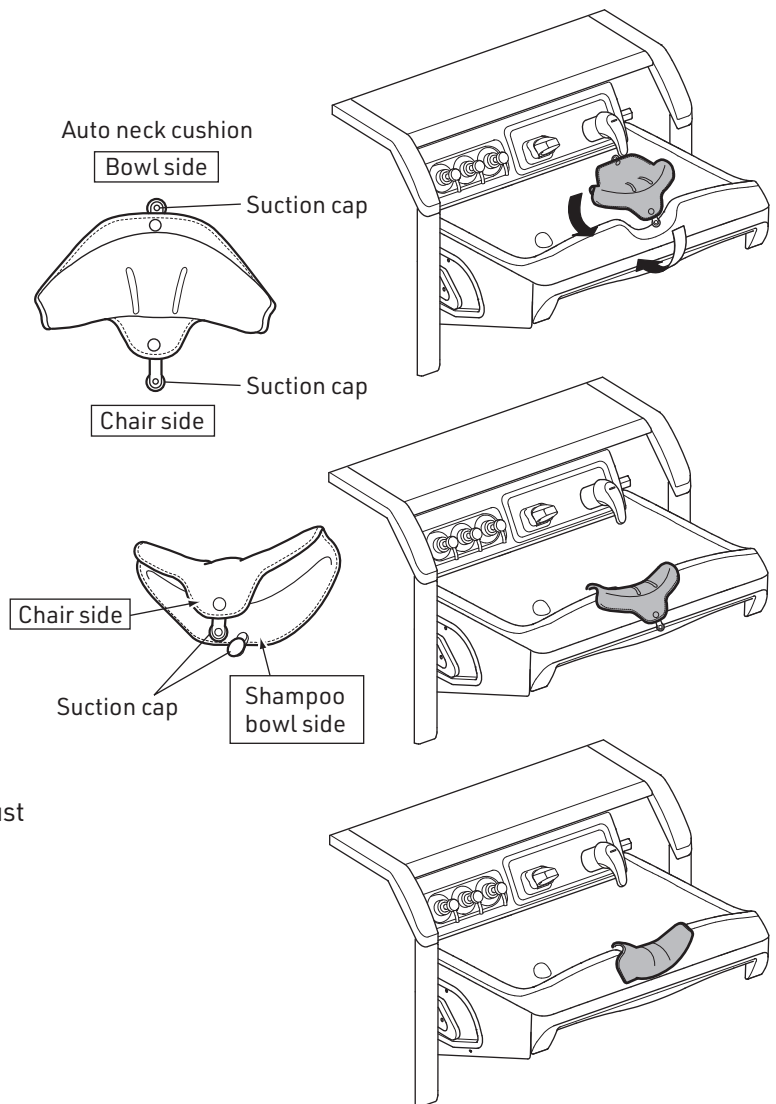

## ■ Attach mirror (Option)

\*Refer to the "Installation/Operation manual of EX mirror and EX side panel" which is supplied with EX mirror.

## ■ Attach side panel (Option)

\*Refer to the "Installation/Operation manual of EX mirror and EX side panel" which is supplied with EX mirror.

# Memo

# Memo

# Memo



**TAKARA BELMONT CORPORATION**

1-1, 2-Chome, Higashi-shinsaibashi, Chuo-ku, Osaka, Japan

TEL : +81-6-6213-5945

FAX : +81-6-6212-3680

Printed in Japan

1E0AQ6A0