

EXCELA

Operating Manual

■EXCELA

- Bowl Unit
 - P1-EX** [1 tap type]
 - PT-EX** [Thermostat type]
- Cabinet
 - KF-EX*S** [S size]
 - KF-EX***[Others]
- Platform
 - KF-EX*

■Option

- Side panel
KF-EXSP* *
- Mirror
KF-EXM800
- Auto neck cushion
KF-NC

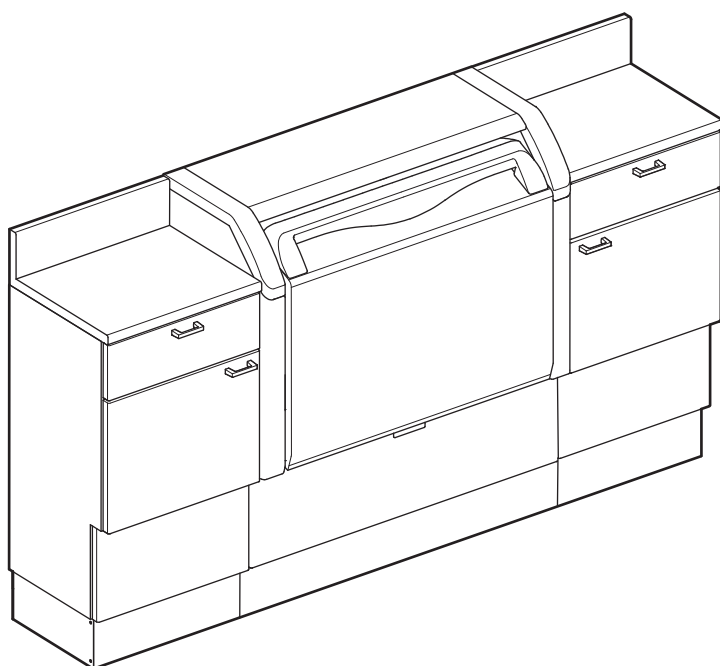

(Image is of 1 set: P1-EX** / KF-EX3S*R / KF-EX3S*L /
KF-EX380 / KF-EX1200)

Table of Contents

Description of Warning Symbols	2
Safety Precautions	2
Precaution for use	5
Position of Warning Labels	8
Before Using This Product	8
Name of Parts	9
Accessories	10
Preparation	10
How to Use	11
Guiding Customers	16
Power outage correspondence	18
Maintenance	18
Daily Inspections	22
Consumable Supplies	23
Standard Duration of Use	23
Before Requesting Repairs	23
Parts supply period	23
Disposing of This Product	23
Consumable Supplies	24
Specifications	25
Dimensions	26
Procedures for Daily Inspections	28
Information	32

Thank you for purchasing Takara Belmont product.

The instructions contained in this booklet should be thoroughly read and understood before use.

Using this product before reading this operating manual may result in an accident.

This product is an industrial shampoo unit designed for hairdressing salons. Only use this product for its intended purpose and do not use it for non-hairdressing work. Keep this manual and refer back to them when required.

This product is designed for shampooing. If the manual is unreadable due to contamination, breaking or be missing, contact your local authorized Takara Belmont dealer.

Description of Warning Symbols

■ Before using this product

The "Safety Precautions" and "Precautions for Use" contained in this booklet should be thoroughly read and use this product correctly.

■ Precautions listed here :

The precautions listed here are to ensure that this product can be used safely, and to prevent any danger or risk to the person using this product or those around them.

These precautions are important for ensuring safety. Adhere to these precautions at all times.

Takara Belmont is not responsible for any damage or risk to the person using this product or those around them due to accidents if this product is used without adhering to the "Safety Precautions" and "Precautions for Use". In this case, the person failing to adhere to the "Safety Precautions" and "Precautions for Use" will be responsible for any damage or risk incurred. Detailed descriptions of symbols are provided below. Read and understand these symbols thoroughly before reading this manual.

■ Symbols



If this symbol is ignored and the product is used, "there is the risk of death or serious injury to the user".



If this symbol is ignored and the product is used, "there is the risk of light or moderate injury or property damage".

Note

Description of "ideal points to adhere to for safety".



Common danger, warning and caution notifications



Common prohibited actions



Disassembly
Prohibited

Prohibited disassembly or
repairs/modifications



Caution for the high temperature



Guidance or instruction regarding
common use actions

Safety Precautions (Adhere to there precautions at all times)

Warning



Install on a solid place.

Install the main body on a flat, firm floor, and fix it securely. Failure to follow this instruction may cause the main body to fall over.

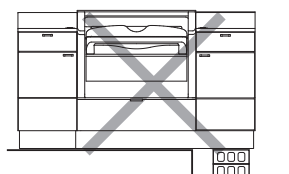

Adjust the temperature while checking the temperature by hand.

When adjusting the temperature of the water, reduce the volume of water, point the shower head away from the customer and check the temperature by hand. Take care when doing so, as hot water may come out of the shower head.



Do not lean over on the basin when shampooing.

Leaning over on the basin when shampooing may cause the basin to fall over. Also, coloring dyes on the auto neck cushion (Option) or basin may stain the user's clothes.

! Warning



Disassembly
Prohibited

Disassembly and repairs/modifications are prohibited.

Disassembly, repairs and modifications must not be conducted by people other than qualified repair technicians. Failure to follow this instruction may cause electric shock, fire or abnormal operation, leading to injury.

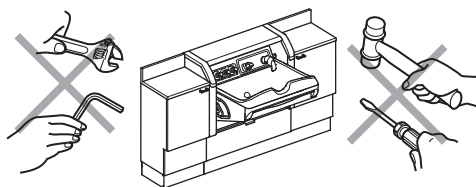

Do not climb on parts such as the basin unit, shampoo bowl or cabinet.

Failure to follow this instruction may damage the basin unit, shampoo bowl, cabinet and so on, or lead to injury.

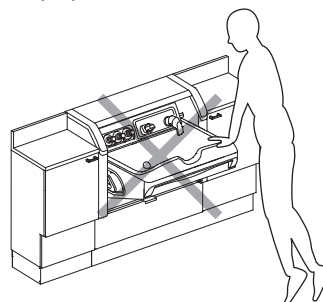

Return the temperature control knob to an appropriate temperature position after using hot water.

- Return the temperature control knob to an appropriate temperature position after using hot water. Continuing to use the hot water with the knob in the hot position may cause burns.
- Using other appliances that share the same water/hot water supply source at the same time may cause unstable water temperature. If multiple appliances are to be used, move the temperature control knob slowly to adjust the temperature.



Do not use hot water (boiling water) of 60°C or higher.

Using hot water of 60 or damage the basin, shower head, water on/off tap and so on.



Keep the temperature of hot water supply to the equipment below 60°C.

Turning the water shutoff lever on the 1-cock to the high temperature side will produce hot water up to the same temperature as the hot water supply. Using hot water above 60°C will not only deform or damage the equipment, but may also cause burns. Do not set the water heater temperature higher than 60°C even in winter.



Shampooing at the proper position.

- The chair used with EXCELA to be installed at the proper position. Failure to follow this instruction may cause damage, leading to injury.
- Chair should be set at the proper position and height while shampooing. Pay attention to the customer's health condition during the operation. If the customer seats on the chair at uncomfortable position, it may lead serious injury.
- Pay attention especially to child or physically disabled person. Do not hang on to the shampoo bowl, or do not shampooing while customer does not seat on the chair securely. Failure to follow this instruction may lead to a heavy injury.

Warning



Do not put heavy objects of 10kg or more in the drawer or cabinet rack.

Store light objects such as towel or shampoo cape in the cabinet. If heavy objects are stored in, it may damage the joint part or drawer rail, or fall to the floor, leading to breakage of the product.



Do not climb on parts such as the door and drawer.

Do not climb on, pull or apply excessive force to parts such as the door and drawer. Failure to follow this instruction may damage the joint part or drawer rail, or cause basin unit and cabinet to fall over. Pay attention especially to child.

Caution



Do not spray areas other than the basin with water.

- Take care not to spray areas of main body other than the basin with water. If water does come in contact with areas of main body other than the basin, wipe them dry as soon as possible. Water entering the power outlet of platform may cause malfunctions or a ground leakage fire.
- Take care not to allow water to drip on the floor. If water does drip on the floor, wipe it dry as soon as possible. Failure to follow this instruction may damage the floor, or cause water leakage.



Do not use this product if the coating is peeling.

If the coating of water taps and handles is peeling, contact your nearest dealer or Takara Belmont and replace it. Continuing to use this product when the coating is peeling may cause injury.



Pay attention to door opening/closing.

When opening the cabinet door and storing towels, etc. in the cabinet, pay attention to arms, hands and fingers not to be caught in the door. Failure to follow this instruction may cause injury.



Do not put any insecure objects on the basin unit counter.

the objects may fall over to the client if during shampooing, leading to injury. Do not place any insecure objects which may be fall over easily.



Pay attention not to hit to customer leg when opening the bowl panel.

Before opening the bowl panel, confirm safety of customers leg. If the bowl panel hit to such as knee, it may cause injury.



Do not operate chair when the bowl panel is opened.

While raising/lowering or rotating the chair, or raising/lowering the legrest, always check and make sure that bowl panel is not opened and there are no people or objects within the operating area. Chair may hit main body of shampoo unit or customer.



Do not open and close bowl panel or cabinet strongly.

Do not open and close bowl panel with a great force. Pulling or pressing bowl panel or cabinet strongly may deform or break the product, leading customer to be injured.



Do not let the customer stand up from the seated position while leaning on or hanging on to the bowl.

Customer should not lean on or hang on to the shampoo bowl when standing up from the seated position. Failure to follow this instruction may damage bowl or cause it to fall over.



Do not let customer seat when bowl panel is opened.

When letting customer seat on the chair, close the bowl panel properly. The customer may lose balance and fall over, leading to injury.



Support the customers head, hands and fingers not to touch the shampoo unit while washing face.

Failure to follow this instruction may cause the customer to hit the head on the counter, or cause the customers arm, hands or fingers to touch the inner parts of shampoo bowl, leading to injury.



Freezing caution

Components may be damaged and leakage accidents may occur. Damage caused by freezing will result in chargeable repair even within the warranty period. If there is a risk of freezing, keep the room temperature below 0°C (32°F) by heating, etc.

⚠ Caution

<p>⊘ Do not subject the unit to shocks. Do not subject the unit to shocks. Failure to follow this instruction may cause damage, leading to injury.</p>	<p>⊘ Only use this product for its intended purpose and do not use it for non-hairdressing work. This product is an industrial product designed for hairdressing salons. Only use this product for its intended purpose and do not use it for non-hairdressing work.</p>
<p>⊘ Do not put hands or fingers in the space between bowl panel and main body. Do not put hands or fingers in the space between bowl panel and main body counter, or bowl panel and side pillar. Failure to follow this instruction may cause damage to main body, leading to injury. Pay attention to small child, especially. If the hands or fingers are caught in the space while opening or closing, it may cause a heavy injury. Please confirm the safety before opening or closing.</p>	<p>⊘ Do not drink the hot water. This product is designed for washing hair. Do not drink the hot water. The water quality may cause diarrhea or stomach pain.</p>
	<p>⊘ Do not pull drain hose forcedly. Failure to follow this instruction may let drain hose come off, leading to water leakage or electric shock.</p>
<p>⊘ Do not use this product with the door broken. If the door breaks, contact your nearest dealer or Takara Belmont and replace it. Continuing to use this product with a broken door may cause injury.</p>	<p>⊘ Do not use outdoors. This product is designed for indoor use. Do not install this product outdoors or within a vehicle. Be sure to only use this product inside a hairdressing salon. Failure to follow this instruction may cause malfunctions or damage to the main body.</p>

Precautions for Use

⚠ Caution

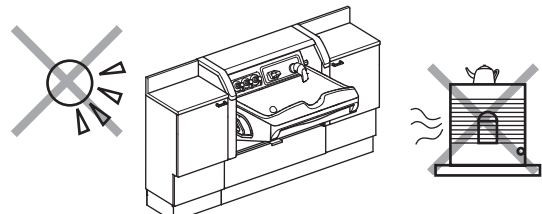
<p>⊘ Do not cover the drain outlet when this product is not going to be used. After shampooing, do not cover the drain outlet with the towel or shampoo cloth. Hot water may spout out accidentally, or a slight trickle of hot water due to an increase in water pressure at night may cause water to spill from the basin, leading to water leakage.</p> 	<p>⚠ Do not let anything get inside the drain outlet of shampoo bowl. Failure to follow the instruction may cause the drain to become blocked and proper use will be not available. If any objects get in the drain outlet, stop using the unit immediately and contact your local authorized Takara Belmont dealer.</p>
	<p>⊘ Do not touch the hot water supply pipe or mixing pipe. The hot water supply pipe or mixing pipe may become very hot. Do not touch the pipes directly.</p>
<p>⚠ Avoid direct sunlight or heat from a stove. Avoid direct sunlight or heat from a stove. Failure to follow this instruction may cause discoloration or degradation of the unit.</p> 	<p>⊘ Do not hit the unit with objects. Do not hit the unit with hard objects. Failure to follow this instruction may cause deformation or damage to the unit.</p>
	<p>⊘ Do not use abrasive agent. Do not use abrasive agent to clean the shower head, shower head bracket, back guard, glass counter and so on. Using hard cleaning tools such as abrasive agent, abrasive sponge, wire wool, nylon brush on those parts may cause scratches.</p>

⚠ Caution



Do not use strongly acidic or strongly alkaline cleaning solvents.

Do not use cleaning solvents containing mainly caustic soda (NaOH) or caustic potash (KOH) to clean the drain pipe etc. Never pour thinners, alcohol, nail polish remover, gasoline or kerosene into the drain. Failure to follow this instruction may cause damage to the drain hose.



Do not wipe with chemicals or apply heat.

Failure to follow this instruction may cause deterioration or discoloration. If chemicals spill on to the doors, counters, etc., wipe them off as soon as possible.

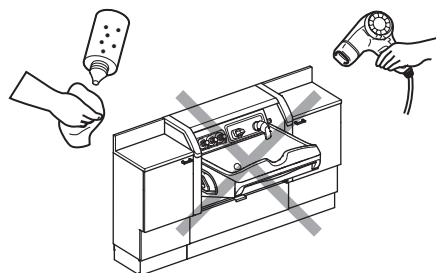

If chemicals spill on to this product, wipe them dry as soon as possible.

If chemicals such as hair dyes spill on to this product, wipe them dry as soon as possible. Failure to follow this instruction may cause discoloration, deterioration or deformation. Also, if chemicals spill on to the floor, wipe them dry as soon as possible.



Always wipe the floor clean if it is wet.

Wipe the floor as soon as possible if it is wet after shampooing. Failure to follow this instruction may deteriorate the floor or cause deterioration or malfunctions of the parts in contact with the floor.



Do not use hack berry oil or aromatic pills.

Do not use menthol-containing peppermint oil or aroma oil. Doing so may damage plastic parts such as shower head, shower head holder, shower hose, water shut-off handle, temperature control handle, neck cushion (sold separately), etc.



After use, wipe water away from all parts other than the basin.

Leaving the unit with water on it may cause breakage, and make dirt difficult to remove.



Do not turn the water fully on with the shower head in the shower head bracket.

Failure to follow this instruction may cause water to spill out of the basin, covering the customer with water. When turning the water on with the shower head in the shower head bracket, check the surrounding and turn or raise the tap slowly.



Clean inner part of the bowl every day.

Remove moisture and dirt attached to control panel and inner panel of basin unit every day. Failure to follow this instruction may cause discoloration, deformation and corrosion.



Take care when handling the shower hose.

Do not pull shower hose forcibly. Failure to follow this instruction may cause breakage or water leakage.



Do not hang anything on the handle of cabinet door.

Do not hook or hand anything on the handle of cabinet door. Failure to follow this instruction may cause malfunction of opening/closing the door or damage.



Clean the shower hose.

Clean the shower hose as regularly as possible. Failing to follow this instruction may make dirt difficult to remove from the shower hose.



Do not keep cabinet drawer and door opened.

Failure to follow this instruction may cause deformation and damage. Do not store any objects prevent from closing the door properly.



Use the maintenance door properly.

When attaching and removing maintenance door, pay attention not to drop it off or hit on the equipment or chair. Failure to follow this instruction may cause breakage of maintenance door, or malfunction of main unit or chair.



Do not apply excessive force to the door and drawer.

Do not apply excessive force to the door and drawer. It may cause breakage to door or drawer, leading to injury.



Attach maintenance door properly.

After maintenance, etc., attach maintenance door properly. If the maintenance door drops off during shampooing, it may break the equipment, or lead to injury.



Caution



Remove the neck cushion by holding the suction cap. (In case of using neck cushion.)

When removing the neck cushion from shampoo bowl, hold the suction cap and remove it. Pulling other part or trying to pull the suction cap forcedly may cause breakage of the neck cushion.



In cold regions, ensure that water is removed. (in case of thermostat type)

When using this product in winter in cold regions, remove the maintenance cover and open the check valve filter to remove water and prevent freezing. Failure to follow this instruction may cause water leakage.

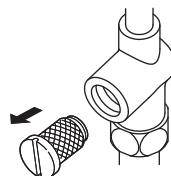

Handle neck cushions with care (when using neck cushions).

Do not touch or apply scissors or other blades or sharp objects (including extended fingernails) to the neck cushion. Doing so may scratch or



Clean the drain outlet of inner panel.

Clean the drain outlet of inner panel regularly. Failure to follow this instruction may cause the drain to become blocked with dust, leading to overflowing and unusual odor.



Place exclusive bottle on bottle holder.

When the exclusive bottle is placed on other than exclusive bottle, it may cause falling or damage.



Do not apply water on counter, back side of control panel and side part of shampoo bowl.

When using water, try to point the shower head away from the counter, back side of control panel and side part of shampoo bowl. Failure to follow this instruction may cause malfunction and damage.



Clean the hair catcher regularly.

Clean the hair catcher as regularly as possible. Continuing to use the hair catcher without cleaning it may cause the drain to become blocked with hair, leading to water overflowing and unhygienic conditions.



Do not drop heavy objects on to the basin.

Do not place or drop heavy objects on to the basin. Failure to follow this instruction may break the basin.



Close the tap firmly.

After use or shampooing is complete, close the taps firmly and turn the water off completely. Failure to turn the water off completely may cause water leakage.

Position of Warning Labels

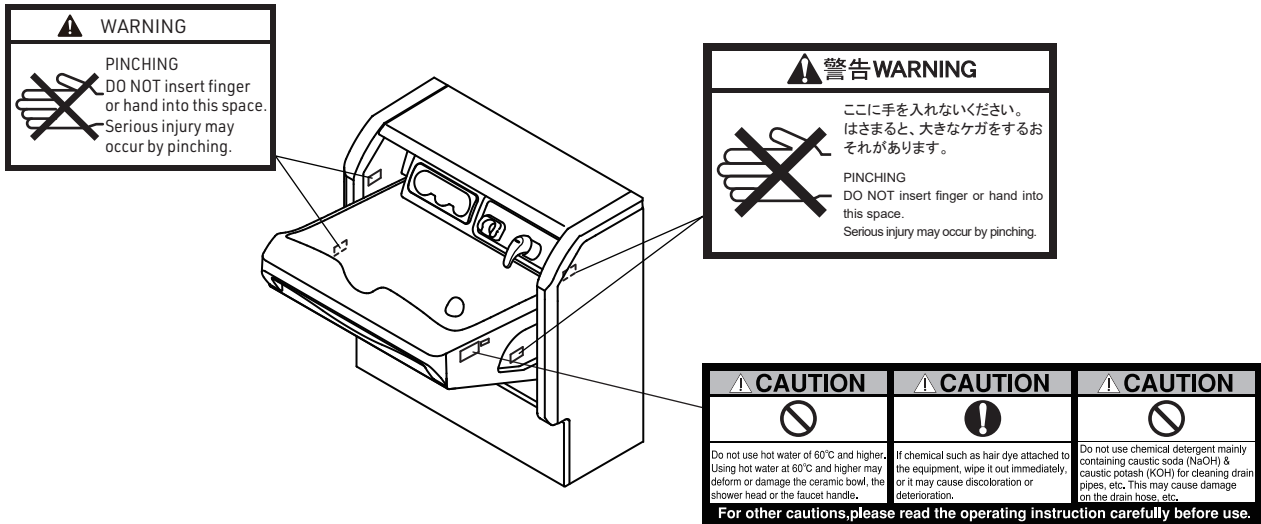

Before Using This Product

- This product (EXCELA) is a shampooing unit designed for performing shampooing.
- Check that all accessories have been attached properly.
- For performing back shampooing more comfortably, the use of a auto neck cushion (Option) is recommended.
- Melamine is used for basin unit, bowl panel and outer surface of cabinet. There is a slight gap in the patterns of melamine, some part may be not flat, and there may be a small inclusion in the melamine. This is made during the process of manufacturing melamine, and is not indicative of defective.
- Artificial marble is used for bowl handle and side pillars. This material can be used with easy maintenance and has high-water resistance. However, please note the followings in advance.
 1. Please note that the width and depth may vary slightly from product to product.
 2. Patterns of the surface may vary from product to product. Please note that the patterns of the surface may vary slightly.
 3. With aging, shampoo bowl may become yellowing or color degradation.
- The above is occurred due to the process of manufacturing artificial marble and features of it, and is not indicative of defective quality.

Name of Parts

■ Main Unit

< 1 tap type (Picture shows 1 set) >

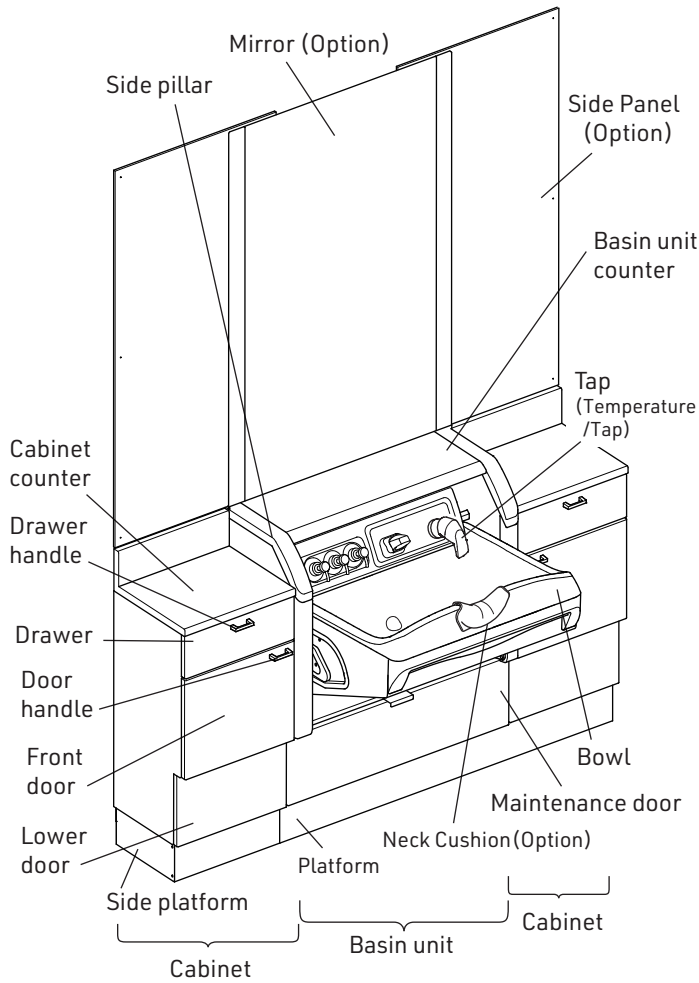

< Thermostat Type (Picture shows 1 set) >

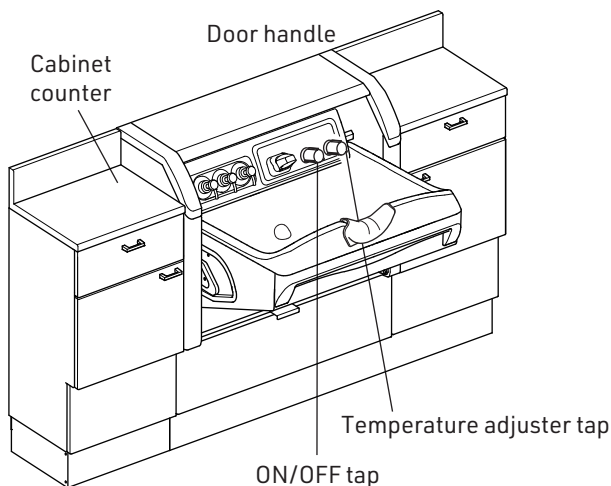

Neck height	Including Neck cushion
760	780

Neck height may vary slightly from model to model. Height of neck cushion is as of attaching Neck Cushion (Option) on the shampoo bowl neck part.

■ Bowl

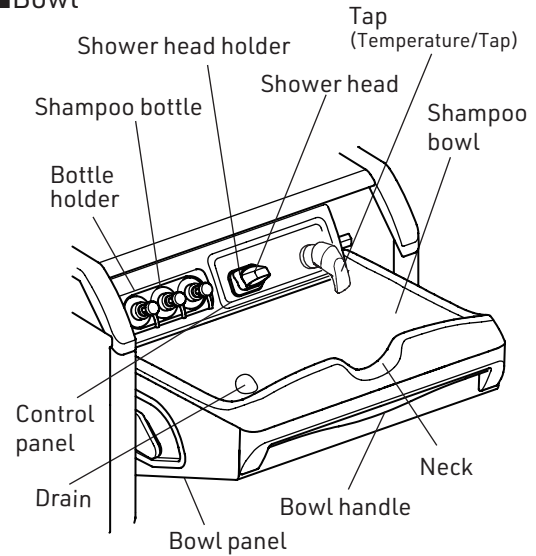

■ Inside of basin unit <1 tap type>

Lower part of bowl panel and inside of maintenance door

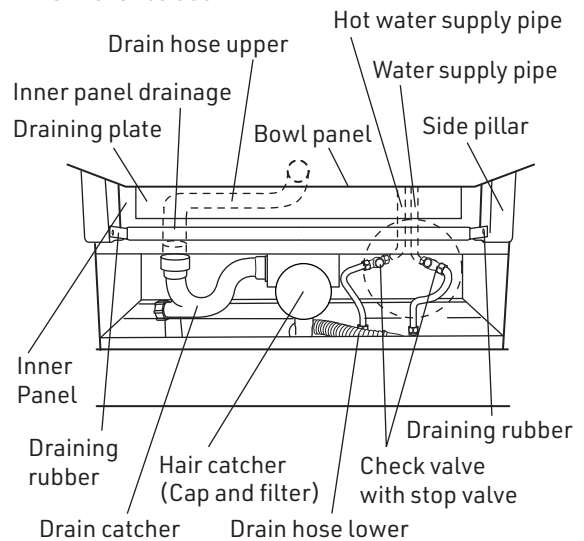

■ Inside of basin unit <Thermostat type>

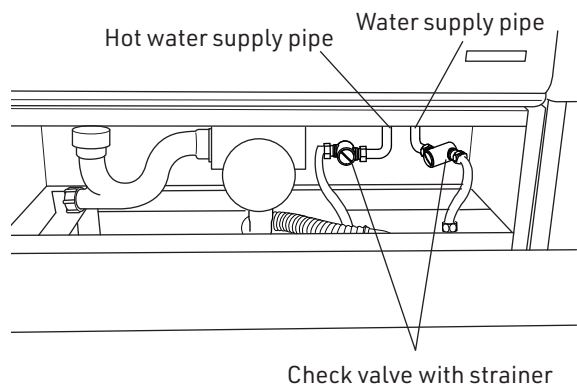

Accessories

- Exclusive bottle
(With pump
nozzle)

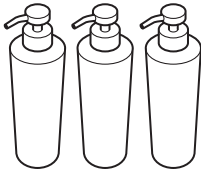

- Drip nozzle x 3
(Replace from pump
nozzle as per usage.)

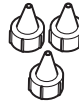

- Nozzle packing x 3



- Installation manual x 1

- Operating manual x 1
(this manual)

- Information on
Periodic Replacement Parts x 1

Preparation

<Auto neck cushion (Option)>

■ Attach neck cushion

1. Remove dust, dirt, oil etc. and wipe water off from attachment part of shampoo bowl and suction caps.
2. Align the neck cushion as shown in the illustration, and make sure the attachment orientation is correct.
3. Attach and push center part of the suction caps (shampoo bowl side) of neck cushion (inner side) to the attachment part of shampoo bowl.
4. Adjust the shape of the neck cushion to fix it to the attachment fittings, and attach the center part of suction cap (chair side) to the attachment part of shampoo bowl (outer side).

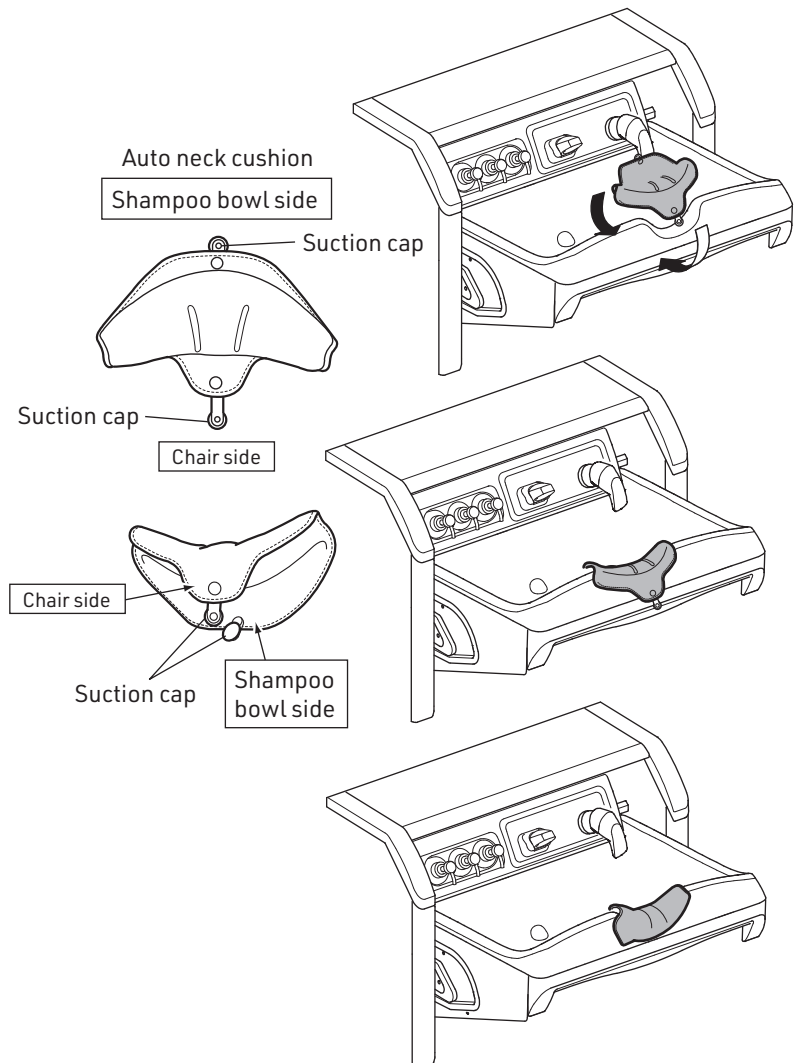

■ Remove neck cushion

- Hold the suction caps (2 parts) when removing the neck cushion.



Caution

Holding the neck cushion or applying excessive force to remove the neck cushion may damage the parts.

Note

The neck cushion is consumable supplies.
Replace them if they are extremely dirty or the surface has deteriorated. (available at additional cost)
For neck cushion replacement, contact your local authorized Takara Belmont dealer.

How to Use

■ Open the bowl panel

Hold the bowl handle of bowl panel and pull it forward.
Open the bowl completely to the end.

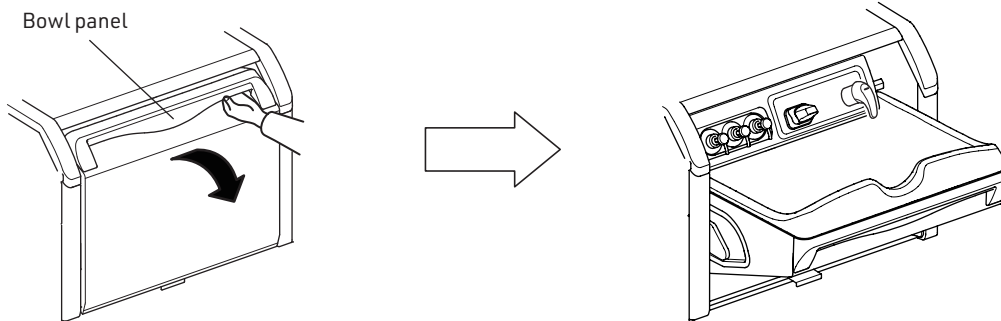

Caution

- Confirm the safety before opening the bowl panel.
If the fingers or hands are caught in the door, it may cause injury.
- When opening the bowl panel, confirm there is no objects around the bowl panel.
If the bowl panel attach to the objects, equipment may be broken.
- When opening the bowl panel, do not apply excessive force.
If opening the door quickly, it may cause deformation, breakage or injury to customers.

■ Using shower head

1. Hold the shower head and pull it.

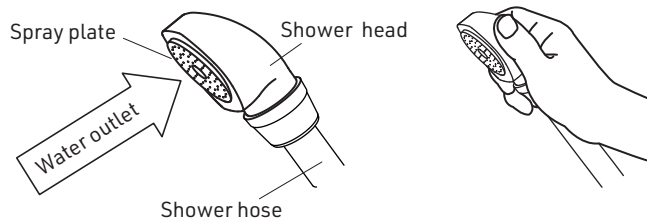

2. Return the shower head to the shower head bracket.

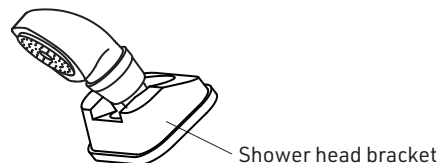

Caution

- Return the shower head to the shower head bracket after use. Otherwise, it may cause breakage of shower head or shampoo bowl may be damaged.
- Return the shower head to the shower head bracket after use so that the spray plate is pointed toward the basin. Otherwise, water may come out from the shampoo bowl when using the water next time.
- Do not pull or bend the shower hose. It may cause breakage or water leakage.

■ Adjust the volume of hot water

< 1 tap type >

1. Pull the shower head to avoid water applied to client.
2. lift the water shut-off handle as shown in the figure to release hot water from the shower head. The amount of hot water increases as the handle is lifted upward.
3. Lower the water shutoff handle as shown in the illustration to turn off the hot water.

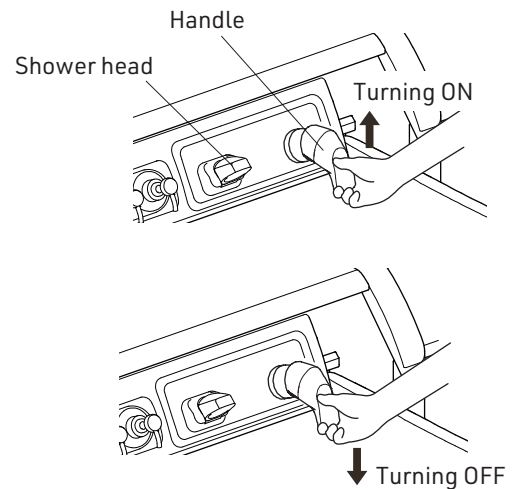

< Thermostat type >

Turning the water shutoff handle to the left (counterclockwise) will cause hot water to flow out of the shower head. Each turn to the left increases the amount of hot water. When turned fully clockwise, the water stops.

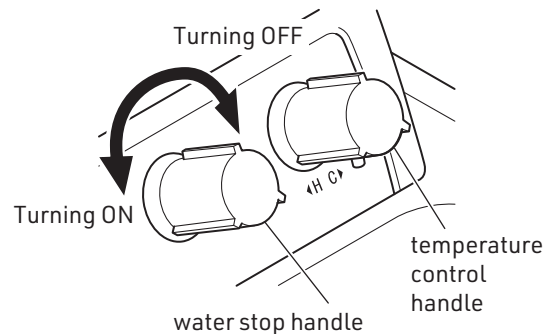

⚠ Warning

< 1 tap type >

C marking (Cold)

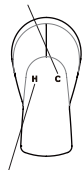

H marking (Hot)

- When using hot water, make sure to pull the handle upwards from the right side (C marked side). If pulling the handle from the left side (H marked side), hot water comes out from the shower head and it may cause burn injury.
- When stopping the hot water, make sure to push the handle downwards from the right side (C marked part). Otherwise, remained hot water may come out from the shower head when using hot water next time, and it may cause burn injury.

⚠ Caution

< 1 tap type >

- When the basin is not being used, turn the tap to right (clockwise) fully to turn the water off properly.
- Operate the 1 tap water stophandle slowly. Operating the handle quickly may cause sounds, or the hot water temperature may be changed accidentally.

< Common to both 1 tap type and thermostat type >

- After shampooing, do not cover the drain with the drain cap, towel or shampoo cloth as hot water may come out. If a small amount of hot water is discharged due to increased water pressure late at night, water may overflow from the shampoo bowl, resulting in a leakage accident.
- If the water does not come out properly, dirt and so on may be piled in the drain pipe, so do not use it and contact to your local authorized Takara Belmont dealer.

Note

- A gushing sound may be emitted from the main body depending on the environmental conditions that it is used in. This sound is due to water flowing fast through pipes as a result of high water pressure or water volume control, and is not indicative of a defective product. This gushing sound can be reduced by adjusting the water pressure.
- Depending on the environment and conditions of use, the water stop handle may become hard to turn. This is due to deterioration of the packing and other parts of the moving parts and loss of grease over time, and requires replacement of the packing, cartridge, etc. or application of grease. Please contact your local authorized Takara Belmont dealer if you require adjustment or replacement work as described above. (Charged).
- Water dripping from the shower is discharge of residual water inside the shower head and is not a malfunction.

■ Adjusting the volume of water

< 1 tap type >

1. Turning the handle to left side (H marked side), water temperature will be increased.
2. Turning the handle to right side (C marked side), water temperature will be decreased.



Caution

When adjusting the temperature of the hot water, reduce the amount of hot water, change the direction of the shower head not to catch the customer, and adjust the temperature while checking the temperature by hand. In this case, hot water may be emitted, be careful when operating the shower head.

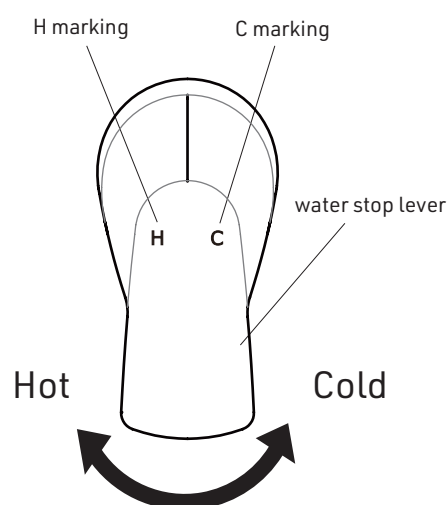

< Thermostat type >

1. Turn the temperature control knob toward H or C to set the appropriate temperature. Turn the handle toward "H" to make the hot water hot and toward "C" to make the hot water cold.
2. If you continue to turn the temperature control handle in the direction of "H", it will stop at the temperature control lock position. When using hot water beyond this position (over 40°C), turn the handle in the direction of "H" while pressing the lock button on the temperature control knob to increase the temperature.

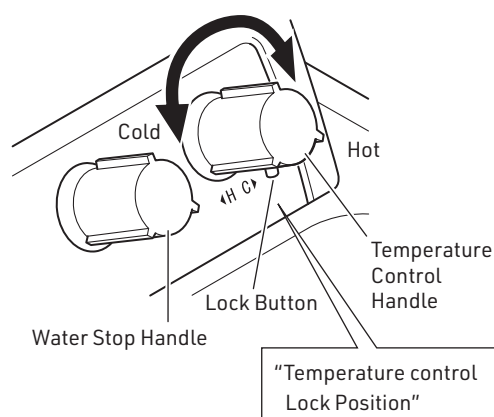

*The hot water temperature of the water heater should be set at least 10°C higher than the water discharge temperature.

*The hot water heater is designed to set an upper limit on the temperature of hot water.

(The upper limit varies depending on supply pressure, water supply temperature, hot water temperature, hot water installation, and piping environment.)

Warning

< 1 tap type >

- When using hot water, make sure to pull ON/OFF handle upwards from the right side (C marked side). If pulling ON/OFF handle from the left side (H marked side), hot water comes out from the shower head and it may cause burn injury.
- When stopping the hot water, make sure to push ON/OFF handle downwards from the right side (marked part). Otherwise, remained hot water may come out from the shower head when using hot water next time, and it may cause burn injury.

< Thermostatic type >

- Check the temperature setting position of the temperature control handle before dispensing water. There is a risk of scalding due to hot water. When washing hair at a higher temperature than the temperature control lock position, do not operate the temperature control handle while washing hair. There is a risk of scalding due to hot water splashing on the head by mistake.
- If the handle is turned to a higher temperature than the temperature control lock position, be sure to return the handle to the temperature control lock position after use. If you use the product at the same temperature as before, your hands or head may be scalded by the hot water.

Caution

< 1 tap type >

- Do not use with the hot water at 60° or higher. It may cause deformation or breakage of shampoo bowl, shower head, shower hose, handle and so on.

< Common to 1 tap type and Thermostatic type >

- When adjusting the water temperature, reduce the volume of water, pint the shower head away from the customer and check the temperature by hand. Take care when doing so, as hot water may come out the shower head.
- Always check the temperature of the hot water before applying it to the customer's head.
- Operate ON/OFF handle slowly. Operating the handle quickly may cause a gushing sounds or the temperature of the hot water may be changed accidentally.
- When operating the water shutoff handle or temperature control handle, remove metal objects such as rings or watch bands before operating the handle. If the metal contacts the water shutoff handle or temperature control handle, the plated surface may be scratched or cracked, causing the plating to peel.
- Before use, check that there are no scratches, cracks, or peeling of the plating on the plated surface of the water shutoff handle and temperature control handle. If the plating is peeling, stop using the product immediately and contact your local authorized Takara Belmont dealer. Continued use may cause injury.

Note

< Thermostatic type >

- Depending on the environment and conditions of use, the temperature of hot water in the temperature control lock position may not reach 40°C (approximate optimal temperature), but this is not abnormal. This lock function is a supplementary safety function to prevent sudden hot water temperature rise due to operational errors.
- Depending on the environment and conditions of use, the amount of water discharged or the temperature of the hot water may change significantly when adjusting the temperature of the hot water. This is a phenomenon that occurs when the hot water temperature is not the recommended value (60°C to 80°C is recommended), when the water supply and hot water pressure is high, when there is a significant difference in water supply and hot water pressure, or when multiple devices are used simultaneously.
- Please contact our call center if you need to adjust the hot water temperature, water supply/water pressure, or temperature control lock position on the temperature control handle.

< Common to 1 tap type and Thermostatic type >

- Using other appliances that share the same water supply and hot water source at the same time may cause temperature instability. When using multiple appliances, turn the water shut-off handle (temperature control handle) slowly to adjust the temperature.

■ Use the exclusive bottle

Exclusive bottles for storing shampoo, conditioner and treatment are come with this equipment.

<Fill shampoo in the exclusive bottle>

1. Remove the pump from the exclusive bottle and fill shampoo in the bottle.
2. Attach syringe nozzle or drip nozzle on the exclusive nozzle.
3. Use the shampoo.

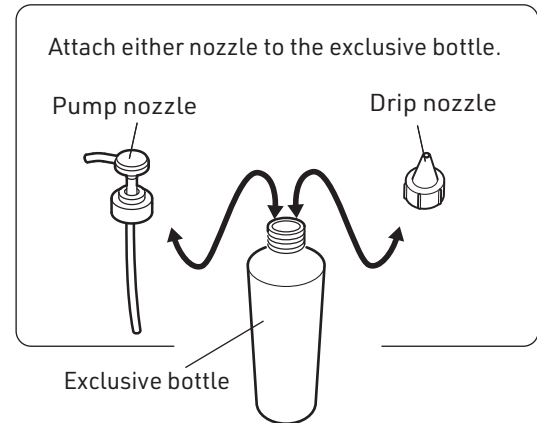

<In the case of Pump nozzle>

- Place hand under the nozzle and push pump.

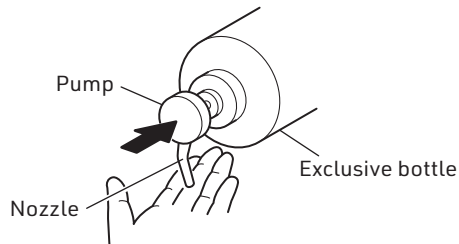

<In the case of Drip nozzle>

- Place hand under the nozzle and tilt the bottle.

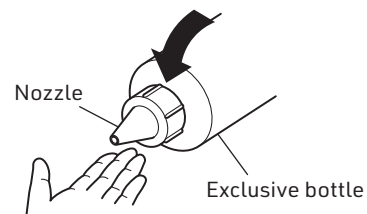

Caution

Close pump nozzle and drip nozzle firmly.
If the nozzle is not closed firmly, it may cause tilt or breakage while using.

Guiding Customers

■ When shampooing

1. Instruct the customer to sit on the seat.

2. Put a shampoo cloth on the customer.

Recommended item: Shampoo cloth without dropper

* (When using a shampoo cloth with a dropper, allow the dropper to hang in the gap between the basin and backrest.)

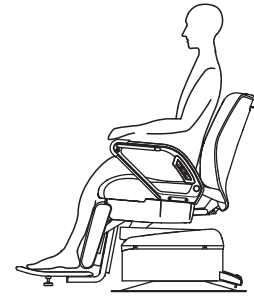

3. Open the bowl panel (Refer to page 11 "How to Use").
Hold the bowl handle and pull forward.

The following is the instruction for both, front shampoo and back shampoo.

Front wash shampoo

3-1. Instruct the customer to bend the head to basin.

If necessary, adjust the chair height accordingly.



Caution

Take care the customer's heart, knee etc. do not hit the shampoo bowl strongly.



Caution

Refer to the operating manual of the chair to check how to operate the chair.

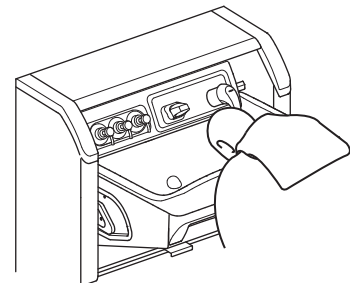

3-2. Do shampooing operation and so on.

Do shampooing etc. from the side.



Caution

Take care that customer's body does not hit the shampoo bowl strongly while operation.



■ Shampooing style

Side wash shampoo

4-1. Attach auto neck cushion (Option)

Attach neck cushion on the shampoo bowl. Refer to page 10 "Attach neck cushion".

Note

When doing back shampoo, use with neck cushion is recommended. This may reduce load to customer's neck and make shampoo operation more convenient.

4-2. Guide the customer to the full-flat position.

Turn the chair at 180 degrees and reclines the chair while holding customer's head by hand. Guide the customer to put the neck on the depressed part of the basin.

Check that the customer's face is in a horizontal position. If their face is not in a horizontal position, adjust the height of the backrest or instruct the customer to slide forward or backward and make minor adjustment.

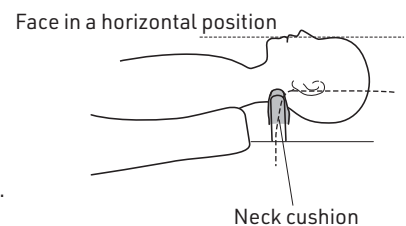

⚠ Caution

- Refer to the operating manual to learn how to operate the chair.
- Support the customer's head by hand when lowering the backrest. Failure to follow this instruction may cause the customer to hit its head on the basin.
- Do not shampooing while client's neck is higher or lower than the neck part of shampoo bowl. Failure to follow this instruction may cause injury.



4-3. Do shampooing or other service.

Do shampooing or other service from the side.

■ After shampooing

1. After shampooing, return the seat to the initial position while guiding the customer to return to the seated position.
2. Hold the bowl handle on the bowl panel, pull it upward and close the shampoo bowl.
3. Wipe moisture and cosmetics away from the outer surface, counter and door. Especially, wipe coloring agent away completely and immediately.

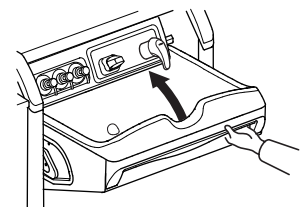

⚠ Caution

Wipe moisture and cosmetics away from all parts completely. Leaving the unit with moisture or cosmetics may cause damage to the main body, and make dirt difficult to remove.

Power outage correspondence

Take the following actions to prevent unexpected operation when the power is restored after a power outage.

- Turn off the main switch (power switch) of all equipment connected to the service outlet.
- If a power failure occurs at a high position such as the shampoo position, it will be impossible to lower the product. When a customer gets on and off the product in this condition, take extra care not to injure the customer or cause the product to fall over, for example by assisting the customer.

Maintenance

Caution

Never use volatile chemicals such as thinners, alcohol, gasoline or kerosene, cleaning products such as wax with a scourer, a sponge with a scourer, detergents that include organic solvents, acidic, alkaline or chlorine-based detergents, or scouring pads. Failure to follow this instruction may cause scratches or discoloration.

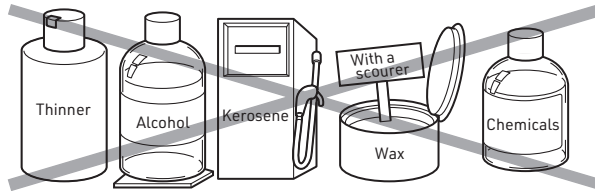

■ Bowl panel, counter, maintenance door, cabinet

Melamine board is used for the outer surface of bowl panel, counter, maintenance door and cabinet. maintain the outer surface condition, daily care is necessary.

< How to care >

- 1 Wipe with a soft, dry cloth. Especially, wipe mirror surface spec. to be wiped with very soft cloth and very softly.
- 2 If the surface is extremely dirty, wipe with a detergent solution diluted using water, followed by a damp cloth, then wipe dry.

Caution

- Do not use cleaner containing solvents or scourers.
- Take care to remove all water after wiping with a soft cloth. Any water that remains may encourage discoloration or deterioration.

■ Bowl handle, Side pillar

Bowl handle and side pillar are made of artificial marble. To maintain the polish surface, do maintenance regularly.

< Maintenance >

- 1 Wipe any dirt clean using wet soft cloth.
- 2 If they are extremely dirty, wipe with detergent diluted with water.

Caution

- Do not use brushes, scouring pads, cleaner containing solvents or scourers. The surface may degrade, leading to changes in the texture.
- Artificial marble has a character that color degradation or discoloration may be caused due to aging.

■ Hair Catcher

Hair catcher is the filter which prevents hair and dust etc. going into the drain pipe. To use equipment properly, it is necessary to clean the filter regularly.

< Maintenance >

- 1 Open the maintenance door.
- 2 Remove the cover of hair trap by rotating anti-clockwise.

⚠ Caution

When opening the cover, water may leak, so catch the water by cloth etc. If the water drops on to the equipment or outlet, it may cause damage or electric leakage.

- 3 Draw filter out and remove hairs.

⚠ Caution

Make sure the removed hairs do not go inside of drain pipe. If this caution is not followed, the drain to become blocked with hair.

- 4 Fix the cover of hair catcher after rotating it to clockwise and attach maintenance door.

⚠ Caution

- Clean the hair catcher as regularly as possible. Continuing to use the hair catcher without cleaning can cause the drain to become blocked with hair, leading to water overflowing and unhygienic conditions. Try to clean the hair catcher after each shampoo.
- The filter of hair catcher is consumable supply. Replace it if it is extremely dirty or the surface has deteriorated. Contact your local authorized Takara Belmont dealer.

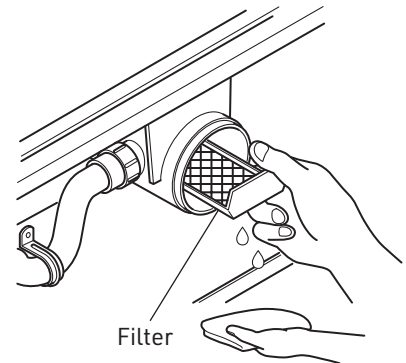
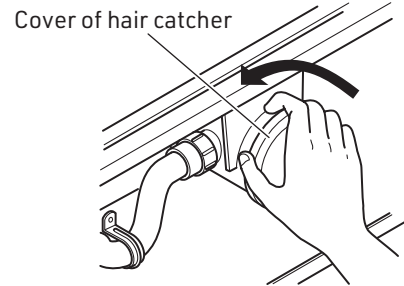

■ Drain of inner panel

There is a drain inside of inner panel to drain the water pooled in the panel. Remove the hair and dust from this drain regularly.

< Maintenance >

- 1 Open the bowl panel and confirm the position of drain of inner panel which is in the back side of water shut-off board under the bowl panel.
- 2 Clean the area around the drain of inner panel by cloth etc and remove all the hair.

⚠ Caution

Make sure that the removed hair does not go inside of drain pipe. It may cause the drain to become blocked with hair.

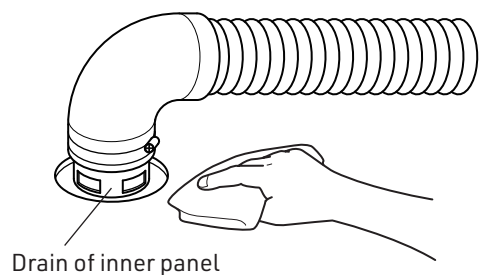
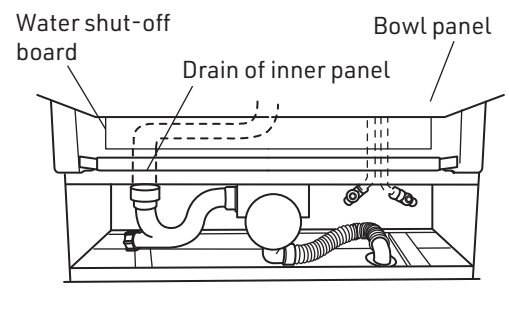

■ Shower head

During use, dirt or dust may attach inside of the shower head. Clean the shower head regularly. Clean the shower head when water does not come out properly.

< Maintenance >

1 < 1 tap type >

Loosen the fixing screw on the center part of spray board of shower head and remove 2 parts (spray plate, flat packing).
(Necessary tool: Plus driver No. 2)

< Thermostatic type >

Turn and remove the spray plate by hand and take out the gasket.

2 Wash the spray plate.

Remove dirt from holes of spray plate by using teeth brush etc.

3 Attach all parts.

(Make sure to attach flat packing.)

<1 tap type>

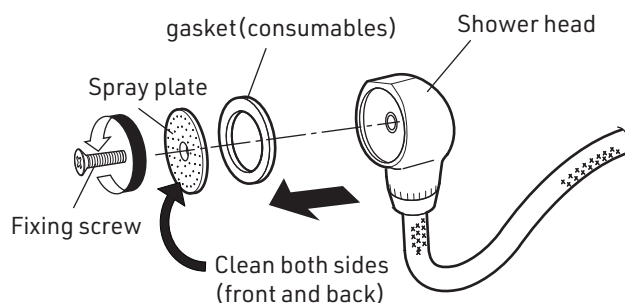

<Thermostatic type>

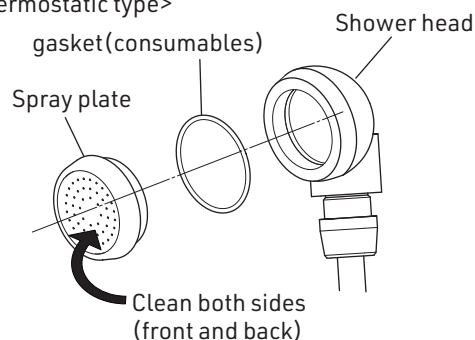

⚠ Caution

- Do not apply excessive force when attaching or removing screws of spray plate. Failure to follow this instruction may damage spray plate or shower head.
- Do not use metallic brush etc. to avoid scratches and malfunction of the parts.

■ Auto neck cushion (Option)

Neck cushion is made from special soft outer cover. Clean the neck cushion every day. Leaving dirt uncleaned may cause it to get moldy.

< Maintenance >

1

At the end of work each day, wash the neck cushion and suction caps with water, wipe them dry with a towel, and allow them to dry in the shade.

2

If they are extremely dirty, wash with detergent diluted with water, and rinse carefully with water.

The neck cushion is consumable parts. Replace it if they are extremely dirty or the surface has deteriorated.
(available at additional cost)

⚠ Caution

- If solvents drip onto the neck cushion, rinse with water as soon as possible. Failure to follow this instruction may cause deformation or discoloration.
- Clean the neck cushion every day. Leaving dirt uncleaned may cause it to get moldy.

■ Shampoo bowl, inner panel, control panel, bottle holder, draining plate

Shampoo bottle, inner panel, control panel, bottle holder, draining plate are made of plastic and leaving shampoo, treatment agent, hot water may cause dirt on those parts. Clean them regularly.

< Maintenance >

- 1 Wash them and remove any dirt.
- 2 If it is extremely dirty, wipe them away with detergent solution diluted using water.



Caution

- Do not use brushes, scouring pads, cleaner containing solvents or scourers. The surface may degrade, leading to changes in the texture.
- Do not use the equipment if it is damaged, and contact your local Takara Belmont dealer.

■ Remove water from check valve and clean the filter (only for Thermostatic type)

- To use this equipment longer, clean the filter (built-in check valve) regularly.
- Besides, when using this equipment in the cold area, remove water from check valve to avoid freeze. Contact your local authorized Takara Belmont dealer for more details.



Caution

- Make sure to remove water at the cold area. Failure to follow this instruction may cause water leak accidents.
- Make sure that water does not drip onto electrical parts when removing water and cleaning of filter. Failure to follow this instruction may cause damage, electric leak or fire.

< Maintenance >

- 1 Prepare cloth to catch the water. (more than 2 pcs. of hand towels.)
- 2 Open the maintenance door of bowl unit. Make sure that chair step does not hit to maintenance door.



Open the maintenance door and confirm there is no water leakage. If there is, piping may be broken, so do not use.

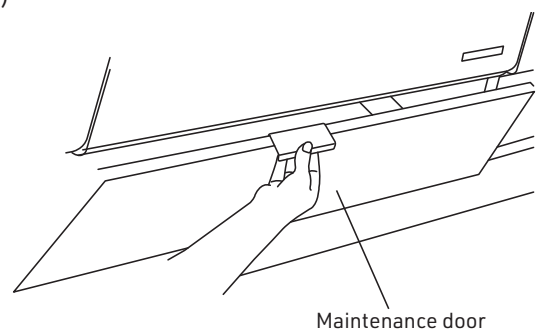

- 3 Place the towels below the hot water, cold water pipings.



Caution

- Make sure water does not drip on the electric wire etc. Failure to follow this instruction may cause electric leakage and fire.
- Piping becomes very hot. Do not touch directly.

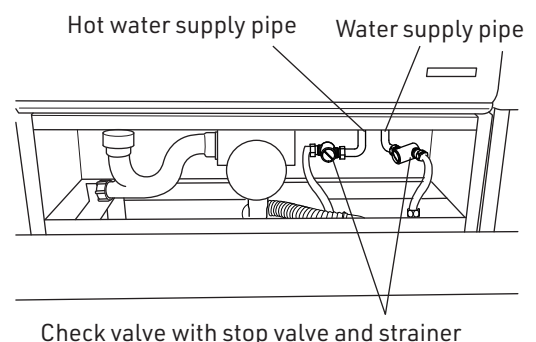

■ Remove water from check valve and clean the strainer

- 4 Close the shut-off valve of hot water and water pipings.
(Required tool : flathead screw driver)



Avoid water leakage, confirm shut-off valve is closed firmly before remove water and clean the filter.

- 5 Remove filter while attaching cloth under the check valve with strainer and remove the water.
(Required tool : flathead screw driver)



Caution

Pay attention when removing hot water, as hot water may come out when removing filter.

- 6 After cleaning the filter, return it to the initial position and tighten it firmly.

*Do this process for both, hot water and water supply pipe.

- 7 Wipe water away and remove the towels placed under the pipings.



Caution

- Make sure to tighten the filter. Failure to this instruction may cause water leakage.
- Wipe water away if it drip onto the floor.

- 8 After confirming tightening the filter, open the shut-off valve.

- 9 Close the maintenance door of bowl unit.

<Water leakage check>

At the end of work each day, open the maintenance door of bowl unit and confirm there is no water leakage on the floor.
If water leakage is confirmed, pipings etc. may be damaged, so do not use the equipment and contact your local authorized Takara Belmont dealer.

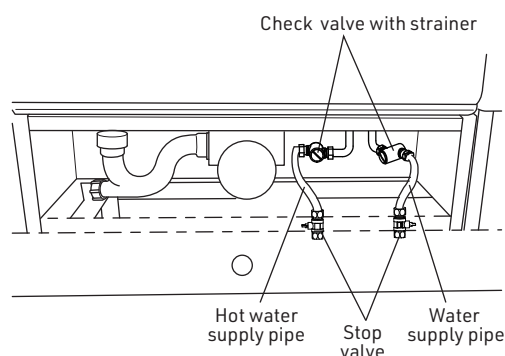

Stop valve

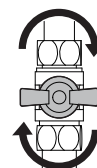

(Close)

Stop valve

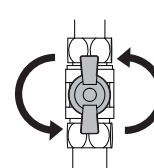

(Open)

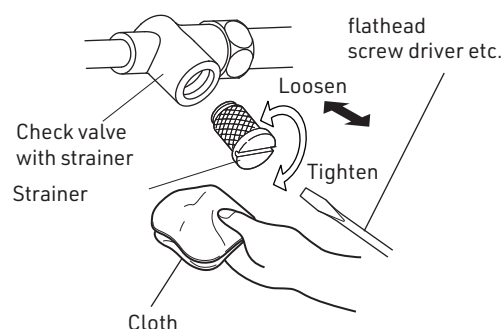

Daily Inspections

- To ensure that this product can be used for a long period of time, follow the procedures outlined in "Procedures for Daily Inspections" on page 28 to 29 of this instruction manual.



Always inspect this product following the procedures outlined in "Procedures for Daily Inspections". Continuing to use this product without performing the daily inspections may cause malfunctions or accidents.

Consumable Supplies

The following parts are “consumable supplies”.

□ Drain hose 3 years

Drain hose may have crack due to the degradation by solvents. It may cause water leakage.

If the drain hose may have damage, it may cause water soak of floor surface or under the floor.

□ Check valve 3 years

- When using check valve for long period, degradation of inner parts or some times soil water may flow back and cause water pollution or public health risk.

- If the check valve may have damage, water may flow back to water supply.

These parts to be replaced regularly to keep safety use. Make sure to replace these parts after the period above mentioned even it works properly. (available at cost).

For replacement, contact your local authorized Takara Belmont dealer.

Standard Duration of Use

The standard period of use of this product is seven years.

The standard period of use is “a guide for the standard period that this product can be used properly from a safety perspective, when conducting appropriate maintenance and inspections (including replacement of parts) for the standard usage conditions for each product.

This is not the same as the warranty period.

Before Requesting Repairs

If the following problems arise, conduct the checks outlined before requesting repairs.

Symptom	Check this	Solution
• There is no hot water.	→ Are the stop valves in the pipes open?	Open the stop valves.
• There is a sound when the hot water is turned on.	→ Does the sound change if the taps are turned to adjust the volume of water?	Adjust the volume of water. (see page 13)
• The temperature of the hot water is low.	→ Is the set temperature of the water boiler appropriate?	Adjust the set temperature of the water boiler to an appropriate temperature.
	→ < 1 tap type > Is the temperature set by 1 tap water stop handle appropriate?	Change the temperature setting by 1 tap water stop handle to an appropriate temperature. (see page 13)
	< Thermostatic type > Is the temperature set by thermostatic control handle appropriate?	Change the temperature setting by Thermostatic control handle to an appropriate temperature. (see page 13)
• The water does not drain well.	→ Is hair blocked in the hair catcher?	Remove the hair trapped in the hair catcher. (see page 16)
• Bad smell.	→ Is the hot water piled in the inner panel?	Remove the hot water/cold water or dirt from of the inner panel. (see page 16)
	→ Is there dirt stuck to shampoo o bowl, inside of bottle holder, inside of inner panel?	Wipe dirty area away.

If the product does not operate properly after checking and repairing the above points, stop using the product immediately and contact your local authorized Takara Belmont dealer.

Parts supply period

Takara Belmont has after maintenance parts for around 10 years after the day of sale of this product.

Disposing of This Product

When disposing of this product or replaced parts, adhere with current regulations and dispose of them appropriately.

Consumable Supplies

The following parts are "consumable supplies" and water, degradation, changes in external appearance and damage are expected. Please note that repair or replacement of these parts is not covered by warranty, and a fee will be required. (*The level and period of wear, degradation or damage may differ depending on the environment and conditions that the customer uses this product in) Inspections or replacement of parts will be required if there is extensive wear, degradation or damage.
Contact your local authorized Takara Belmont dealer.

Consumable supplies (the following parts are not covered by warranty, and a fee will be required.)

- ☐ Filter of hair catcher
- ☐ Rubber packings
- ☐ Shower hose
- ☐ Exclusive bottle
- ☐ Auto neck cushion (Option)
- ☐ Lubricants (oil, grease, etc.)

External scratches or dirt, degradation or fading of the following external parts are not covered by warranty.

- Bowl panel
- Bowl handle
- Shampoo bowl
- Inner panel
- Control panel
- Bowl main counter
- Maintenance door
- Side pillar
- Wooden parts
- Door and drawers
- Cabinet counter
- Platform
- Others (Handle, Shower head, Shower head bracket, Handles, drain parts, Rubbers exc.)

Specifications

Part No.	Bowl unit (1 tap type)	P1-EX***	
	Bowl unit (Thermostat type)	PT-EX** *	
	Cabinet (S size)	KF-EX*S**	
	Cabinet (Others)	KF-EX****	
	Platform	KF-EX*	
	Mirror	KF-EXM800 (Option)	
	Side Panel	KF-EXSP** (Option)	
	Auto neck cushion	KF-NC (Option)	
External dimensions	See "Dimensions" on P27, 28		
Neck height	760mm (neck part) / 780mm (when using neck cushion)		
Mixing method	1 tap lever mixing / Thermostat type		
Output method / output volume (with hot water pressure, water pressure : 0.1MPa each)	Shower head : 8L / min		
Stop valve	Single valve (with lever) / Single valve (Rotating type)		
Usage environment	Operating temperature (10 - 40°C) Operating humidity of 95% or less (ensure no condensation)		
* Hot water supply temperature	60°C or lower		
* Hot water / water supply pressure	<ul style="list-style-type: none">● 0.1 - 0.4MPa(1-4kgf/cm²)● Water pressure ≥ Hot water pressure● Difference between hot water supply pressure and water supply pressure : 0.2MPa(2kgf/cm²) or less		
Weight	Main Body	P1-EX***	42.0kg
		PT-EX***	43.0kg
	Cabinet	KF-EX2S**	14.5kg
		KF-EX2L*	18.0kg
		KF-EX2LL*	24.5kg
		KF-EX3S**	16.5kg
		KF-EX3L*	20.0kg
		KF-EX3LL*	28.0kg
		Platform	KF-EX380
	KF-EX780		3.0kg
	KF-EX1200		4.0kg
	KF-EX1300		5.0kg
	KF-EX1450		6.0kg

* See EXCELA Installation manual for details of water/hot water supply temperature and water/hot water supply pressure.

Dimensions

<Overall layout diagram>

Bowl unit : P1-EX***

Cabinet : KF-EX3S*R[3 door right side]

Cabinet : KF-EX3S*L[3 door left side]

Platform : KF-EX380, KF-EX1200

Mirror side panel : KF-EXSP*580(Optional)

Mirror : KF-EXM800(Optional)

■Top view

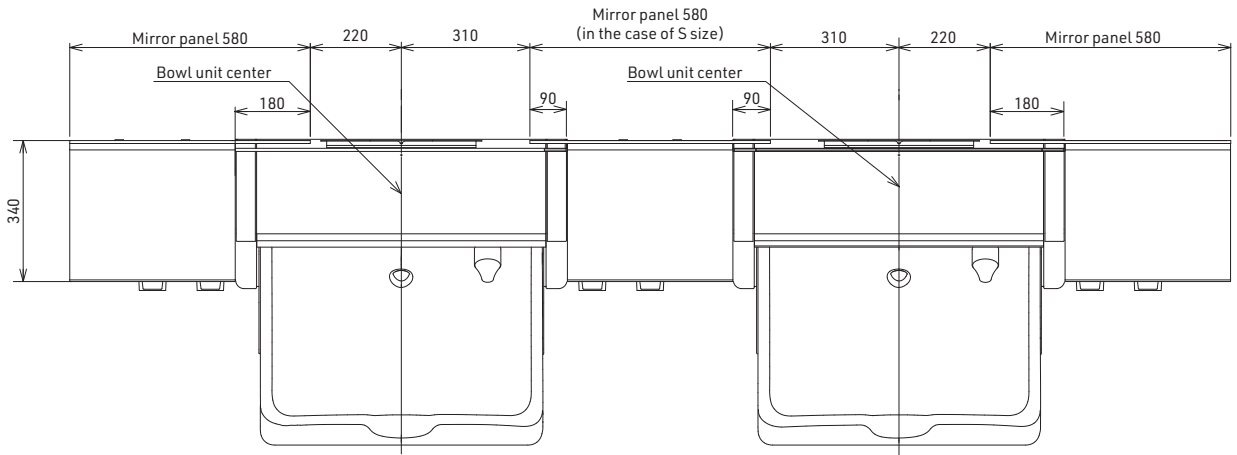

■Front view

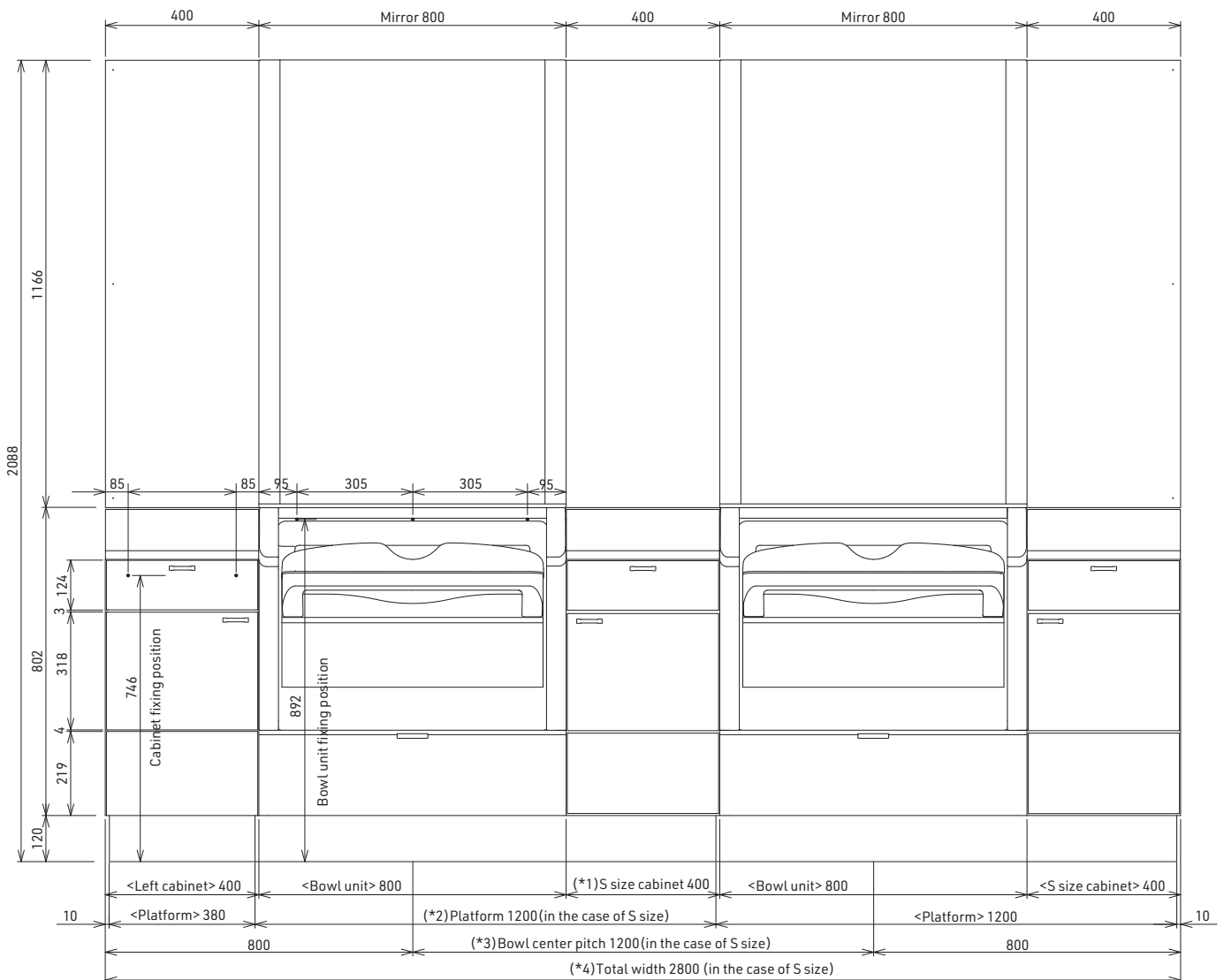

■Side view

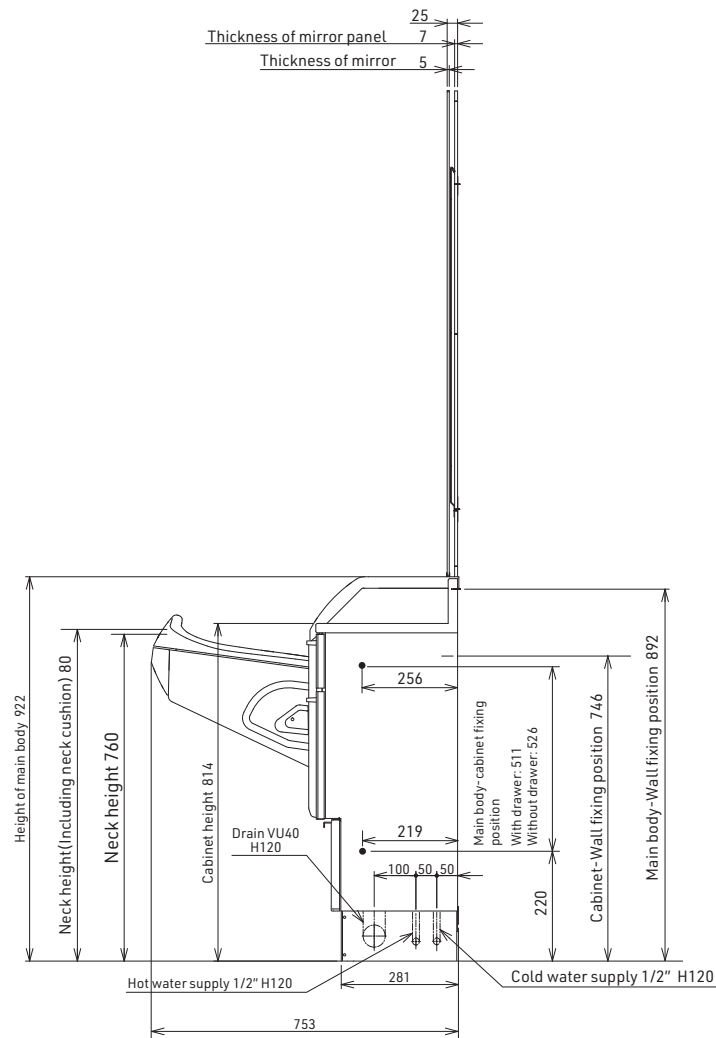

< Parts Components >

Chart		Main Body Single use	1 set	2 sets				3 sets				4 sets				5 sets			
			S	S	450	L	LL	S	450	L	LL	S	450	L	LL	S	450	L	LL
Excelsa main body		1	1	2	2	2	2	3	3	3	3	4	4	4	4	5	5	5	5
Cabinet	Left 400mm		1	1	1	1	1	1	1	1	1	1	1	1	1	1	1	1	1
	S size 400mm		1	2	1	1	1	3	1	1	1	4	1	1	1	5	1	1	1
	450 size 450mm				1				2				3				4		
	L size 500mm					1				2				3				4	
	LL size 650mm						1				2				3				4
Platform	Left 380mm		1	1	1	1	1	1	1	1	1	1	1	1	1	1	1	1	1
	S platform 1200mm		1	2	1	1	1	3	1	1	1	4	1	1	1	5	1	1	1
	450 size 1250mm				1				2				3				4		
	L platform 1300mm					1				2				3				4	
	LL platform 1450mm						1				2				3				4
	Platform single use 780mm	1																	
Total width (mm)		800	1600	2800	2850	2900	3050	4000	4100	4200	4500	5200	5350	5500	5950	6400	6600	6800	7400

- Small difference of measurement shown in the left side instruction may occur.
- PT-EX** has the same dimensions as shown in the external dimensional drawing.
- Outer measurement alters due to the selected cabinet spec. (S size, 450 size, L size, LL size).

	S size	450 size	L size	LL size
1: Cabinet	400	450	500	650
2: Platform	1200	1250	1300	1450
3: Bowl center to bowl center	1200	1250	1300	1450
4: Total width	2800	2850	2900	3050

* The total width may vary slightly from model to model.
Ensure that there is space between main unit and side wall,
specially when installing EXCELA to the wall at both ends.

Procedures for Daily Inspections

To ensure that this product can be used for a long period of time, conduct the inspections below.
If repairs necessary as a result of inspection, contact your local authorized Takara Belmont dealer.

■ Inspect the product every day

Inspection items	Inspection method	If the inspection results show defects
<input type="checkbox"/> Does bowl panel open/close smoothly?	<input type="checkbox"/> Open/close the bowl panel and check that there is no rattle or abnormal noise. <input type="checkbox"/> Check that no foreign objects are trapped in the back or sides of the bowl panel.	<input type="checkbox"/> Rattling may cause damage, deformation and malfunction. If there is no abnormal condition on b and side of bowl panel, stop using the product and contact your local authorized Takara Belmont dealer. <input type="checkbox"/> This may lead to malfunction, deformation or damage to the bowl panel or the bowl itself. Remove any foreign objects and open and close the bowl panel again to check that it opens and closes smoothly.
<input type="checkbox"/> Is the shampoo bowl rattling?	<input type="checkbox"/> Gently push or shake the front end o the shampoo bowl up, down, left and right to check that there is no rattling.	<input type="checkbox"/> The equipment may be damaged or may fall over. Stop use and contact your local authorized Takara Belmont dealer.
<input type="checkbox"/> Is the bowl body wet with water?	<input type="checkbox"/> Ensure that no parts of the shampoo bowl or main body other than the inside bowl are wet with water.	<input type="checkbox"/> This may cause the appliance to malfunction or prevent the dirt from being removed. Wipe off any water adhering to areas other than the inside of the shampoo bowl as soon as possible.
<input type="checkbox"/> Is the installation surface of the bowl body wet with water?	<input type="checkbox"/> Visually check the area around the platform board installation surface of the bowl body to ensure that it is not wet with water. <input type="checkbox"/> Remove the maintenance door on the bowl body and check that the inside of the platform is not wet with water.	<input type="checkbox"/> There may be a water leak inside the bowl body. Remove the maintenance door and check the inside (see pages 21 and 22). If water is leaking from the pipes, stop use immediately and contact your local authorized Takara Belmont dealer.
<input type="checkbox"/> Is there an abnormal smell coming from inside the bowl body?	<input type="checkbox"/> Open the bowl panel and check for unusual odors coming from the shampoo bowl drain.	<input type="checkbox"/> Dust and dirt may have accumulated in the surface or drain of inner panel of inside bowl body or draining plate. Check the condition of the filter in the hair trap and remove any debris build-up. (See page 19) <input type="checkbox"/> Dust and dirt may have accumulated in the hair trap. Remove the maintenance door, check the condition of the filter in the hair trap and remove any debris build-up. (See page 19)
<input type="checkbox"/> Does the tap work properly?	<input type="checkbox"/> Raise or lower the tap ('turn' for thermo-type) and check that the hot water comes out normally, that there is no unusual noise and that the hot water is stopped reliably. *An unusual noise "running water noise" may occur due to running water. (See pages 10 and 11) <input type="checkbox"/> Turn on the tap and check whether the temperature is controlled properly and whether there is an unusual noise. *You may hear a noise while the water is running. (See page 13.)	<input type="checkbox"/> If there is and unusual noise or the hot water does not stop even when the tap is turned fully down (or "fully turned" in the case of the thermostat type), there may be a fault with the mixer unit itself. Contact your local authorized Takara Belmont dealer. <input type="checkbox"/> In such a case where the temperature is not controlled properly or there is an unusual noise, the thermal parts may be defective. Immediately stop using the product and contact your local Takara Belmont dealer for assistance.

Inspection Items	Inspection Method	If the inspection results show defects
<input type="checkbox"/> Is the hot and cold water coming out of the shower head correctly? <input type="checkbox"/> Neck cushion (sold separately) has not deteriorated?	<input type="checkbox"/> Turn on the hot water and check visually whether the shower head is discharging water normally, whether water is leaking from the outlet or the base of the shower head, and whether the hot water is not cloudy. <input type="checkbox"/> Check the surface of the neck cushion for tears, stains or dents.	<input type="checkbox"/> If the hot water does not come out normally or is cloudy, the strainer of the check valve may be dirty, clean the strainer. (See pages 21 and 22) <input type="checkbox"/> If a few shower lines stick out, it is likely that the shower head plate is clogged with water dust or lime scales. Remove the shower head plate and clean it. (See page 20) <input type="checkbox"/> If water is leaking from the base of the water outlet or shower head, the internal gasket may be worn out. Contact your local authorized Takara Belmont dealer for replacement. <input type="checkbox"/> The neck cushion may cause pain or stains to your neck or head. The neck cushion is a consumable item. Replace it as soon as possible.

■ Must be inspected at the end of each working day

Inspection Items	Inspection Method	If the inspection results show defects
<input type="checkbox"/> Is the drain blocked? <input type="checkbox"/> Is the tap firmly closed? <input type="checkbox"/> No water leakage inside the bowl body.	<input type="checkbox"/> Make sure the drain is not blocked by towels or shampoo cloths. <input type="checkbox"/> Check that the tap is securely closed by lowering the tap all the way down. (Turned fully to the right for thermostatic type) <input type="checkbox"/> Open the bowl panel and maintenance door and check for water on the inner panel inside the bowl body and inside the maintenance door. (See pages 21 and 22)	<input type="checkbox"/> Remove any objects blocking the drain. If the drain is blocked, water may overflow from the shampoo bowl and cause a leakage accident if water is accidentally discharged or a small amount of water is discharged due to increased water pressure rate at night. <input type="checkbox"/> Make sure that the water is turned off by lowering the tap firmly all the way down. (Turned fully to the right for thermo type) If the water cannot be shut off completely, there may be a fault with the mixing unit. Turn off the water and hot water supply pipes (See pages 21 and 22), contact your local authorized Takara Belmont dealer. <input type="checkbox"/> Wipe off the moisture. If left unattended, it will be a distant cause of corrosion and strange odor.

■ To be inspected once a week

Inspection Items	Inspection Method	If the inspection results show defects
<input type="checkbox"/> No water leakage inside the bowl body. <input type="checkbox"/> Are there any leaks from the drainage hose? <input type="checkbox"/> Is the shower head plate free of water stains and dirt?	<input type="checkbox"/> Open the maintenance door of the bowl body and check for water leakage from the internal pipework or the faucet body (see pages 21 and 22). <input type="checkbox"/> Open the maintenance door of the bowl body and check for water leakage from the drainage hose (see pages 21 and 22). <input type="checkbox"/> Remove the shower head plate and check for water spots and other dirt (see page 20).	<input type="checkbox"/> If water is leaking from the pipes, the pipes or gaskets may be worn, deteriorated or damaged. Discontinue use immediately, turn off the water supply and hot water pipes (see pages 21 and 22) contact your local authorized Takara Belmont dealer. <input type="checkbox"/> If water is leaking from the drainage hose, the drainage hose may be damaged. Discontinue use immediately and contact your local Takara Belmont dealer. <input type="checkbox"/> Clean by removing water stains and other contaminants using a toothbrush or similar tool. If left unattended, this may cause clogging and the shower may not discharge water correctly.

MEMO

MEMO



TAKARA BELMONT CORPORATION

1-1, 2-Chome, Higashi-shinsaibashi, Chuo-ku, Osaka, Japan

TEL : +81-6-6213-5945

FAX : +81-6-6212-3680

Printed in Japan

1E0AQ5A0 (Request No.)