

ODIN Backwash UNIT

Operating Manual

■ ODIN Backwash UNIT



Table of Contents

Description of Warning Symbols	2
Safety Precautions	2
Precautions for Use	5
Precautions for Handling Synthetic Leather	7
Precautions for Basin	7
Before Using This Product	7
Precautions on Resin (Plated) Parts	8
Name of Parts	8
Accessories	9
How to Use	9
Maintenance	1 2
Daily Inspections	1 5
Parts Replaced on a Regular Basis	1 5
Standard Duration of Use	1 5
Before Requesting Repairs	1 6
Consumable Supplies	1 6
Disposing of This Product	1 7
After-sales Service	1 7
Specifications	1 7
Product Dimensions	1 8
Procedures for Daily Inspections	1 9

Thank you for purchasing this Takara Belmont product.
The instructions contained in this booklet should be thoroughly read and understood before use.
Using this product before reading this operating manual may result in an accident.
This product is an industrial shampoo unit designed for barber shops and hair salons.
Only use this product for its intended purpose and do not use it for non-hairdressing work.
Keep this manual and refer back to them when required.

Description of Warning Symbols

■ Before using this product

The "Safety Precautions", "Precautions for Use" and "Precautions for Handling Synthetic Leather" contained in this booklet should be thoroughly read and understood before use.

■ Precautions listed here

The precautions listed here are to ensure that this product can be used safely, and to prevent any danger or risk to the person using this product or those around them.

These precautions are important for ensuring safety. Adhere to these precautions at all times. Takara Belmont is not responsible for any danger or risk to the person using this product or those around them due to accidents if this product is used without adhering to the "Safety Precautions", "Precautions for Use" and "Precautions for Handling Synthetic Leather". In this case, the person failing to adhere to the "Safety Precautions", "Precautions for Use" and "Precautions for Handling Synthetic Leather" will be responsible for any danger or risk incurred. Detailed descriptions of symbols are provided below. Read and understand these symbols thoroughly before reading this manual.

■ Symbols



Warning

If this symbol is ignored and the product is used, "there is the risk of death or serious injury to the user".



Caution

If this symbol is ignored and the product is used, "there is the risk of light or moderate injury or physical damage".

Note

Description of "ideal points to adhere to for safety".



Common danger, warning and caution notifications



Guidance or instruction regarding common user actions



Common prohibited actions



CAUTION
Hot water

Notification of high temperature warning



Disassembly
Prohibited

Prohibited disassembly or repairs/modifications

Safety Precautions (Adhere to these precautions at all times)



Warning



Do not climb on parts such as the basin, armrest or backrest.

Do not climb on, pull or apply excessive force to parts such as the basin, armrest, backrest or footrest. Failure to follow this instruction may damage the product or cause it to fall over.

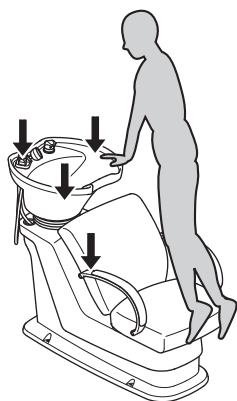

Do not insert fingers into movable parts.

Do not insert fingers into movable parts. Failure to follow this instruction may cause injury.



! Warning



Install on a stable area.

Install the main body on a flat, firm floor, and fix it securely. Failure to follow this instruction may cause the main body to fall over.

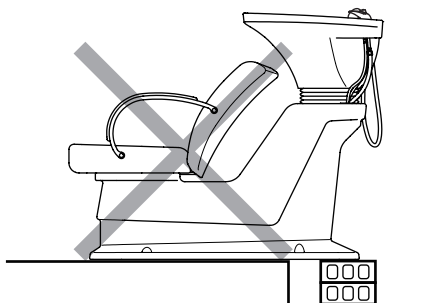

Adjust the water temperature while checking the temperature by hand.

When adjusting the temperature of the water, reduce the volume of water, point the shower head away from the customer and check the temperature by hand. Take care when doing so, as hot water may come out of the shower head.



Return the faucet to an appropriate position after using hot water.

- Return the faucet to an appropriate position after using hot water. Continuing to use the hot water with the knob in the hot position may cause burns.
- Using other equipment that share the same water/hot water supply source at the same time may cause unstable water temperature. If multiple equipment is to be used, move the faucet slowly to adjust the water temperature.



Disassembly
Prohibited

Disassembly and repairs/modifications are prohibited.

Disassembly, repairs and modifications must not be conducted by people other than qualified repair technicians. Failure to follow this instruction may cause abnormal operation, leading to injury.



Do not use hot water (boiling water) of 60°C or higher.

Using hot water that is 60°C or higher may deform or damage the parts such as the basin, shower head, and faucet.



Do not lean in a basin.

Leaning on a basin when shampooing, there is a possibility that the product to tip over, causing injury.



Caution



Do not spray areas other than the basin with water.

- Take care not to spray areas other than the basin with water. If water does come in contact with areas other than the basin, wipe them dry as soon as possible. Water entering the main body may cause malfunctions.
- Take care not to allow water to drip on the floor. If water does drip on the floor, wipe it dry as soon as possible. Failure to follow this instruction may damage the floor, or cause water leakage.



Only use this product for its intended purpose and do not use it for non-hairdressing work.

This product is an industrial product designed for barber shops and hair salons. Only use this product for its intended purpose and do not use it for non-hairdressing work.



Do not use outdoors.

This product is designed for indoor use. Do not install this product outdoors or within a vehicle. Be sure to only use this product inside a barber or hair salon. Failure to follow this instruction may cause malfunctions or damage to the main body.



Do not use this product if the coating is peeling.

Replace the water taps (faucet, vacuum breaker) if the coating is peeling. Continuing to use this product when the coating is peeling may cause injury.



Do not use the product in a place where freezing is expected.

Failure to take this precaution may result in breakage of parts, thus resulting in water leaks. If freezing is expected, maintain the room temperature at 0°C or above by using a heater.



Do not turn the water fully on with the shower head in the shower head bracket.

Failure to follow this instruction may cause water to spill out of the basin, covering the customer with water.



Do not hit the unit with objects.

Do not hit the unit with hard objects. Failure to follow this instruction may cause deformation or damage to the unit.



Do not subject the unit to shocks.

Do not subject the unit to shocks. Failure to follow this instruction may cause damage, leading to injury.



CAUTION
Hot water

Do not touch the hot water supply pipe or mixing pipe.

The hot water supply pipe or mixing pipe may become very hot. Do not touch the pipes directly.



Do not drink the hot water.

This product is designed for washing hair. Do not drink the hot water. The water quality may cause diarrhea or stomach pain.



Pay attention when cleaning the basin.

Failure to take this precaution may result in injuries by the sink outlet fixture in the basin.

Precautions for Use



Caution



Close the water stop knob firmly.

After use or shampooing is complete, turn the water off completely.
Failure to turn the water off completely may cause water leakage.



Do not use strongly acidic or strongly alkaline cleaning solvents.

Do not use cleaning solvents containing mainly caustic soda (NaOH) or caustic potash (KOH) to clean the drain pipe. Never pour thinners, alcohol, nail polish remover, gasoline or kerosene into the drain. Failure to follow this instruction may cause damage to the drain hose.



Always wipe the floor clean if it is wet.

Wipe the floor as soon as possible if it is wet after shampooing. Failure to follow this instruction may damage the floor or cause degradation and malfunctions of parts in contact with the floor or the reclining pedal. Wet floor may cause falling or water leakage to downstairs leading to an accident.



Do not pull to force the shower hose.

Do not pull to force the shower hose. There is possibility that the failure of the hose, the water discharge failure occurs.



Do not move the basin swiftly.

Move the basin gently, paying attention to avoid hitting people or objects.



Do not cover the drain outlet when this product is not going to be used.

Do not cover the drain outlet with towel, or shampoo cape after finishing the work. Water may overflow the basin when water is improperly discharged or a small amount of hot water is discharged due to an increase in water pressure during the night, resulting in water leaks.

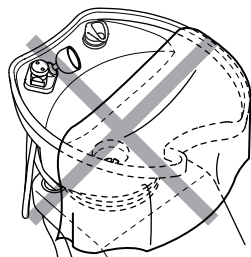

Do not wipe with chemicals or apply heat.

Failure to follow this instruction may cause deformation or discoloration. If chemicals spill on to the leather or covers, wipe them dry as soon as possible.

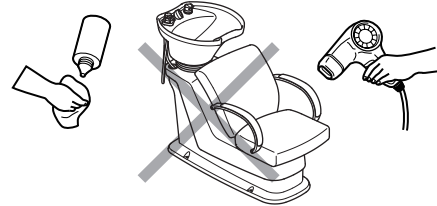

Avoid direct sunlight or heat from a heater.

Avoid direct sunlight or heat from a heater. Failure to follow this instruction may cause discoloration or degradation of the leather.

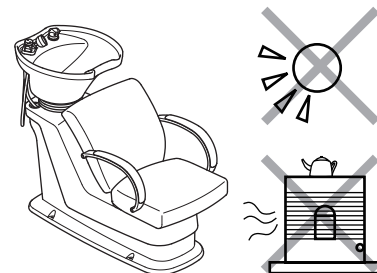

Do not use an abrasive compound.

Do not use an abrasive compound to clean the water taps (faucet, vacuum breaker). Use of an abrasive compound, sponge with abrasive compound, or hard cleaning tools, such as wire wool or a nylon scrubbing brush, may damage the fixture surface.



Do not practice front shampooing and side shampooing.

This product is intended for back shampooing. Practicing the front shampooing may cause water leaks, thus wetting the floor.





Caution



Do not wet the shower head bracket with water.

Do not wet the shower head bracket with water. Failure to follow this instruction may cause water leaks.

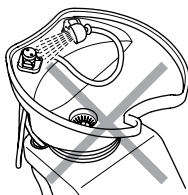

If chemicals spill on to this product, wipe them dry as soon as possible.

If chemicals such as hair dyes spill on to this product, wipe them dry as soon as possible. Failure to follow this instruction may cause discoloration, deterioration or deformation. Also, if chemicals spill on to the floor, wipe them dry as soon as possible.



Do not hit the main frame with object, kick the cover.

Failure to follow this instruction may cause malfunctions or accidents, leading to damage to the main body.

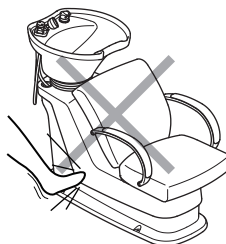

Do not drop heavy objects on to the basin.

Do not place or drop heavy objects on to the basin. Failure to follow this instruction may cause damage such as scratches or cracks to the basin.



Do not strike the resin (plated) parts with a hard object.

Do not strike the resin (plated) parts, such as the water stop knob and temperature control knob (upper part), with a hard object. Failure to take this precaution may cause flaws or cracks on the plated surface and peeling of plating, thereby resulting in injuries.



Pay attention to maintenance methods.

Be sure to execute daily maintenance according to the section "Maintenance" on page 12. In the case of insufficient or improper maintenance or when parts needing periodic replacement are not replaced, the customer shall be responsible for any harm, damage, or defects that result; Takara Belmont shall not assume responsibility.



After use, wipe water away from all parts other than the basin.

Leaving the main body with water on it may cause damage, and make dirt difficult to remove.



Do not use peppermint oil or aroma oil.

Do not use peppermint oil or aroma oil containing menthol. Failure to take this precaution may damage the resin parts.



Set the hot water supply temperature for this product to 80°C or less.

Failure to follow this instruction may cause malfunctions or damage in parts such as the faucet, vacuum breaker, flexible pipe and thermostat water valve.



In cold regions, ensure that water is removed

In cold regions, always drain the water as a measure to prevent freezing. Failure to follow this instruction may cause water leakage. (According to the instructions of stop valve used, please drain the water.)



Do not fill the basin with water.

Do not fill the basin with water. Failure to take this precaution may cause the water to spill out of the basin and splash onto the customer.



Clean the hair catcher regularly.

Clean the hair catcher as regularly as possible. Continuing to use the hair catcher without cleaning it may cause the drain to become blocked with hair, leading to water overflowing and unhygienic conditions. Try to clean the hair catcher after each shampooing.

Precautions for Handling Synthetic Leather



Handling precautions

- **Stains caused by clothing dyes**

The synthetic leather of this product may become stained by direct contact with clothes or belts. If there are stains, wipe clean as quickly as possible with a 10% detergent solution diluted using water to prevent permanent staining.

- **Take care of deformation or stains due to direct contact**

- Direct contact with other objects such as plastic products, painted items, solvents or adhesive tape may cause changes in the surface luster, cracking, deformation or peeling.
- Direct contact with newspaper or printed paper may cause stains.
- Direct contact with items of clothing such as printed images of t-shirts, or jeans may cause discoloration of the synthetic leather of this product.
- Direct contact with solvents such as benzene, nail polish remover, alcohol, oil (including beauty treatment oils) may cause discoloration, melting of the surface, elution of the plasticizing agent, changes to surface luster, hardening/softening or peeling.
- Using bleach or bleached sheets may cause changes in the surface luster or discoloration.
- Installing this product next to sources of excess heat such as irons or heaters may cause deformation or discoloration.
- Protect this product from direct sunlight by installing curtains. Failure to follow this instruction may cause changes, shrinking, discoloration or fading of the leather surface.
- Placing heavy objects for a long period of time may leave an imprint or wrinkles on the synthetic leather that cannot be removed.

Precaution for Basin

This product employs a ceramic basin. Since bending or deformation cannot be avoided when forming the basin, the position, height, or shape of the neck differs slightly from product to product.

Before Using This Product

- This product is designed for performing back shampooing^{*1} or hair/scalp care.
- Please note that the gap between the backrest and the basin may vary slightly from product to product.

^{*1} Back shampooing: the user stands behind the basin and performs shampooing from the back (back position).

Precautions on Resin (Plated) Parts

- Resin plating is adopted for part of the faucet and the vacuum breaker.
 - Plating is a thin, hard metal film applied to the surface that may crack or peel due to corrosion or aged deterioration.
 - Flaws or cracks may occur on the plated surface due to impacts from falling objects.
 - Flaws or cracks may occur on the plated surface when a hard object hits the surface.
 - Peeling of the plating may occur from flaws or cracks on the plated surface.

Caution

Check that there are no flaws, cracks, or peeling of the plated surface of the water taps (faucet, vacuum braker) before using the product. If peeling is observed, immediately stop using the product and contact your closest dealer.

Name of Parts

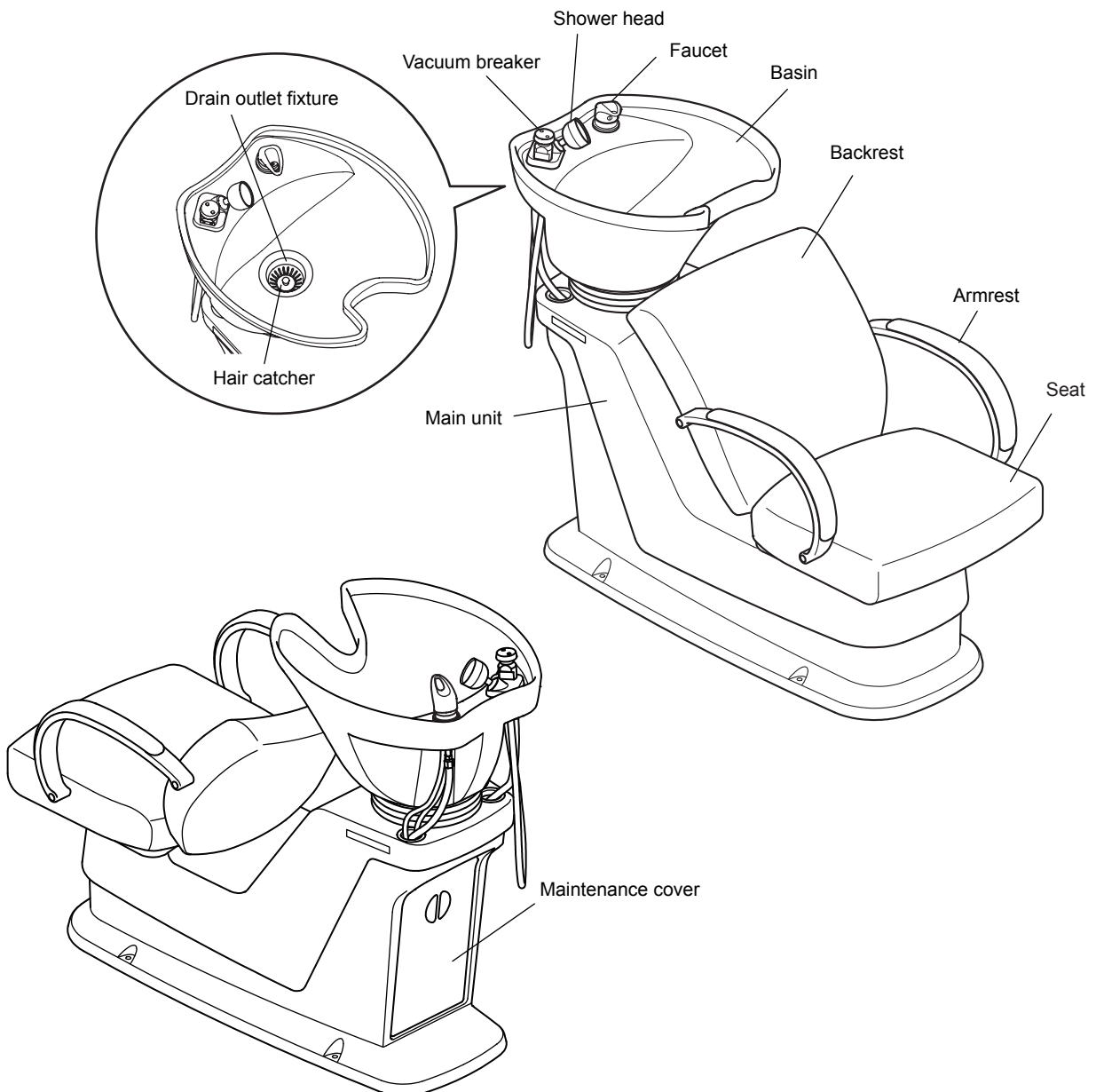

Accessories

- ☐ Installation instructions... 1
- ☐ Operating Manual... 1

How to use

- 1 Allow the customer to sit in the chair and then place a shampoo cape on the shoulders.



Caution

When seated, inform the customer not to place any weight on the backrest in advance. Failure to take this precaution may result in the customer's body hitting the basin.

- 2 Move the basin position according to the neck position of the customer.



Caution

To move the basin, be sure to hold it at the leading and the trailing end of the basin as illustrated. Failure to take this precaution may result in operational failure.



Caution

Operating angle of the basin has been decided. If move it forcibly, it may cause malfunctions or damage.

Leading End

Trailing End

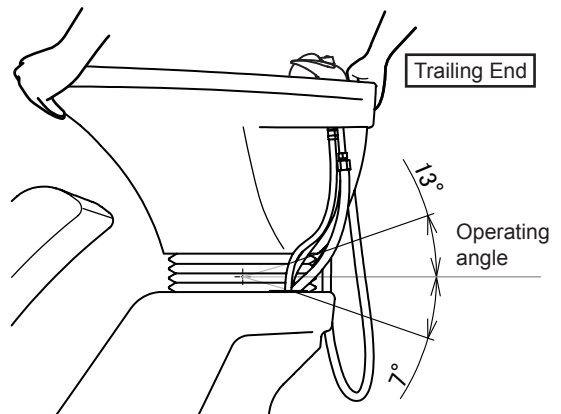

Adjust the basin so that the customer's neck comes to the neck position of the basin.

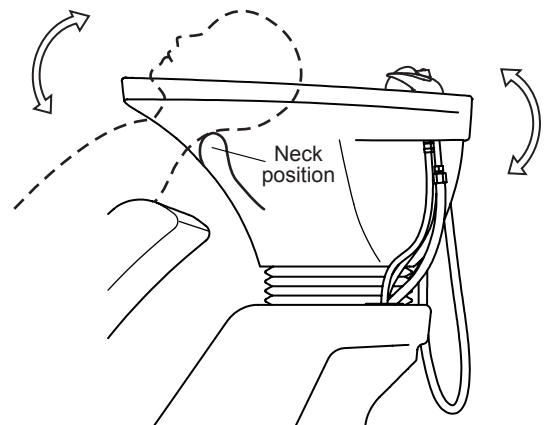

- 3 Allow the customer to grip the armrest of the chair and lean back against the backrest.



Caution

When reclining the backrest, ensure you hold the customer's head with your hand. Failure to do so may result in the customer's head hitting the basin.

4 Shampoo the hair.

Caution

- There is no function to secure the basin.
Therefore, when the customer applies a load with the head exceeding a specific level, the basin may move. Encourage the customer to pay attention.
- The hairdresser must not lean on the basin. The basin may move, which is dangerous.

5 Raise the customer's body while supporting the customer's head with the hand.

6 Remove the shampoo cape and allow the customer to move.

7 After using the product, wipe off any moisture.

- Moisture from the shower hose that dripped onto the floor.
- Moisture adhered to the main unit and outside the basin.

Caution

- After use, be sure to wipe off any moisture from all parts other than the inside of the basin. Leaving the product with water drops may result in failure or any contamination will not be removed.
- When the floor is wet, be sure to wipe the moisture off. Wet floors increase the possibility of slipping and falling or water leaks to the downstairs, thus resulting in accidents.



■ Adjusting the volume of water, and adjusting the water temperature

- 1 Raise the lever and adjust the volume of water according to an angle of the lever.

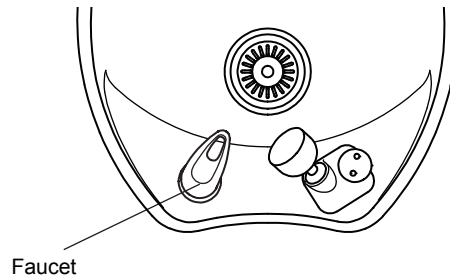
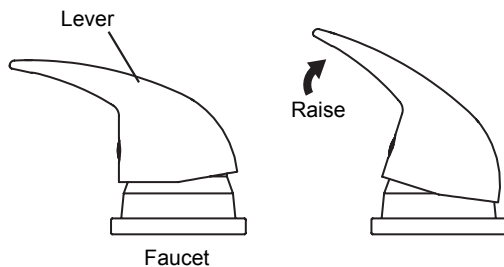

Note

A gushing sound may be emitted from the main body depending on the environment or conditions that it is used in. This sound is due to water flowing fast through pipes as a result of high water pressure or water volume control, and is not indicative of a defective product. This gushing sound can be reduced by adjusting the water pressure.

⚠ Caution

- When the basin is not being used, make sure to turn the water off properly. Failure to do this may cause water leakage.
- When the basin is not being used, do not cover the drain with towel or shampoo cloth as water may come out. Water may be accidentally trickled due to an increase in water pressure at night. This may cause water to spill from the basin, leading to water leakage.

Turn the lever in the H or C direction to set the temperature to an appropriate level.

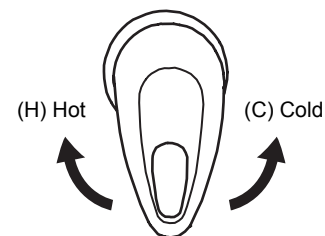

⚠ Caution

- Return the lever to an appropriate position after use.
- Using other equipment that share the same water / hot water supply source at the same time may cause unstable water temperature.

Note

The water flow may change significantly when controlling the hot water temperature depending on the operating environment or conditions. This phenomena occurs when the hot water temperature exceeds the recommended values (60°C to 80°C), there is significant difference in the water supply or hot-water supply pressure, or multiple devices are used at the same time-it is not equipment failure.

Maintenance

Caution

Never use volatile chemicals such as thinners, alcohol, gasoline or kerosene, cleaning products such as abrasive wax, a sponge with a scourer, detergents that include organic solvents, acidic, alkaline or chlorine-based detergents, or scouring pads. Failure to follow this instruction may cause scratches or discoloration.

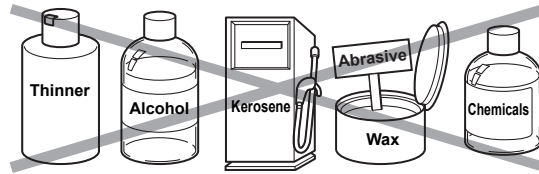

Caution

Be sure to execute daily maintenance according to the maintenance procedures stated in this section. In the case of insufficient or improper maintenance or when periodically replaced parts are not replaced, the customer shall be responsible for any harm, damage, or defects that result, and Takara Belmont shall not assume responsibility.

■ Hair catcher

Pull out the hair catcher and remove any hair that has been caught.
The hair catcher is a consumable supply.
Replace it if it is extremely dirty or the surface has deteriorated.
(available at an additional cost)

Caution

Clean the hair catcher as regularly as possible. Continuing to use the hair catcher without cleaning can cause the drain to become blocked with hair, leading to water overflowing and unhygienic conditions. Try to clean the hair catcher after each shampoo.

Caution

Please only then put the drain outlet hair catcher. There is a possibility that the drainage capacity falls, water overflows from the basin.

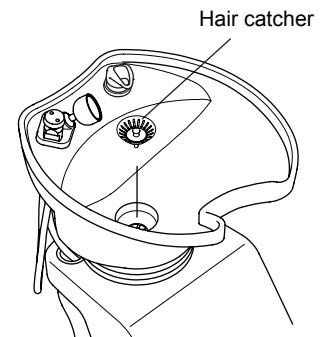

■ Basin

Wipe any dirt clean using detergent diluted with water. If streaked scratches appear due to contact with metallic objects such as watch bands, rub the area with a nylon scourer.

Caution

Do not use a metallic scourer or sandpaper, as they will damage the basin.

■ Synthetic leather parts

Clean the leather every day after work. Leaving dirt uncleaned may cause mold to grow.

- Wipe with a soft, dry cloth or a damp cloth. If the leather is extremely dirty, wipe with a 10% detergent solution diluted using water, followed by a damp cloth, then wipe dry.
- If leather is stained by clothes or belts, it should be wiped clean as quickly as possible with a 10% detergent solution diluted using water to avoid further staining by the plasticizing agent.
- Take care to remove all moisture after wiping with a damp cloth. Any moisture that remains may encourage hydrolysis.
- Do not use leather cleaner containing solvents or scourers, and bleach. The surface may degrade, leading to changes in the texture and luster. If leather cleaners are to be used, first check that there is no discoloration by testing in an area that is not visible.



Caution

- **Do not use the following items.**

Volatile chemicals such as thinners, alcohol, benzene, nail polish remover, gasoline or kerosene, wax with a scourer, or a sponge with a scourer.

- **Do not use brushes or scouring pads.**

Do not use brushes or scouring pads when cleaning the leather.

Failure to follow this instruction may cause scratches, and dirt may not be able to be removed.

■ Main unit

Wipe with a soft, dry cloth or a damp cloth. If the leather is extremely dirty, wipe with a 10% detergent solution diluted using water, followed by a damp cloth, then wipe dry.



Caution

- **Do not use the following items.**

Volatile chemicals such as thinners, alcohol, benzene, nail polish remover, gasoline or kerosene, wax with a scourer, or a sponge with a scourer.

- **Do not use brushes or scouring pads.**

Do not use brushes or scouring pads when cleaning the leather.

Failure to follow this instruction may cause scratches, and dirt may not be able to be removed.

■ Cleaning the shower head

1. Rotate and detach the sprinkling filter unit.
2. Clean the sprinkling filter unit and packing with water.
 - Remove dirt, such as water deposits in the shower holes on the sprinkling filter unit, with a toothbrush.
3. Reassemble the shower head.

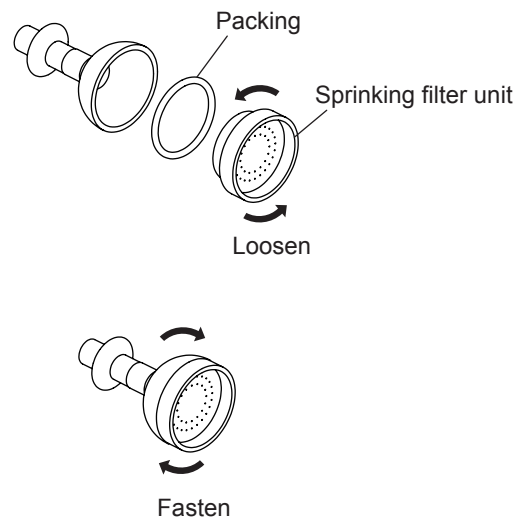

■ Maintenance of the inside of the main unit <water draining and cleaning procedures>

To use the basin for a long period of time, clean the pipes regularly.



Caution

In cold regions, always drain the water as a measure to prevent freezing.
Failure to follow this instruction may cause water leakage.
(According to the instructions of stop valve used, please drain the water.)

Before and after using the product, check that water does not trickle out beneath the main unit.
Check that water does not leak from the water supply pipe, hot-water supply pipe, and the joints of the drainage pipe. Be sure to inspect for water leaks and clean on a regular basis.
(We recommend checking for water leaks at least once a month by opening the maintenance cover.)

● Remove the maintenance cover

To remove the maintenance cover, remove the urea resin head screws that secure the maintenance cover.
It can be possible to remove the maintenance cover, and checked in the main unit.



Warning

- The hot water supply pipe may become very hot. Take care not to touch the pipe directly.
- Be careful at the edge of the main unit and the maintenance cover.



After removing the maintenance cover, check that there is no water leakage within the basin. If there is water leakage, the pipes within the basin may be damaged.
If this is the case, contact your closest dealer.
Leaving water leaks may sometimes result in serious accidents or water damage. In this case, the customer will be responsible for the accident and a significant amount of labor and costs will be incurred.

● Attach the maintenance cover

Attach the maintenance cover with the main unit by using urea resin head screws and washers. (Two locations)



Caution

Hook the lower side of the maintenance cover on the main unit.
Otherwise, the maintenance cover may drop.

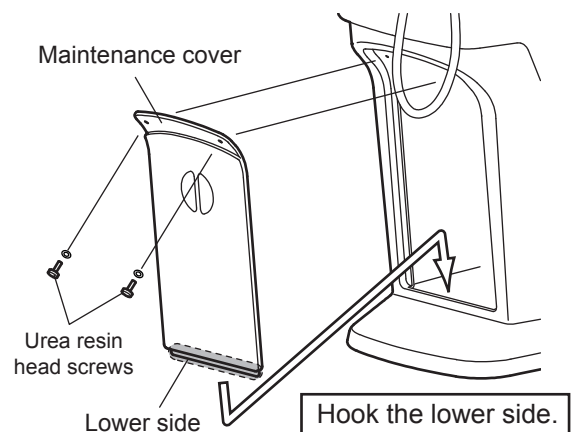
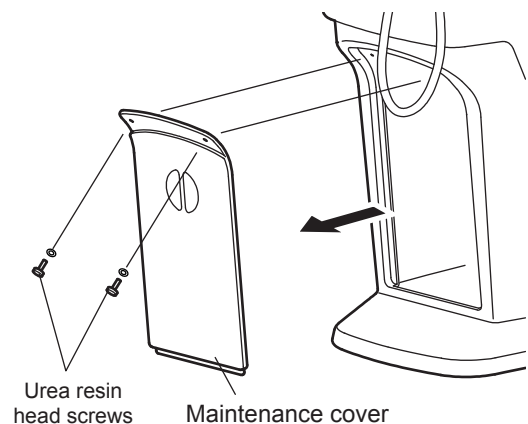

Note

According to the instructions of trap used, please care.

Note

The "Parts Replaced on a Regular Basis" described on page 15 must be replaced on a regular basis to ensure and maintain safety and performance. Any part that is outside the designated replacement period must be replaced even if there is no problem during use. Takara Belmont will not assume responsibility for any harm, damage, or defects attributed to the fact that a part was not replaced within the designated period.

Daily Inspections

- To ensure that this product can be used for a long period of time, follow the procedures outlined in "Procedures for Daily Inspections" on page 19 of this instruction manual.



Always inspect this product following the procedures outlined in "Procedures for Daily Inspections". Continuing to use this product without performing the daily inspections may cause malfunctions or accidents.

Parts Replaced on a Regular Basis

The following are parts that must be replaced on a regular basis as designated by Takara Belmont:

- ☐ Connecting hose (G1/4 L800) : Replace every three years
 - For the connecting hose, there is a possibility that cracks due to deterioration caused by equipment operation or residual chlorine or copper ions in the city water may cause water leaks.
 - Damage to the hose may result in water flooding on or beneath the floor.

The above-listed parts must be replaced on a regular basis to ensure and maintain safety and performance. Any part that is outside the designated replacement period must be replaced even if there is no problem during use. (The parts are available at an additional cost.) Takara Belmont will not assume responsibility for any harm, damage, or defects attributed to any part that was not replaced within the designated period. For ordering replacement work, contact your closest dealer.

Standard Duration of Use

The standard period of use of this product is seven years.

The standard period of use is a guide for the standard period that this product can be used properly from a safety perspective, when conducting appropriate maintenance and inspections (including replacement of parts) for the standard usage conditions for each product. This is not the warranty period.

Before Requesting Repairs

If the following problems arise, conduct the checks outlined before requesting repairs.

Symptoms	Points to be checked	Solutions
● Water does not come out.	⇒ Is the water stop valve of the pipe open?	Open the water stop valve. (According to the instructions of stop valve used, please open.)
● The temperature of the hot water is low.	⇒ Is the set temperature of the water heater appropriate?	Adjust the set temperature of the water heater to an appropriate temperature.
	⇒ Is the temperature set with the faucet appropriate?	Adjust the set temperature to an appropriate level using the faucet. (see page 11)
● The water does not drain well.	⇒ Is hair blocked in the hair catcher?	Remove the hair trapped in the hair catcher. (see page 12)
● There is a sound when the hot water is turned on.	⇒ Does the sound change if the lever of the faucet is pressed down to adjust the volume of water?	Adjust the volume of water so that not too much water come out. (see page 11)

If the product does not operate properly after checking and repairing the above points, stop using the product immediately.

Consumable Supplies

The following parts are "consumable supplies" and wear, degradation, changes in external appearance and damage are expected.

Please note that repair or replacement of these parts is not covered by warranty, and a fee will be required.

(* The level and period of wear, degradation or damage may differ depending on the environment and conditions that the customer uses this product in.)

Inspections or replacement of parts will be required if there is extensive wear, degradation or damage.

Consumable Parts

(The following parts are not covered by the warranty; the cost of replacement is your responsibility.)

☐ Shower hose

Furthermore, flaws, contamination, deterioration, and discoloration of the exterior parts below are not to be covered by the warranty.

☐ External parts

- Main unit, chilt unit, and basin
- Upholstered parts (backrest, seat, etc.)
- Knobs (faucet, etc.)
- Other parts (shower head, vacuum breaker, armrest, etc.)

Disposing of This Product

When disposing of this product or replaced parts, adhere to the effective regulations and dispose of them appropriately.

After-sales Service

To request after-sales service, contact your closest dealer.

Specifications

Product	Basin	AY-ODNBSN
	Main unit	AY-ODNBDY
	Chair	AY-ODNST
Outside Dimensions	See the "Product Dimensions" on page 18.	
Basin tilting angle	-13°~7°	
Mixing type	Dial-Flo Faucet (Model 550)	
Water discharging system/ Discharging amount (hot-water pressure/water pressure: 0.1 MPa, respectively)	Shower mode: 7.0 L/min	
Operating environment	Operating temperature: 10~40°C Operating humidity: 95% or below (No condensing)	
※Hot-water supply temperature	80°C or below	
※ Hot-water/water supply pressure	•0.1~0.4MPa(1 to 4 kgf/cm ²) •Water supply pressure \geq Hot-water supply pressure •Difference between hot-water supply pressure and water supply pressure: Within 0.2 MPa (2kgf/cm ²)	
Weight	Main body (Basin+Main unit)	29.0kg
	Chair	11.0kg
Weight limit	135kg or below	

※For details of the hot-water supply temperature, hot-water/water supply pressures, see the Odin Backwash Unit Installation Instructions.

Product Demensions

(Unit : inch)

■ Top View

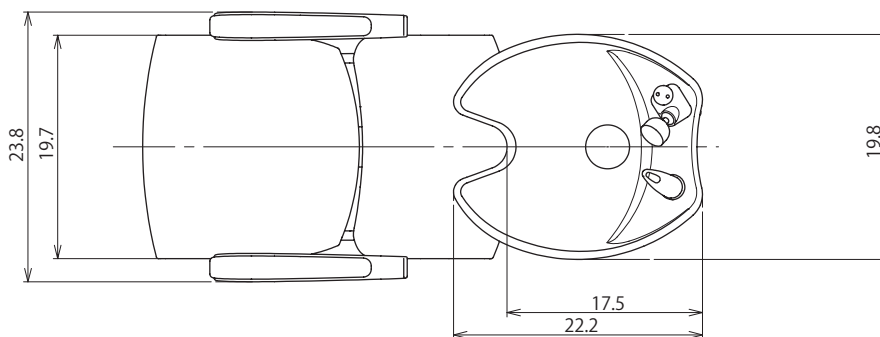

■ Side View

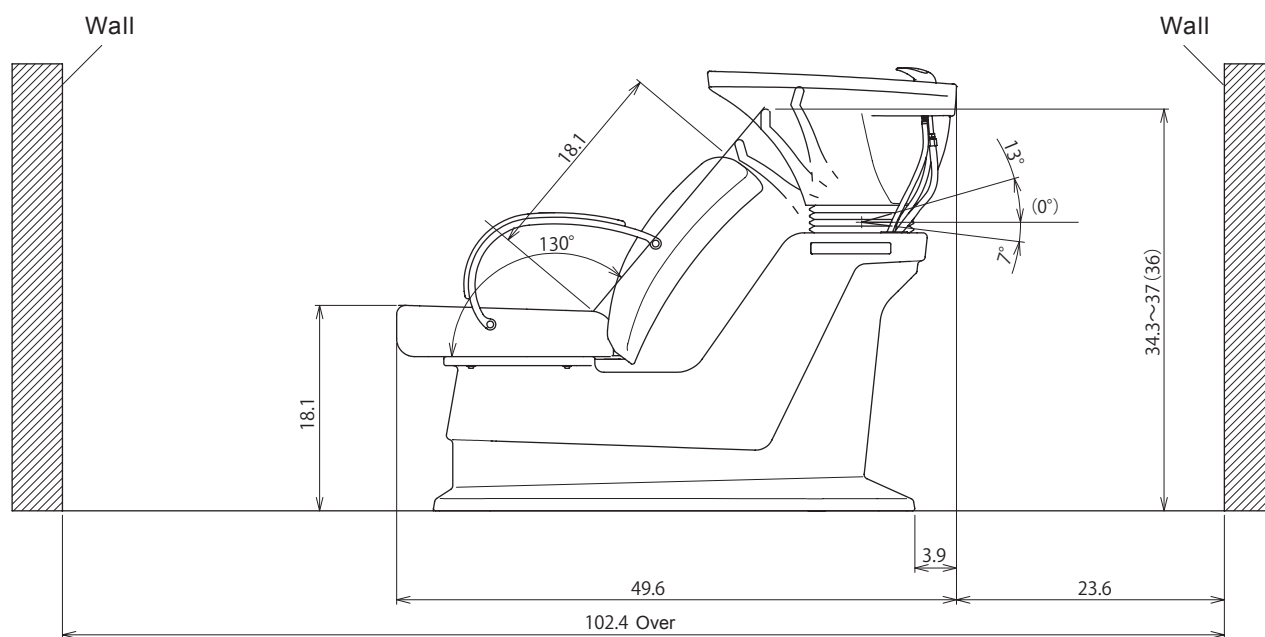

Procedures for Daily Inspections

To ensure that this product can be used for a long period of time, conduct the inspections below.

■ Inspect the product every day

Inspection item	Inspection method	If the inspection results show defects
<input type="checkbox"/> Is the plating of the water taps (faucet and the vacuum breaker) peeled off?	<input type="checkbox"/> Visually check the water taps (faucet and the vacuum breaker) for flaws, cracks, or peeling of the plated surface. <input type="checkbox"/> During operation or maintenance, check that there are no burrs or irregularities on the surface.	<input type="checkbox"/> Flaws, cracks, or peeling of the plated surface may result in injury of hand. If they exist, replacement of the knob is required. Contact your closest dealer.
<input type="checkbox"/> Is the mounting surface of the product wet with water?	<input type="checkbox"/> Open the maintenance cover and check that the mounting surface and pipes are not wet with water.	<input type="checkbox"/> There is a possibility that water is leaking from the pipes. If this is the case, immediately stop using the product and contact your closest dealer.
<input type="checkbox"/> Is there an abnormal odor coming from the basin drain?	<input type="checkbox"/> Check if there is an abnormal odor coming from the basin drain.	<input type="checkbox"/> Remove any hair and other objects trapped in the hair catcher. (see page 12)
<input type="checkbox"/> Does the faucet work properly?	<input type="checkbox"/> Tilt the front of the faucet and check if warm water is output properly and that there is no abnormal noise, then returning the faucet to the original position and check that warm water stops properly. <input type="checkbox"/> Turn the faucet, check that the water temperature is adjusted properly and that there is no abnormal noise.	<input type="checkbox"/> If there is abnormal noise or the water does not turn off properly when the water stop knob is closed firmly, there may be a malfunction in the stop valves of the water stop knob. <input type="checkbox"/> If the water temperature cannot be adjusted properly or if there is abnormal noise, there is a possibility that the faucet has a failure. Close the stop valves in the water supply pipe and hot water supply pipe, stop using the product, and contact your closest dealer.
<input type="checkbox"/> Does the basin, backrest or seat rattle?	<input type="checkbox"/> Slowly push the rear end of the basin, top of the backrest or the front end of the seat in each direction, and check whether they rattle.	<input type="checkbox"/> Rattling may cause incorrect operation or damage in the main body, or cause it to fall over. Stop using the product.

■ Always inspect the product after work every day

Inspection item	Inspection method	If the inspection results show defects
<input type="checkbox"/> Has the faucet been turned off firmly?	<input type="checkbox"/> Visually check faucet and the vacuum breaker for flaws, cracks, or peeling of the plated surface.	<input type="checkbox"/> If the water does not turn off completely, there is a possibility that the faucet has a failure. Close the stop valves in the water supply pipe and hot water supply pipe, stop using the product, and contact your closest dealer.

■ Inspect the product once per week

Inspection item	Inspection method	If the inspection results show defects
<input type="checkbox"/> Is there any water leaking within the product?	<input type="checkbox"/> Remove the basin maintenance cover and check that there is no water leaking from the internal pipes or water taps (see page 14).	<input type="checkbox"/> If water is leaking from the pipes, the pipes or packing may be worn, degraded or damaged. Close the stop valves in the water supply pipe and hot water supply pipe, and stop using the product immediately.



TAKARA BELMONT CORPORATION

1-1, 2-Chome, Higashi-shinsaibashi, Chuo-ku, Osaka, Japan

TEL : (06) 6213-5945

FAX : (06) 6212-3680

Printed in Japan

1E03AQA0